

Blow Gun Series VMG

Effective sectional area

30mm²

Pressure loss is less than 1%.
(nozzle size: $\phi 2.5$)

Special valve design and construction saves energy
Reduced pressure drop due to smooth flow of fluid

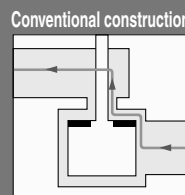
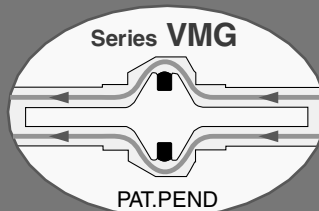

<Dark blue>
Bottom piping



<Urban white>
Top piping

- K
- M
- H
- D
- MS
- T
- VMG

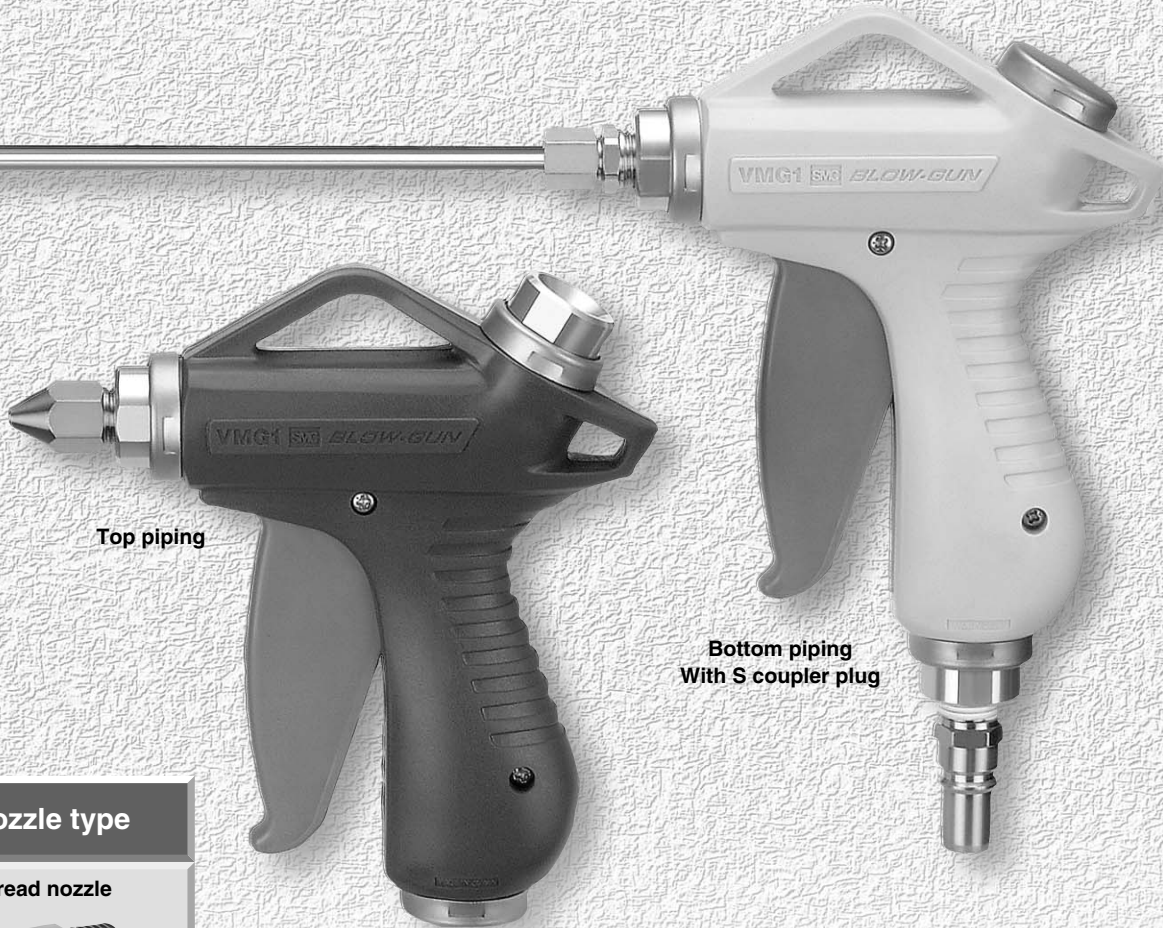

Top piping

Bottom piping
With S coupler plug

Nozzle type

Male thread nozzle



Low noise nozzle



High efficiency nozzle



Long copper pipe nozzle



Piping direction

Bottom

Top

Piping type

Rc, NPT, G
1/4, 3/8

With S coupler
(quick connect) plug

Body color

Urban white

Dark blue

Provides constant operational force
irrespective of the supply pressure

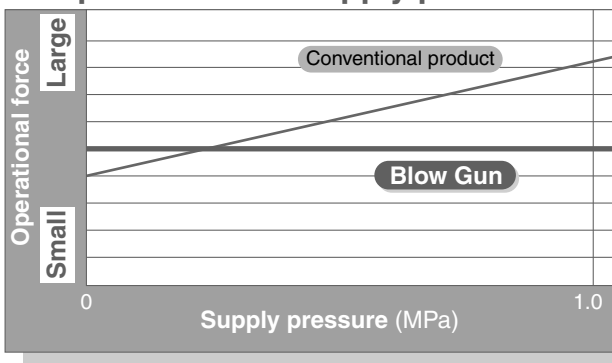

Pressure loss

*Male thread nozzle ø2.5

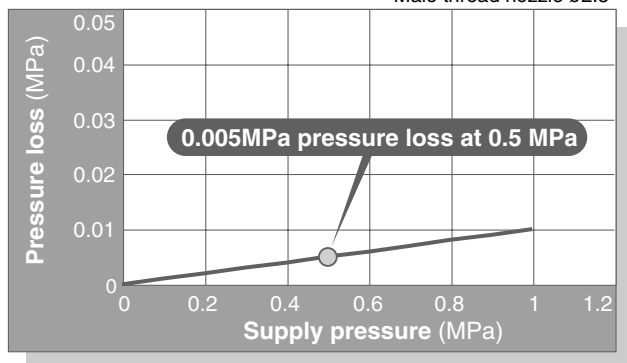

Example of Improvement

Before Improvement

In the case of air guns, energy saving measures are not considered.

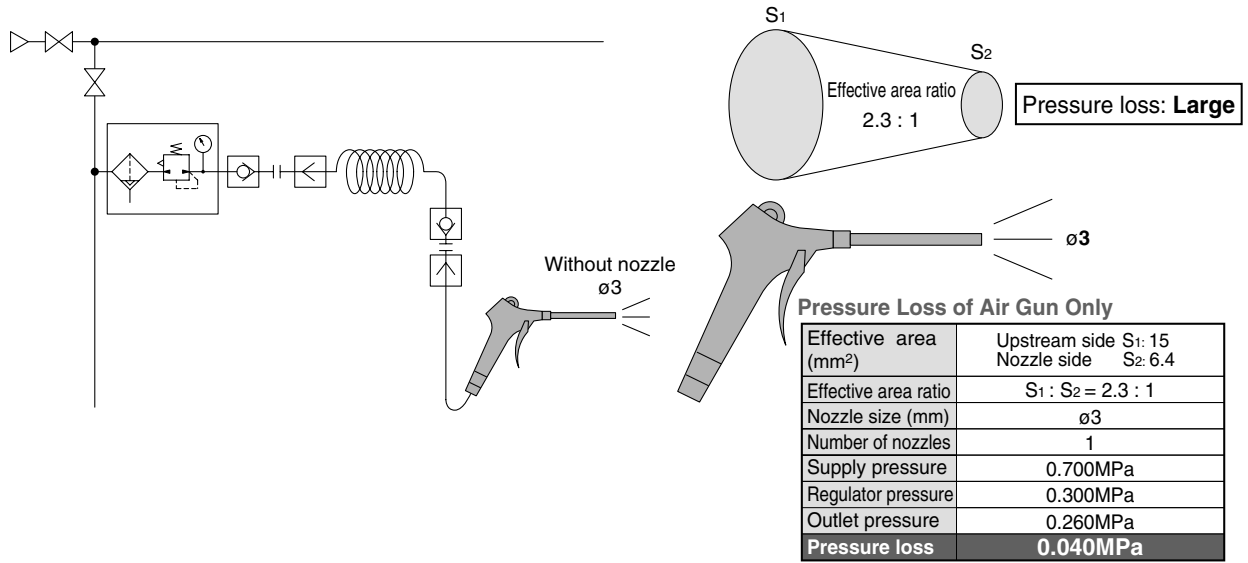

- K
- M
- H
- D
- MS
- T
- VMG

After Improvement

Change to fittings, tubing and Blow Gun with large effective areas.

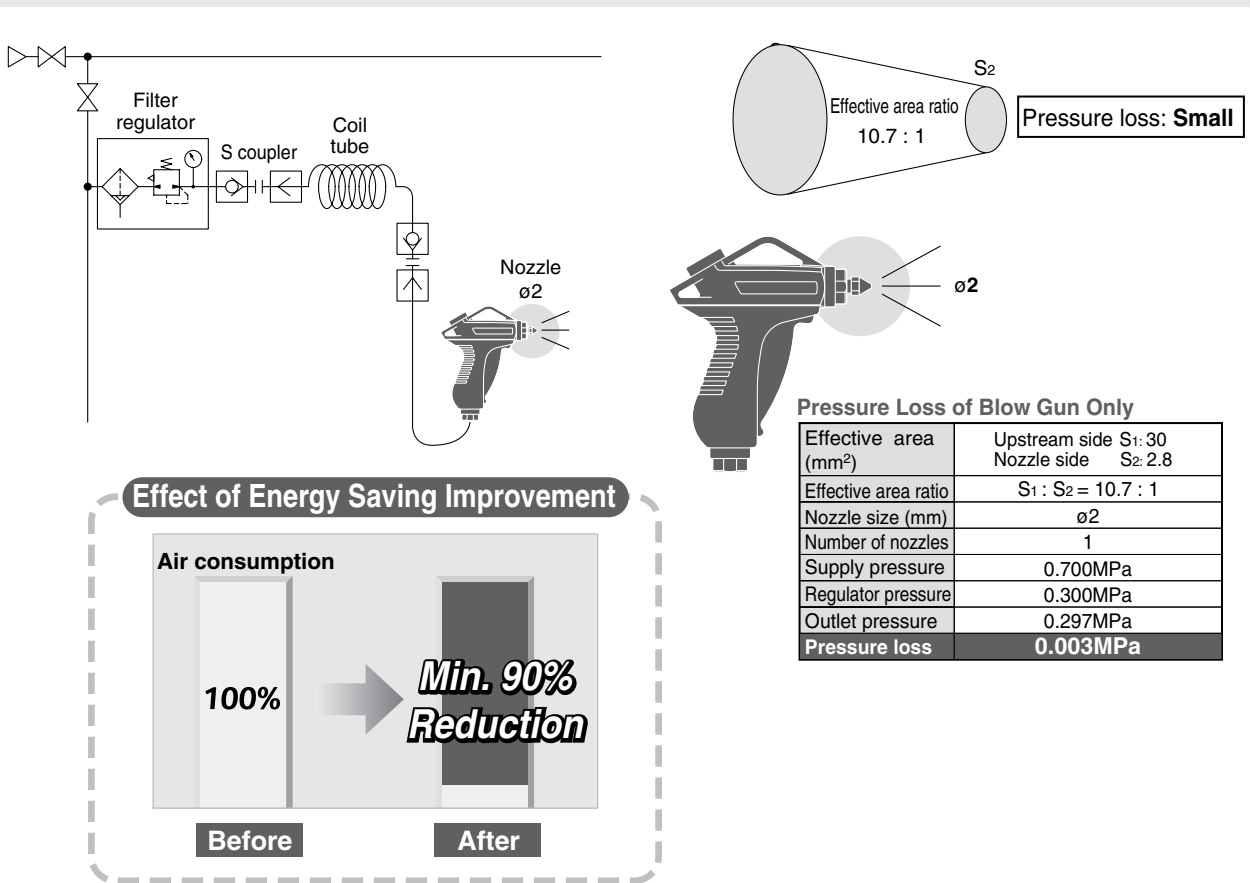

Related Products:

- Nozzle: Series KN.....P.15-7-7 S coupler: Series KKA.....P.15-7-8
 S coupler: Series KK.....P.15-7-8 Regulator: Series AR.....P.15-7-9
 S coupler: Series KKH.....P.15-7-8 Filter regulator: Series AW.....P.15-7-10

Blow Gun

Series VMG

How to Order



VMG 1 1 W — **03** — **01**

Blow gun

Standard type

Series

1 Resin body lever type

Piping entry

1	Bottom
2	Top

Body color

W	Urban white
BU	Dark blue

Piping connection type

Nil	Rc
N	NPT
F	G

Nozzle

	Type	Nozzle model	Nozzle size	
Nil		Without nozzle		
01	Male thread nozzle	KN-R02-100	ø1	
02		KN-R02-150	ø1.5	
03		KN-R02-200	ø2	
04		KN-R02-250	ø2.5	
11	High efficiency nozzle	KNH-R02-100	ø1	
12		KNH-R02-150	ø1.5	
13		KNH-R02-200	ø2	
21	Low noise nozzle with male thread	KNS-R02-075-4	ø0.75 x 4	
22		KNS-R02-090-8	ø0.9 x 8	
23		KNS-R02-100-4	ø1 x 4	
24		KNS-R02-110-8	ø1.1 x 8	
31	Copper extension nozzle	Length 300mm	KNL3-06-150	ø1.5
32			KNL3-06-200	ø2
33		Length 600mm	KNL6-06-150	ø1.5
34			KNL6-06-200	ø2

Note 1) One piece of H06-02 self-align fitting is attached.

When a copper extension nozzle is ordered separately, a self-align fitting will also be required for connection. Order one with the above part number in addition to the nozzle.

Connection size

	Piping connection system	Size and part no.	
02	Screw-in type	Port size	1/4
03			3/8
11	With S coupler plug ^{Note1)}	Plug part no.	KK4P-02MS

Note 1) In case of a type with an S coupler plug, specify no symbol (Rc) for the piping connection type. The size is Rc 1/4.

Specifications

Fluid	Air	
Operating pressure range	0 to 1.0MPa	
Proof pressure	1.5MPa	
Ambient and fluid temperature	-5 to 60°C (With no condensation)	
Effective area	30mm ² (without nozzle)	
Port size	Rc, NPT, G, 1/4, 3/8	
Piping entry	Bottom	Top
Nozzle port size	Rc 1/4	
Weight	180g	
Operational force (when the valve is fully open)	7N	

Construction

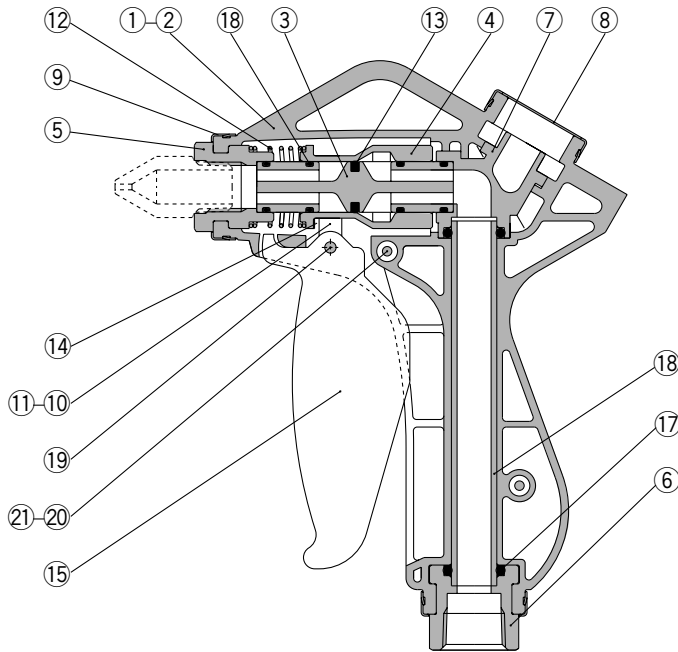

Component Parts

No.	Description	Material	Note
①	Body L	PBT	
②	Body R	PBT	
③	Main valve	PBT	
④	Valve guide	Aluminium alloy	Chromate
⑤	Nozzle holder	Aluminium alloy	Anodized
⑥	Port	Aluminium alloy	Anodized
⑦	Elbow	PBT	
⑧	Cover	Stainless steel	
⑨	Ring	Stainless steel	
⑩	Arm L	Stainless steel	
⑪	Arm R	Stainless steel	
⑫	Spring	Stainless steel	
⑬	Main valve seal	HNBR	
⑭	Guide cover	Stainless steel	
⑮	Lever	PBT	
⑯	Tube	PBT	*Only for VMG11
⑰	O-ring	NBR	
⑱	O-ring	NBR	
⑲	Parallel pin	Stainless steel	
⑳	Round head Phillips screw	Stainless steel	
㉑	Hexagon nut	Stainless steel	

- K
- M
- H
- D
- MS
- T
- VMG**

Flow Characteristics

Note) Values when the main valve is fully open.

Male thread nozzle

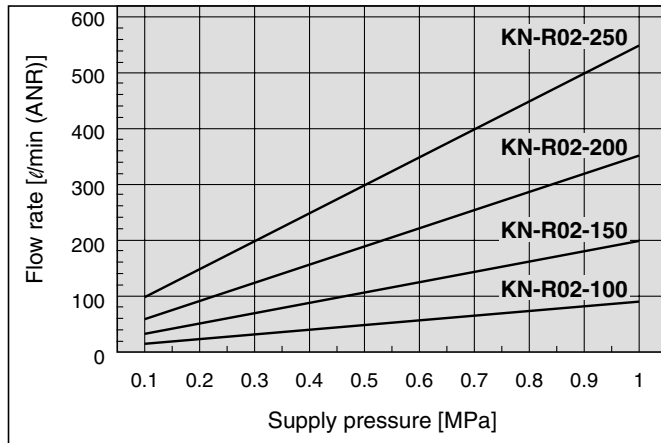

High efficiency nozzle

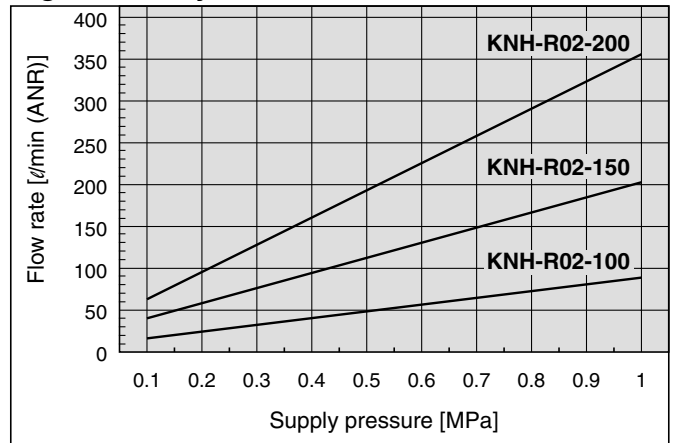

Low noise nozzle with male thread

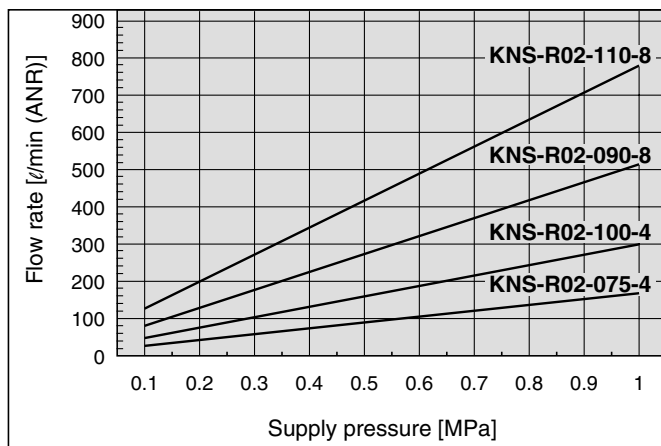

Copper extension nozzle

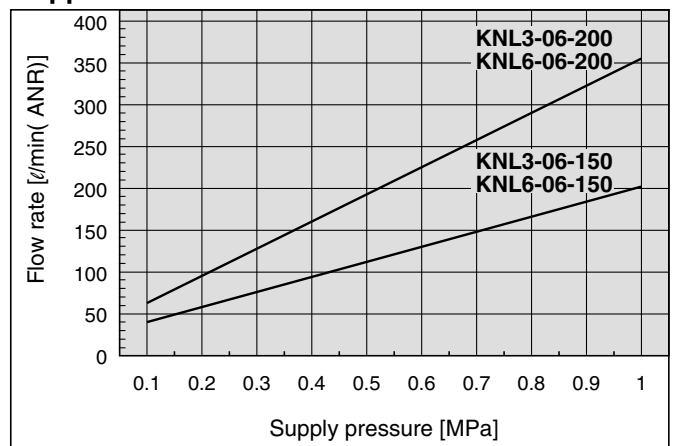

Series VMG

Dimensions

VMG11/Piping entry: Bottom

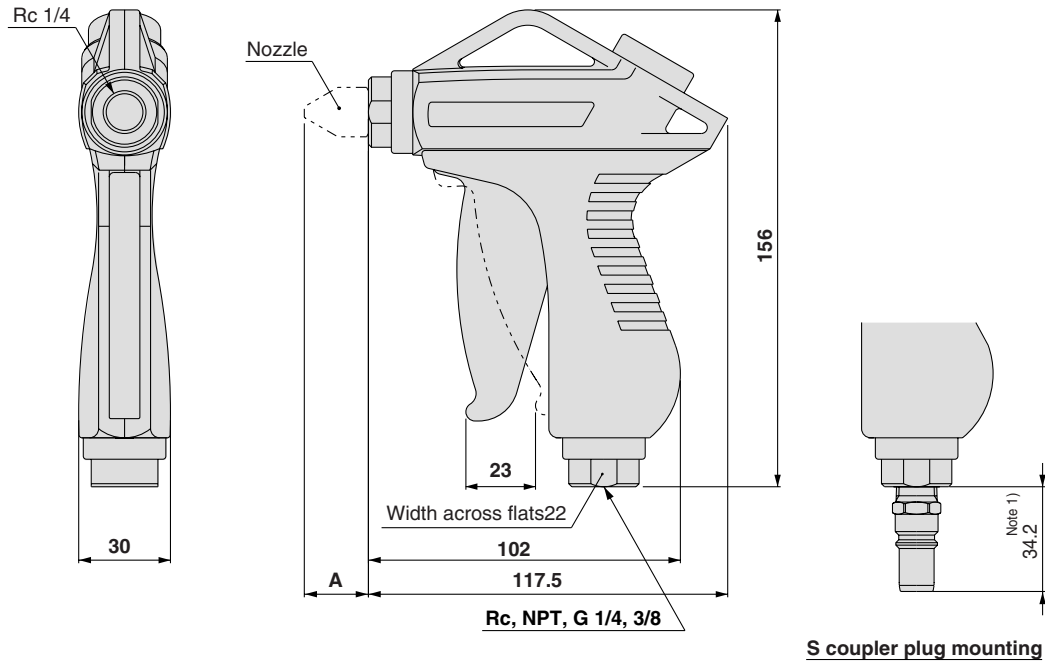

VMG12/Piping entry: Top

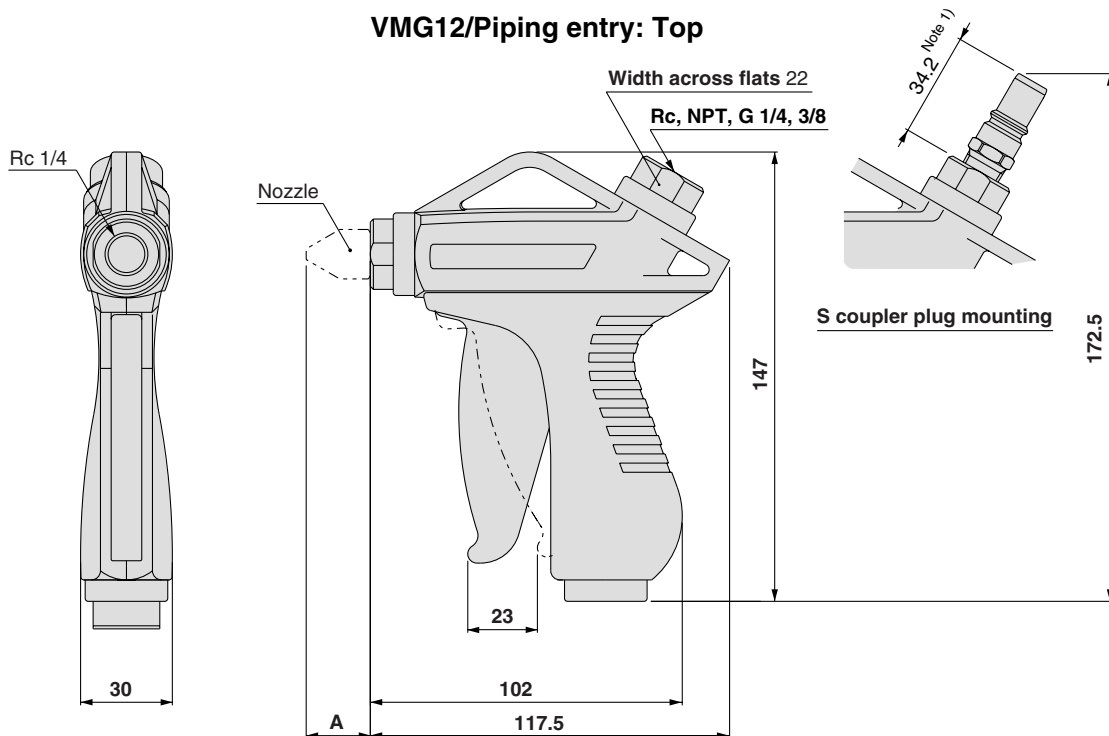

mm			
Type	Nozzle model	Nozzle size	A ^{Note 1)}
Male thread nozzle	KN-R02-100	ø1	23.4
	KN-R02-150	ø1.5	23
	KN-R02-200	ø2	22.5
	KN-R02-250	ø2.5	22.1
High efficiency nozzle	KNH-R02-100	ø1	44
	KNH-R02-150	ø1.5	44
	KNH-R02-200	ø2	44

mm			
Type	Nozzle model	Nozzle size	A ^{Note 1)}
Low noise nozzle with male thread	KNS-R02-075-4	ø0.75 x 4	12
	KNS-R02-090-8	ø0.9 x 8	12
	KNS-R02-100-4	ø1 x 4	12
	KNS-R02-110-8	ø1.1 x 8	12
Copper extension nozzle (with self align fitting H06-02)	KNL3-06-150	ø1.5	305.3
	KNL3-06-200	ø2	305.3
	KNL6-06-150	ø1.5	605.3
	KNL6-06-200	ø2	605.3

Note 1) Reference dimensions after installation

Dimensions: Nozzle/Series KN

Male thread nozzle: KN



Model	Nozzle size D	Connection thread	Width across flats	L ₁	A
			H ₁		
KN-R02-100	ø1	R 1/4	14	31.4	25.4
KN-R02-150	ø1.5	R 1/4	14	31	25
KN-R02-200	ø2	R 1/4	14	30.5	24.5
KN-R02-250	ø2.5	R 1/4	14	30.1	24.1

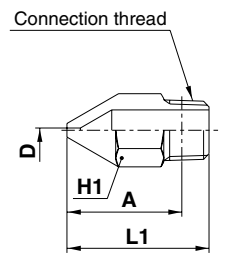

High efficiency nozzle: KNH



Model	Nozzle size D	Connection thread	Width across flats	L ₁	A
			H ₁		
KNH-R02-100	ø1	R 1/4	14	52	46
KNH-R02-150	ø1.5	R 1/4	14	52	46
KNH-R02-200	ø2	R 1/4	14	52	46

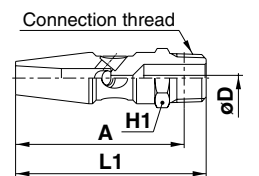

Low noise nozzle with male thread: KNS



Model	Nozzle size D	Connection thread	Width across flats	L ₁	A
			H ₁		
KNS-R02-075-4	ø0.75 x 4	R 1/4	14	20	14
KNS-R02-090-8	ø0.9 x 8	R 1/4	14	20	14
KNS-R02-100-4	ø1 x 4	R 1/4	14	20	14
KNS-R02-110-8	ø1.1 x 8	R 1/4	14	20	14

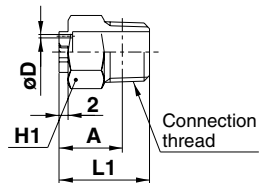

Copper extension nozzle: KNL



Model	Nozzle size D	Outside diameter	L ₁
	D		
KNL3-06-150	ø1.5	ø6	300
KNL3-06-200	ø2	ø6	300
KNL6-06-150	ø1.5	ø6	600
KNL6-06-200	ø2	ø6	600

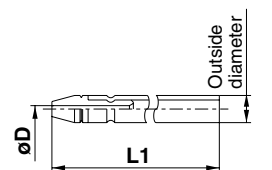

Note) When a copper extension nozzle is ordered separately, a self-align fitting will also be required for connection with the blow gun. Order one with the following part number in addition to the nozzle.

Self-align fittings (For copper extension nozzle connection)

Half union
H06-02

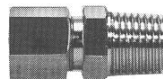

Product Profile:

Related Products: S Couplers

Series *KK/KKH/KKA*

Series *KK* General purpose type

- Effective area: **3.8 to 82 mm²**
(Series KK2) (Series KK6)
- Weight: **6.1 to 87.7 g**
(Series KK2) (Series KK6)
- With sleeve lock mechanism (Except KK2)



For details on this product, refer to page 15-2-75.

Series *KKH* With shock absorption cover

- Use of rubber sleeve cover and shock resistant cover ring enables Series KKH to absorb impact energy when dropped.
- Effective area is equivalent to that of Series KK.



For details on this product, refer to page 15-2-86.

Series *KKA* Stainless steel type

- Body material: Stainless steel 304
- Seal material: FKM
- Non-greased specification



For details on this product, refer to page 15-2-89.

Related Products: Regulator

Series AR30 to 60

How to Order



AR30

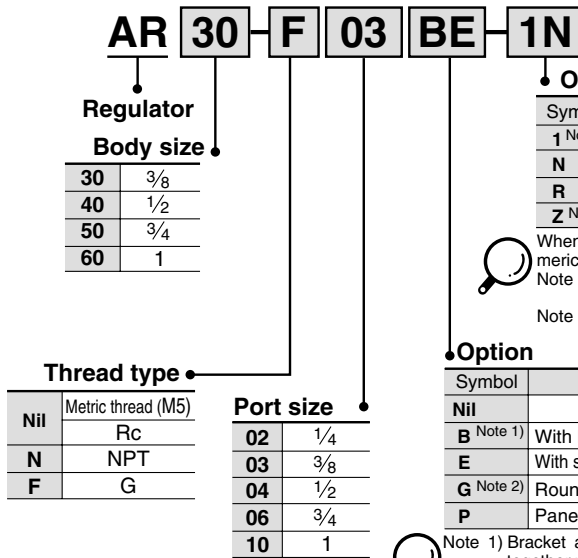

When more than one specification is required, indicate in ascending alphanumeric order.

Note 1) The only difference from the standard specifications is the adjusting spring for the regulator. It does not restrict the setting of 0.2MPa or more.

Note 2) For M5 and NPT thread types. Under the New Measurement Law, the product is only sold outside Japan. (The SI unit is used inside Japan.)

Note 1) Bracket assembly is not mounted at the time of shipment, but rather package together with the regulator.

Note 2) Mounting threads pressure gauge: AR30-1/8; AR40 to 60-1/4. Pressure gauge is not mounted at the time of shipment, but rather packaged together with the regulator.

Accessory/Option Specifications Combinations

⊙: Combination available ◻: Combination not available
 ○: Varies depending on the model △: Available only with NPT thread

Accessory/ Option specifications	Combination Symbol	Accessory				Option specifications				Applicable regulators AR30 to 60
		B	E	G	P	1	N	R	Z	
Accessory	With bracket (with set nut)	B	◻	○	⊙	◻	⊙	⊙	△	⊙
	Square embedded type pressure gauge	E	⊙	◻	◻	⊙	⊙	⊙	△	⊙
	Round pressure gauge	G	⊙	◻	◻	⊙	⊙	⊙	△	⊙
	Panel mount (with set nut)	P	◻	○	⊙	◻	⊙	⊙	△	○
Option specifications	0.02 to 0.2MPa setting	-1	⊙	○	⊙	⊙	◻	⊙	△	⊙
	Non-relieving type	-N	⊙	○	⊙	⊙	◻	⊙	△	⊙
	Flow direction: Right → Left	-R	⊙	○	⊙	⊙	⊙	◻	△	⊙
	Display units for product name plate and pressure gauge: PSI, °F.	-Z	△	△	△	△	△	△	◻	△

JIS Symbol

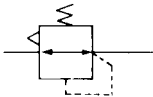

Standard Specifications

Model	AR30	AR40	AR40-06	AR50	AR60
Port size	1/4, 3/8	1/4, 3/8, 1/2	3/4	3/4, 1	1
Fluid	Air				
Proof pressure	1.5MPa				
Maximum operating pressure	1.0MPa				
Regulating pressure range	0.05 to 0.85MPa				
Gauge port size Note 1)	1/8	1/4	1/4	1/4	1/4
Relief pressure	Set pressure + 0.05MPa (at relief flow rate of 0.1ℓ/min(ANR))				
Ambient and fluid temperature	-5 to 60°C (With no condensation)				
Construction	Relieving type				
Weight (kg)	0.29	0.44	0.47	1.17	1.22

Note 1) The type with square embedded pressure gauge does not have connection threads.

Option/Part No.

Applicable model		AR30	AR40	AR40-06	AR50	AR60	
Option							
Bracket assembly Note 1)		AR30P-270AS	AR40P-270AS	AR40P-270AS	AR50P-270AS ^{Note 4)}	AR50P-270AS ^{Note 4)}	
Set nut		AR30P-260S	AR40P-260S	AR40P-260S	— Note 5)	— Note 5)	
Pressure gauge Note 2)	1MPa	Round	G36-10-□01	G46-10-□02	G46-10-□02	G46-10-□02	
		Square embedded type Note 3)	GC3-10AS	GC3-10AS	GC3-10AS	GC3-10AS	GC3-10AS
	0.2MPa	Round	G36-2-□01	G46-2-□02	G46-2-□02	G46-2-□02	G46-2-□02
		Square embedded type Note 3)	GC3-2AS	GC3-2AS	GC3-2AS	GC3-2AS	GC3-2AS

Note 1) Assembly includes a bracket and set nuts.

Note 2) □ in part numbers for a round pressure gauge indicates a type of connection threads. No indication is necessary for R; however, indicate and N for NPT. Please contact SMC for regarding the connection thread NPT and pressure gauge supply for PSI unit specifications.

Note 3) Includes one O-ring and 2 mounting screws.

Note 4) Assembly includes a bracket and 2 mounting screws.

Note 5) Please contact SMC regarding the set nuts for AR50 and AR60.



Related Products: Filter Regulator Series AW30/40

How to Order

Integration of a filter and regulator allows simple wiring.



AW40

Direct operated type, Relieving type

JIS Symbol

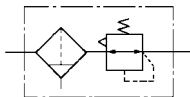

AW 30 - F 03 BE - 1N

Filter regulator

Body size

30	3/8
40	1/2

Thread type

Nil	Metric thread (M5)
	Rc
N Note 1)	NPT
F Note 2)	G

Note 1) Drain guide is NPT1/4 (applicable to AW30 and 40), and the exhaust port for auto drain comes with ø3/8" One-touch fitting (applicable to AW30 and 40).

Note 2) Drain guide is G1/4 (applicable to AW30 and 40).

Port size

02	1/4
03	3/8
04	1/2
06	3/4

Option specifications

Symbol	Contents	Applicable models
1 Note 1)	0.02 to 0.2MPa setting	AW30/40
2	Metal bowl	AW30/40
6	Nylon bowl	AW30/40
8	Metal bowl with level gauge	AW30/40
J Note 2)	Drain guide 1/4	AW30/40
N	Non-relieving	AW30/40
R	Flow direction: Right → Left	AW30/40
W	Drain cock with barb fitting: ø6 x ø4 nylon tube	AW30/40
Z Note 3)	Display units for product name plate, caution plate for bowl, and pressure gauge: PSI, °F	AW30/40

When more than one specification is required, indicate in ascending alphabetical order.

Note 1) The only difference from the standard specifications is the adjusting spring for the regulator. It does not restrict the setting of 0.2MPa or more.

Note 2) Without valve function.

Note 3) For M5 and NPT thread types. Under the New Measurement Law, this type is only sold outside Japan. (The SI unit is used inside Japan.)

Accessory

Symbol	Contents	Applicable models
Nil	—	—
B Note 1)	With bracket	AW30/40
C	Float type auto-drain (N.C)	AW30/40
D	Float type auto-drain (N.O)	AW30/40
E	With square embedded type pressure gauge (with limit indicator)	AW30/40
G Note 2)	With round pressure gauge (with limit indicator)	AW30/40
P	Panel mount (with set nut)	AW30/40

Note 1) Bracket assembly is not mounted at the time of shipment, but rather packaged together with the filter regulator for shipment.

Note 2) Mounting thread for pressure gauge: AW30—1/8; AR40 to 60—1/4.

Note 3) Pressure gauge is not mounted at the time of shipment, but rather packaged together with the regulator for shipment.

⊙: Combination available ⊠: Combination not available

○: Varies depending on the model △: Available only with NPT thread

Accessory/ Option Specifications Combinations

Accessory/ Option specifications	Combination	Symbol	Accessory													Option specifications								Applicable filter regulator
			B	C	D	E	G	P	1	2	6	8	C	J	N	R	W	Z	AW30/40					
Accessory	With bracket (with set nut)	B	⊙	⊙	○	○	⊙	⊙	⊙	⊙	⊙	⊙	○	○	⊙	⊙	○	△	⊙					
	Float type auto drain (N.C.)	C	⊙	⊙	⊙	○	⊙	⊙	⊙	⊙	⊙	○	○	⊙	⊙	⊙	△	⊙						
	Float type auto drain (N.O.)	D	⊙	⊙	⊙	○	⊙	⊙	⊙	⊙	⊙	○	○	⊙	⊙	⊙	△	⊙						
	Square embedded type pressure gauge	E	⊙	⊙	⊙	○	⊙	⊙	⊙	⊙	⊙	○	○	⊙	⊙	⊙	△	⊙						
	Round pressure gauge	G	⊙	⊙	○	○	⊙	⊙	⊙	⊙	⊙	○	○	⊙	⊙	⊙	△	⊙						
	Panel mount (with set nut)	P	⊙	⊙	○	○	⊙	⊙	⊙	⊙	⊙	○	○	⊙	⊙	⊙	△	⊙						
Option specifications	0.02 to 0.2MPa setting	-1	⊙	⊙	○	○	⊙	⊙	⊙	⊙	⊙	○	○	⊙	⊙	○	△	⊙						
	Metal bowl	-2	⊙	⊙	○	○	⊙	⊙	⊙	⊙	⊙	○	○	⊙	⊙	⊙	△	⊙						
	Nylon bowl	-6	⊙	⊙	○	○	⊙	⊙	⊙	⊙	⊙	○	○	⊙	⊙	⊙	△	⊙						
	Metal bowl with level gauge	-8	⊙	⊙	○	○	⊙	⊙	⊙	⊙	⊙	○	○	⊙	⊙	⊙	△	⊙						
	With bowl guard	-C	⊙	⊙	○	○	⊙	⊙	⊙	⊙	⊙	○	○	⊙	⊙	⊙	△	⊙						
	Drain guide 1/4	-J	⊙	⊙	○	○	⊙	⊙	⊙	⊙	⊙	○	○	⊙	⊙	⊙	△	⊙						
	Non-relieving type	-N	⊙	⊙	○	○	⊙	⊙	⊙	⊙	⊙	○	○	⊙	⊙	⊙	△	⊙						
	Flow direction: Right → Left	-R	⊙	⊙	○	○	⊙	⊙	⊙	⊙	⊙	○	○	⊙	⊙	⊙	△	⊙						
	Drain cock with barb fitting: ø6 x ø4 nylon tubing	-W	⊙	⊙	○	○	⊙	⊙	⊙	⊙	⊙	○	○	⊙	⊙	⊙	△	⊙						
	Display units for product name plate, caution plate for bowl, and pressure gauge: PSI, °F	-Z	△	△	△	△	△	△	△	△	△	△	△	△	△	△	△	△	△					

Standard Specifications

Model	AW30	AW40	AW40-06	
Port size	1/4, 3/8	1/4, 3/8, 1/2	3/4	
Fluid	Air			
Proof pressure	1.5MPa			
Maximum operating pressure	1.0MPa			
Regulating pressure range	0.05 to 0.85MPa			
Pressure gauge port size Note 1)	1/8	1/4	1/4	
Relief pressure	Set pressure + 0.05MPa (at relief flow rate of 0.1l/min(ANR))			
Ambient and fluid temperature	-5 to 60°C (With no condensation)			
Nominal filtration rating	5µm			
Drain capacity (cm³)	25	45	45	
Bowl material	Polycarbonate			
Construction	Relieving type			
Weight (kg)	0.40	0.72	0.75	
Option	Bowl guard	●	●	●

Note 1) The type with square embedded pressure gauge does not have connection threads.

Accessory Part No.

Accessory		Applicable model			
		AW30	AW40	AW40-06	
Bracket assembly Note 1)		AR30P-270AS	AR40P-270AS	AR40P-270AS	
Set nut		AR30P-260S	AR40P-260S	AR40P-260S	
Pressure gauge Note 2)	1.0MPa	Round	G36-10-□01	G46-10-□02	G46-10-□02
		Square embedded type Note 3)	GC3-10AS	GC3-10AS	GC3-10AS
	0.2MPa	Round	G36-2-□01	G46-2-□02	G46-2-□02
		Square embedded type Note 3)	GC3-2AS	GC3-2AS	GC3-2AS
Float type auto-drain Note 4)	N.O.	AD38	AD48	AD48	
	N.C.	AD37	AD47	AD47	

Note 1) Assembly includes a bracket and set nuts.

Note 2) □ in part numbers of the round pressure gauge indicates a type of connection thread. No indication is necessary for R; however, indicate N for NPT. Please contact SMC regarding the connection thread NPT and supply of the pressure gauge for PSI unit specifications.

Note 3) Includes one O-ring and 2 mounting screws.

Note 4) Minimum operating pressure: N.O. type—0.1MPa; N.C. type—0.1MPa AD17, AD27 and 0.15MPa for AD37, AD47. Please contact SMC regarding the specifications for PSI unit and °F.



Specific Product Precautions 1

Be sure to read before handling.

Selection

Warning

1. Confirm the specifications.

The products in this catalog are designed to be used in compressed air systems only. If the products are used in an environment where pressure or temperature is out of the specified range, damage and/or malfunction may result. Do not use under such conditions.

Caution

1. Do not apply the blow gun to flammable, explosive or toxic substances such as gas, fuel gas or refrigerant. Such substances may exude from inside the blow gun.

Mounting

Warning

1. Install a stop valve on the supply pressure side of the blow gun to enable emergency shut off in case of unexpected leakage or damage.
2. When installing a nozzle on the blow gun, wrap seal tape around the threads of the nozzle.
3. When installing the nozzle, secure the nozzle holder of the blow gun by applying a spanner of 22 mm width across flats to the two chamfered surfaces of the holder without applying force to the body. Then tighten the nozzle with force within the following torque ranges. As a guideline, it is equivalent to 2 to 3 additional turns with a tool after manual tightening.

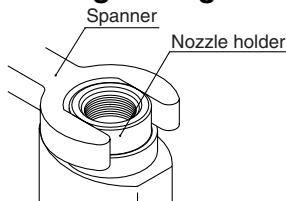

Nozzle tightening torque range	12 to 14Nm
--------------------------------	------------

Insufficient tightening may cause loosening of the nozzle.

Piping

Caution

1. Confirm the model, type and size before installation.

Also make sure that there is no scratches, gouges or cracks on the product.

2. Before piping

Before piping, it should be thoroughly blown out with air (flushing) or washed to remove chips, cutting oil and other debris from inside the pipe.

3. Wrapping of pipe tape

When screwing together pipes and fittings, etc., be certain that chips from the pipe threads and sealing material do not get inside the piping. Also, when the pipe tape is used, leave 1.5 to 2 thread ridges exposed at the end of the threads.

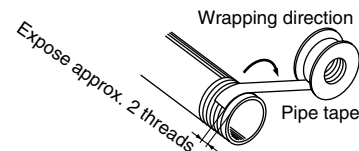

4. When installing the nozzle, secure the nozzle holder of the blow gun by applying a spanner of 22 mm width across flats to the two chamfered surfaces of the holder without applying force to the body. Then tighten the nozzle with torque specified in the table below. As a guideline, it is equivalent to 2 to 3 additional turns using a tool after manual tightening.

Be careful that tightening with torque beyond the ranges in the table below may cause damage to the body.

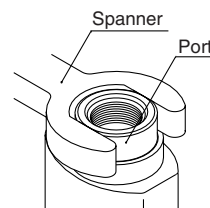

Male thread	Tightening torque N·m
R 1/4	12 to 14
R 3/8	22 to 24

5. Allow extra length when connecting the tube to accommodate changes in tube length due to pressure.
6. Make sure that no twisting, turning or tensile force or moment load is applied to the port or tube. It may cause the fittings to fracture or the tubing to crush, explode or come loose.
7. Do not abrade, entangle or scratch the tubing. It may cause the tubing to crush, explode or come loose.

K M H D MS T VMG



Specific Product Precautions 2

Be sure to read before handling.

Lubrication

⚠ Warning

1. **Do not lubricate the product.**
It may contaminate or damage the target object.

Air Supply

⚠ Warning

1. **Use clean air.**
Do not use compressed air which includes chemicals, synthetic oils containing organic solvents, salt or corrosive gases, etc., as it can cause damage or malfunction.

⚠ Caution

1. **Install air filters.**
Install air filters at the upstream side of blow gun. The filtration degree should be 5 μ m or finer.
2. **Install an after-cooler, air dryer or water separator, etc.**
Air excessive drainage may cause malfunction of blow gun and contaminate or damage the target object. To prevent this, install an after-cooler, air dryer or water separator, etc.

Operating Environment

⚠ Warning

1. **Do not use in an atmosphere of corrosive gases, chemicals, sea water, water or water vapor or in an environment where such substances may adhere.**
2. **Provide shading in an environment where the product is exposed to the sunlight.**
3. **Do not use in an environment where a heat source is at a close distance.**
4. **Do not use in an environment where static electricity is a problem. It may cause malfunction or failure of the system. Please consult with SMC for use in such an environment.**
5. **Do not use in an environment where spatters are generated. There is danger of fires caused by spattering. Please contact SMC for use in such an environment.**
6. **Do not use in an environment where the product is exposed to cutting oil, lubricant oil or coolant oil. Please contact SMC for use in an environment where the product is exposed to such liquid as cutting oil, lubricant oil or coolant oil.**

Maintenance

⚠ Caution

1. **In periodical inspections, check the following items and replace the parts if necessary.**
 - a) Scratches, gouges, abrasion, corrosion
 - b) Air leakage
 - c) Twisting, crushing and turning of connected tubes
 - d) Hardening, deterioration and softening of connected tubes
 - e) Loosening of the nozzle
2. **When removing the product, first stop the pressure supply, exhaust compressed air in the piping and confirm the condition of atmospheric release.**
3. **Do not disassemble or remodel the body of the product.**

Handling

⚠ Warning

1. **To prevent lurching of the nozzle due to air pressure, confirm that the nozzle is not loosened or rattling by pulling it by hand before operation.**
2. **Be sure to wear safety goggles to protect yourself from splashed substances.**
3. **Do not direct the tip of the nozzle at the face or other parts of a human body. It may cause danger to personnel.**
4. **Do not use the product to clean or remove toxic substances or chemicals.**
5. **Do not drop, step on or hit the product. It may cause damage to the product.**
6. **Do not use the product to disturb public order or public hygiene.**
7. **This product is not a toy.**