

Actuators

# Compact precision linear slide tables

M/261000/M

Double acting

Ø 6 to 16 mm

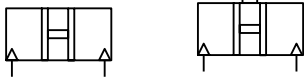

Ideal for applications demanding precise movement within a confined space

Light weight

Magnetic switching for positional feedback

Excellent service life

### Technical data

Medium:

Compressed air, filtered, lubricated or non-lubricated

Operation:

Double acting precision slide table with linear guide

Operating pressure:

1.5 to 7 bar

(2.5 to 7 bar for Ø 8 mm models with shock absorbers)

(2 to 7 bar for Ø 10 mm models with shock absorbers)

Operating temperature:

+5°C to +60°C

Consult our Technical Service for use below +2°C

Cylinder diameters:

6, 8, 10, 12 and 16 mm

Strokes:

5, 10 mm (Ø 6 mm)

10, 20 mm (Ø 8 and 10 mm)

15, 25 mm (Ø 12 mm)

20, 30 mm (Ø 16 mm)

Speed:

120 cycles/min. maximum

45 cycles/min. maximum for Ø 8, 10 and 12 mm models with shock absorbers

60 cycles/min. maximum for Ø 16 mm

models with shock absorbers

Materials

Slide table: stainless steel, synthetic resin and synthetic rubber

Body: stainless steel

Stopper: nickel coated steel

Stroke adjustment bolts and nuts: nickel plated steel

Stroke adjustment bolts with rubber stops: stainless steel and rubber

Stroke adjustment block: nickel coated carbon steel

Shock absorber: nickel coated copper alloy (Ø 8, 10 and 12 mm); nickel coated carbon steel (Ø 16 mm)

Elastomers: synthetic rubber

### Standard models

Ø	Port size	Model (Magnetic)** Stroke adjustment (rubber stops)	Service kit
6	M3	M/261006/IR5/IP/*	QM/261006/00
8	M5	M/261008/MR6/IP/*	QM/261008/00
10	M5	M/261010/MR6/IP/*	QM/261010/00
12	M5	M/261012/MR6/IP/*	QM/261012/00
16	M5	M/261016/MR6/IP/*	QM/261016/00

\* Insert stroke length in mm.

\*\* Ø 6 mm - non-magnetic only.

### Standard strokes

Ø (mm)	5	10	15	20	25	30
6	●	●				
8		●		●		
10		●		●		
12			●		●	
16				●		●

### Options selector

M/2610\*\*\*R\*\*\*/\*\*\*/\*\*/\*\*\*

Piston diameter (mm)	Substitute	Standard stroke lengths (mm)
6	06	5 and 10 mm (Ø 6 mm)
8	08	10 and 20 mm (Ø 8 and 10 mm)
10	10	15 and 25 mm (Ø 12 mm)
12	12	20 and 30 mm (Ø 16 mm)
16	16	

Type	Substitute	Port location	Substitute
Magnetic*	M	Side ported	P
Non-magnetic	I	Base mounted	B





Stroke adjustment	Substitute	Location of switch rail and stroke adjusters	Substitute
No stroke adjustment	1	Standard	I
Single side adjustment, metal stop*	2	Symmetric*	S
In and outstroke adjustment, metal stops**	3		
In and outstroke adjustment, shock absorbers**#	4		
Single side adjustment, rubber stop*	5		
In and outstroke adjustment, rubber stops**	6		

\* Available for Ø 6 mm models only

\*\* Available for Ø 8, 10, 12 and 16 mm models only

# Not available on symmetric models

### Switches with LED indication

Reed In-line cable	Reed 90° cable	Solid state In-line cable	Solid state 90° cable
			
M/369/LSU/1 M/369/LSU/3	M/370/LSU/1 M/370/LSU/3	M/418/EAU/1 M/418/EAU/3 M/420/EAN/1 M/420/EAN/3	M/419/EAU/1 M/419/EAU/3 M/421/EAN/1 M/421/EAN/3

ACT-126

# Compact precision linear slide tables

M/261000/M

Double acting

Ø 6 to 16 mm

## Mountings and accessories

Model	Ø (mm)	Stroke adjustment assembly (metal stop)	Stroke adjustment assembly (rubber stop)	Stroke adjustment assembly (shock absorbers)	Shock absorber	Switch rail	Magnet (with fixing screws)	Base mount O-rings (pack of 10)
M/261006/*R*/**/**	6	-	-	-	-	-	-	QM/261000/00
M/261008/*R*/**/**	8	QM/261008/3/*	QM/261008/6/*	QM/261008/4/*	M/P73454/1	M/P73428/1/*	M/P73431/5	QM/261000/00
M/261010/*R*/**/**	10	QM/261010/3/*	QM/261010/6/*	QM/261010/4/*	M/P73454/1	M/P73428/2/*	M/P73431/4	QM/261000/00
M/261012/*R*/**/**	12	QM/261012/3/*	QM/261012/6/*	QM/261012/4/*	M/P73454/1	M/P73428/3/*	M/P73431/4	QM/261000/00
M/261016/*R*/**/**	16	QM/261016/3/*	QM/261016/6/*	QM/261016/4/*	M/P73454/2	M/P73428/4/*	M/P73431/4	QM/261000/00



Model	Ø (mm)	Stroke adjustment bolt (metal stop) and nut 5 mm stroke	10 mm stroke	15 mm stroke	20 mm stroke	25 mm stroke	30 mm stroke
M/261006/*R*/**/**	6	M/P73424/2	M/P73424/3	-	-	-	-
M/261008/*R*/**/**	8	-	M/P73424/1	-	M/P73424/1	-	-
M/261010/*R*/**/**	10	-	M/P73424/1	-	M/P73424/2	-	-
M/261012/*R*/**/**	12	-	-	M/P73424/4	-	M/P73424/5	-
M/261016/*R*/**/**	16	-	-	-	M/P73424/7	-	M/P73424/7



Model	Ø (mm)	Stroke adjustment bolt (rubber stop) and nut 5 mm stroke	10 mm stroke	15 mm stroke	20 mm stroke	25 mm stroke	30 mm stroke
M/261006/*R*/**/**	6	M/P73425/2	M/P73425/3	-	-	-	-
M/261008/*R*/**/**	8	-	M/P73425/1	-	M/P73425/1	-	-
M/261010/*R*/**/**	10	-	M/P73425/1	-	M/P73425/2	-	-
M/261012/*R*/**/**	12	-	-	M/P73425/4	-	M/P73425/5	-
M/261016/*R*/**/**	16	-	-	-	M/P73425/7	-	M/P73425/7



\* Insert stroke length (10, 15, 20, 25, or 30 mm)

### M/261006/IR1/I\*/\*\*

Standard compact precision slide table, no stroke adjustment

### M/261006/IR2/I\*/\*\*, M/261006/IR5/I\*/\*\*

Compact precision slide table with single side stroke adjustment

- # Stroke
- 1 Air ports side ported
  - 2 Air ports base mounted  
2 - Ø 9.5 (O-ring I/D)

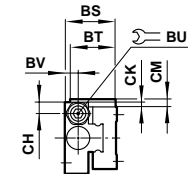
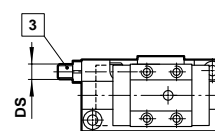
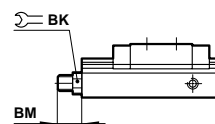
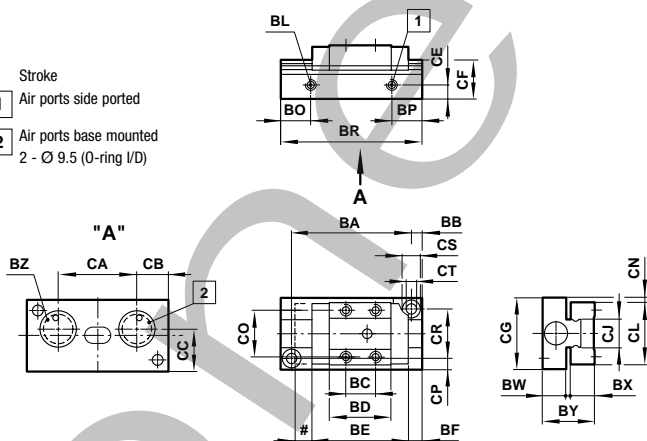

3 Stroke adjustment bolt

Model	Ø	BC	BD	BE	BH	BJ	BK	BL	BO	BP	BS	BT	BU
M/261006/IR*/**/**	6	10	19.8	31	4	15	7	M3	9.7	5.7	16.7	14.2	2.5
Model	Ø	BV	BW	BX	BY ±0.05	Ø BZ	CB	CC	CD	CE	CF	CG -0.2	CH
M/261006/IR*/**/**	6	4.5	7.8	7.8	17	9.5	8	14.5	1.8	5	12.5	23	4
Model	Ø	CJ	CK ±0.1	CL -0.05	CM	CN ±0.1	CO	CP	CR	CS	CT	DS	
M/261006/IR*/**/**	6	9	1.5	20	2.5	1.5	15	3.5	16	Ø 6	Ø 3.3	M5	
Model	Ø	Stroke	BA	BB	BF	BG	BM	BR	CA	kg			
M/261006/IR*/**/5	6	5	38	3.5	4.5	22	max. 9.5	45	25	0.080			
M/261006/IR*/**/10	6	10	52	4	9.5	30	max. 12.5	60	40	0.100			

Dimensions in mm

Actuators

# Compact precision linear slide tables

M/261000/M

Double acting

Ø 6 to 16 mm

Dimensions in mm

M/2610\*\*/\*R1/I\*/\*\* Standard compact precision slide table, no stroke adjustment (Ø 8 to 12 mm)

M/2610\*\*/\*R1/S\*/\*\* Symmetric compact precision slide table, no stroke adjustment (Ø 8 to 12 mm)

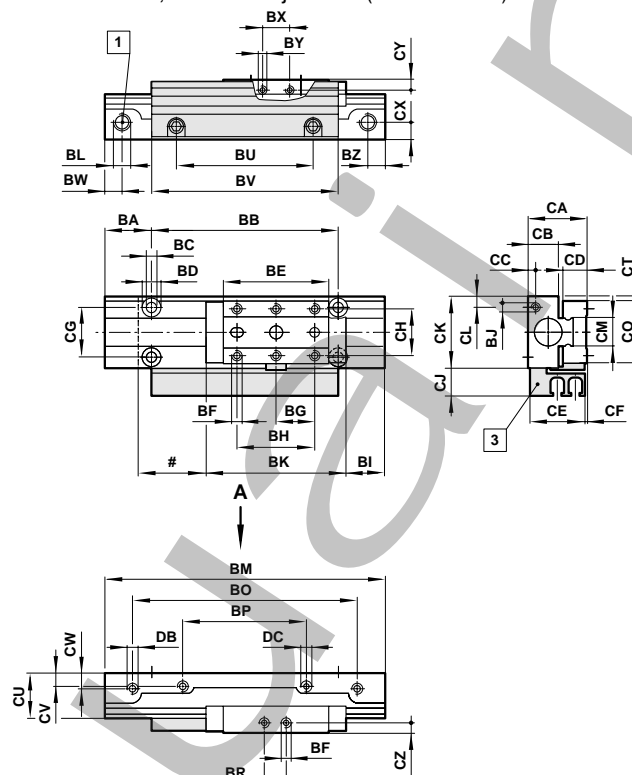

- # Stroke
- 1 Air ports side ported
  - 2 Air ports base mounted  
2 - Ø 9.5 (O-ring I/D)
  - 3 Magnetic version

Model	Ø	BA	Ø BC	Ø BD	BF	BJ*	BL	BS	BW	BZ	CA	CB	CC
M/261008/*R1/**/**	8	14	3.3	6	M3x3 deep	—	M5	M4x5 deep	5.5	5.5	19 ±0.05	9.8	—
M/261010/*R1/**/**	10	14	3.3	6	M3x3 deep	M3x5 deep	M5	M4x5 deep	6	6	20 ±0.02	9.5	4
M/261012/*R1/**/**	12	15	4.2	8	M3x4 deep	M3x5 deep	M5	M5x4.5 deep	6	6	22 ±0.02	9.5	5.5
Model	Ø	CD	CE	CF	CG	CH	CJ	CK	CL	CM	CO	CP	CR
M/261008/*R1/**/**	8	7.8	18	0.5	16	15	9	23 -0.2	—	9	20 -0.05	7	13.5
M/261010/*R1/**/**	10	10	19	0.5	21	20	10	28 ±0.2	5	12	27 ±0.2	7.5	17.5
M/261012/*R1/**/**	12	12	19	1	24	25	10	33 ±0.2	6.5	15	32 ±0.2	8	21
Model	Ø	Ø CS	CT	CU	CV	CW	CX	CY	CZ				
M/261008/*R1/**/**	8	9.5	1.5 ± 0.1	14.5	3.5	4.5	5.5	3	3				
M/261010/*R1/**/**	10	9.5	0.5 ± 0.025	15.5	4	5.5	5.5	4	4				
M/261012/*R1/**/**	12	9.5	0.5 ± 0.025	17	5.5	5.5	5.5	4.5	4.5				

Model	Ø	Stroke	BB	BE	BG	BH	BI	BK	BM	BO	BP
M/261008/*R1/**/10	8	10	32	19.8	—	15	9.5	31	60	53	21
M/261008/*R1/**/20	8	20	60	33.8	—	16	12.5	45	90	72	40
M/261010/*R1/**/10	10	10	32	21	—	15	8	34	60	48	20
M/261010/*R1/**/20	10	20	62	36	15	30	10.5	49	90	78	50
M/261012/*R1/**/15	12	15	46	26.8	—	20	9.5	42	76	64	30
M/261012/*R1/**/25	12	25	76	47.5	20	40	9.15	62.7	106	94	60
Model	Ø	BR	BT	BU	BV	BX	BY	DB	DC	kg	kg (Magnet)
M/261008/*R1/**/10	8	6.5	46	21	38	6.5	M3x3 deep	M3x4 deep	M3x4 deep	0.1	0.010
M/261008/*R1/**/20	8	6.5	76	40	60	6.5	M3x3 deep	M3x4 deep	M3x4 deep	0.16	0.015
M/261010/*R1/**/10	10	8	45	20	36	10	M2x3 deep	—	M3x5 deep	0.135	0.015
M/261010/*R1/**/20	10	8	75	50	66	10	M2x3 deep	—	M3x5 deep	0.210	0.020
M/261012/*R1/**/15	12	12	60	30	46	10	M3x5 deep	—	M3x5 deep	0.215	0.015
M/261012/*R1/**/25	12	12	90	60	76	10	M3x5 deep	—	M3x5 deep	0.320	0.025

\* Applicable to Ø 10 and 12 models with stroke lengths 10mm

Note: drawing shows standard model. For symmetric model see data sheet page no. 2.3.001.11

ACT-128

# Compact precision linear slide tables

M/261000/M

Double acting

Ø 6 to 16 mm

Dimensions in mm

M/2610\*\*/R3/\*\*/\*\* Standard compact precision slide tables with stroke adjustment (metal stops. Ø 8 to 12 mm)

M/2610\*\*/R6/\*\*/\*\* Standard compact precision slide tables with stroke adjustment (rubber stops. Ø 8 to 12 mm)

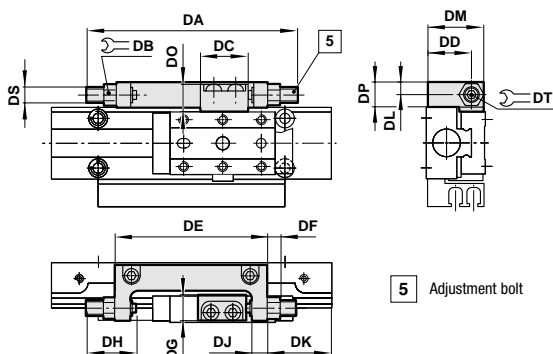

Model	Ø	DB	DC	DD	DF	DG	DL
M/261008/**R**/**	8	7	15.5	14.5	4	8	4
M/261010/**R**/**	10	7	16	15	4	8	4
M/261012/**R**/**	12	8	20	15.5	5	10	5

Model	Ø	DM	DO	DP	DS	DT
M/261008/**R**/**	8	18.5	8	8	M5	2.5
M/261010/**R**/**	10	19.5	8	8	M5	2.5
M/261012/**R**/**	12	21.5	10	10	M6	3

Model	Ø	Stroke	DA max.	DE	DH	DJ	DK	kg
M/261008/**R**/**/10	8	10	57.5	38	16	4.5	11	0.035
M/261008/**R**/**/20	8	20	67.5	49	16	5	20.5	0.045
M/261010/**R**/**/10	10	10	58	37	16	4.5	11.5	0.040
M/261010/**R**/**/20	10	20	80	66	22	10	16	0.060
M/261012/**R**/**/15	12	15	71	50	18	6	13	0.070
M/261012/**R**/**/25	12	25	89	68	22	10	19	0.090

M/2610\*\*/R4/\*\*/\*\* Standard compact precision slide tables with stroke adjustment (shock absorbers. Ø 8 to 12 mm)

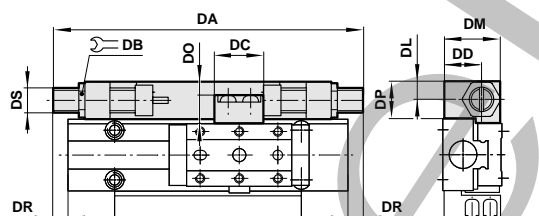

Ø 8 mm

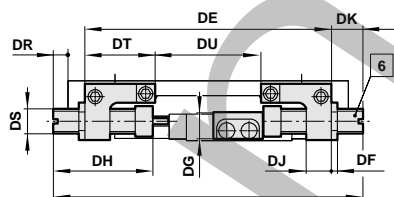

Ø 10 & 12 mm

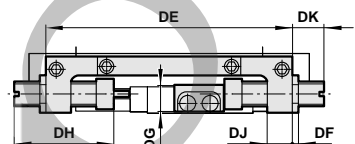

Model	Ø	DB	DC	DD	DF	DG	DH	DJ
M/261008/**R4**/**	8	11	15.5	12.5	2	8	32	8
M/261010/**R4**/**	10	11	16	13.5	2	8	32	5
M/261012/**R4**/**	12	11	20	15.5	2	10	32	6

Model	Ø	DL	DM	DO	DP
M/261008/**R4**/**	8	6	18	8	12
M/261010/**R4**/**	10	6	19	8	12
M/261012/**R4**/**	12	6	21	10	12

Model	Ø	Stroke	DA	DE	DJ	DK	DR	kg
M/261008/**R4**/**/10	8	10	89.5	60	8	15	15	0.065
M/261008/**R4**/**/20	8	20	99.5	79	8	10.5	5	0.065
M/261010/**R4**/**/10	10	10	90	60	5	15	15	0.070
M/261010/**R4**/**/20	10	20	100	60	5	20	5	0.070
M/261012/**R4**/**/15	12	15	99	71	6	13.5	11.5	0.090
M/261012/**R4**/**/25	12	25	109	71	10	17.5	1.5	0.090

Actuators

# Compact precision linear slide tables

M/261000/M

Double acting

Ø 6 to 16 mm

Dimensions in mm

M/2610\*\*/\*R1/I\*\*/\* Standard compact precision slide table. no stroke adjustment (Ø 16 mm)

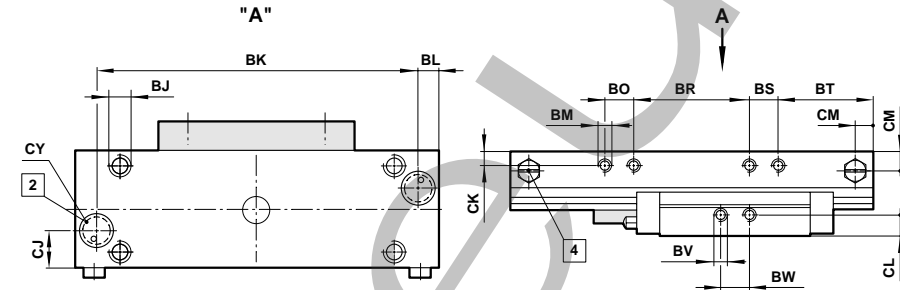
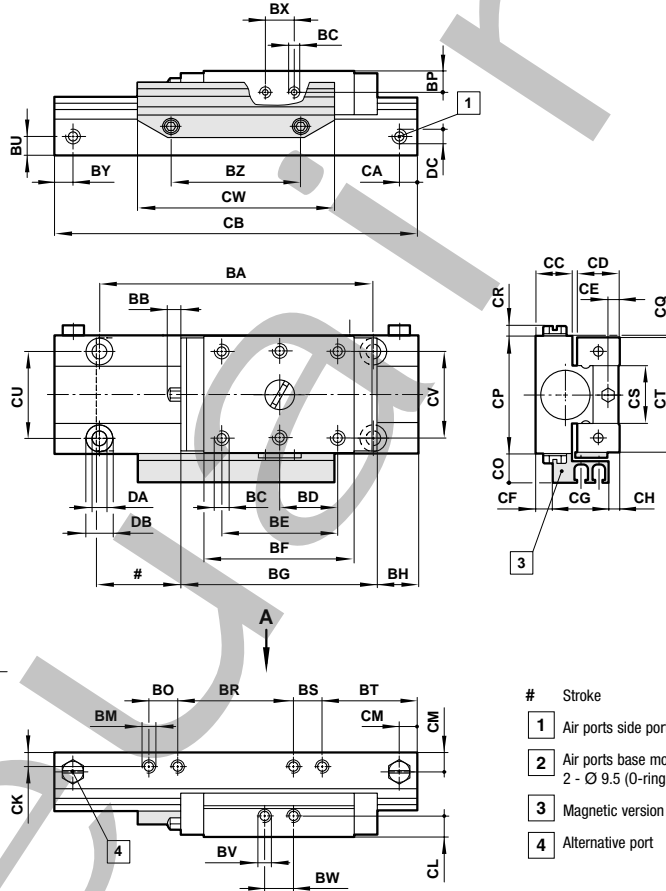

Model	Ø	BB	BC	BJ	BL	BM	BO	BP	BS	BU	BV	BW	BX
M/261016/*R1/I**/*	16	4.5	M4x6 deep	M6x6 deep	7.5	M4x7 deep	10	7	10	6.5	M4x7 deep	10	10
Model	Ø	BY	CA	CC	CD	CE	CF	CG	CH	CJ	CK	CL	CM
M/261016/*R1/I**/*	16	6.5	6.5	12.5	15	4.2	6.2	19	3.8	13	5	7	6.5
Model	Ø	CO	CP	CQ	CR	CS	CT	CU	CV	Ø DA	Ø DB	DC	
M/261016/*R1/I**/*	16	10	41 ± 0.2	0.5	3.5	20	40 ± 0.2	30	30	5.3	9.5x6.5 deep	M5	

Model	Ø	Stroke	BA	BD	BE	BF	BG	BH	BK	BR	BT	BZ	CB	CW	kg	kg (Magnet)
M/261016/*R1/I**/20	16	20	65	-	25	34.6	50	13	81	30	23	34	96	57	0.445	0.015
M/261016/*R1/I**/30	16	30	95	20	40	52.3	68	14	111	40	33	45	126	68	0.610	0.020

ACT-130

## Compact precision linear slide tables

M/261000/M

Double acting

Ø 6 to 16 mm

Dimensions in mm

M/261016/\*R3/\*\*/\*\* Standard compact precision slide table with stroke adjustment (metal stops, Ø 16 mm)

M/261016/\*R6/\*\*/\*\* Standard compact precision slide table with stroke adjustment (rubber stops, Ø 16 mm)

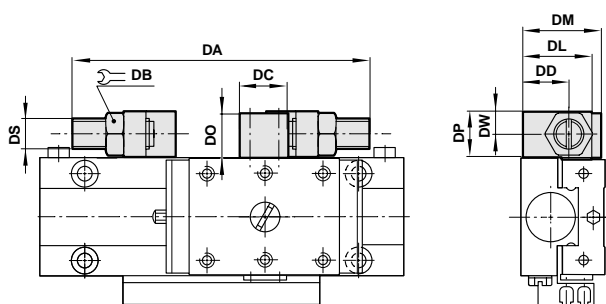

Model	Ø	DB	DC	DD	DF	DG	DH	DJ
M/261016/*R*/**/**	16	10	20	18	5.5	14	25	8
Model	Ø	DL	DM	DO	DP	DS	DT	DW
M/261016/*R*/**/**	16	24	27.5	12	12	M8	20	6

Model	Ø	Stroke	DA max.	DE	DK	DU	kg
M/261016/*R*/**/**/20	16	20	90	60	18	20	0.100
M/261016/*R*/**/**/30	16	30	100	70	28	30	0.100

5 Adjustment bolt

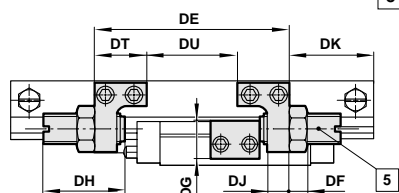

M/261016/\*R4/\*\*/\*\* Standard compact precision slide table with stroke adjustment (shock absorbers, Ø 16 mm)

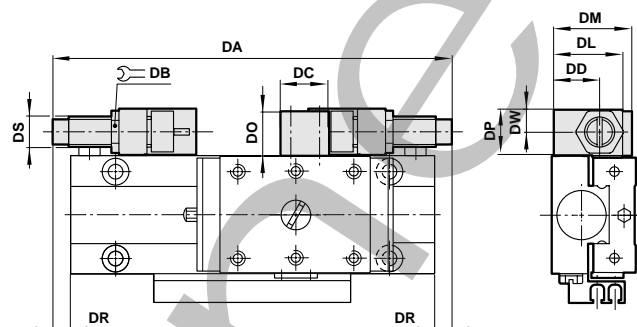

Model	Ø	DB	DC	DD	DF	DG	DH	DJ
M/261016/*R4/**/**	16	13	20	19	3	14	50	7
Model	Ø	DL	DM	DO	DP	DS	DT	DW
M/261016/*R4/**/**	16	26.5	27.5	12	15	M10	25	7.5

Model	Ø	Stroke	DA max.	DE	DK	DR max.	DU	kg
M/261016/*R4/**/**/20	16	20	140	70	13	22	20	0.145
M/261016/*R4/**/**/30	16	30	150	80	23	12	30	0.145

6 Shock absorber

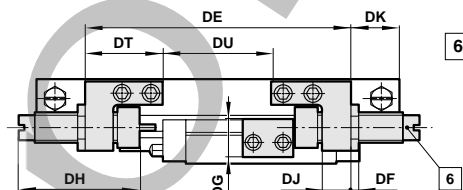

Actuators

# Precision linear slide tables

M/261100/M

Double acting

Ø 10 and 12 mm



**Ideal for applications demanding precise movement**

**Light weight**

**Magnetic switching for positional feedback**

**Excellent service life**

### Technical data

Medium:

Compressed air, filtered, lubricated or non-lubricated

Operation:

Double acting precision slide table with external guide

Operating pressure:

1.5 to 7 bar (2 to 7 bar for models with shock absorbers)

Operating temperature:

+ 5°C to + 60°C

Consult our Technical Service for use below +2°C

Cylinder diameters:

10 and 12 mm

Strokes:

15, 30, 45 mm (Ø 10 mm)

20, 30, 45, 60 mm (Ø 12 mm)

Speed:

400 mm/s maximum

Materials

Slide table: stainless steel

Body: stainless steel

End plate: nickel plated carbon steel

Piston rod: stainless steel

External nuts and bolts: nickel plated carbon steel

Stroke adjustment bolts and blocks: nickel plated steel

Stroke adjustment bolts with rubber stops: stainless steel and synthetic rubber

Shock absorbers: brass alloy

Elastomers: synthetic rubber

### Standard models

Ø	Port size	Model (Magnetic)	Stroke adjustment (rubber stops)
10	M5	M/261110/MR6/IP/**	
12	M5	M/261112/MR6/IP/**	

\* Insert stroke length in mm.

### Standard strokes

Ø (mm)	15	20	30	45	60
10	●		●	●	
12		●	●	●	●

### Options selector

M/2611\*\*\*R\*\*P\*\*\*

Piston diameter (mm)	Substitute
10	10
12	12

Piston	Substitute
Magnetic*	M
Non-magnetic	I

Stroke adjustment	Substitute
No stroke adjustment	1
In and outstroke adjustment with metal stops	3
In and outstroke adjustment with shock absorbers	4
Out stroke adjustment with rubber stop	5
In and outstroke adjustment with rubber stops	6
Out stroke adjustment with metal stop	7
Out stroke adjustment with shock absorber	8

Stroke length (mm)
60 mm max.

Location of switch rail and stroke adjusters	Substitute
Standard	I
Symmetric	S

### Switches with LED indication

Reed In-line cable	Reed 90° cable	Solid state In-line cable	Solid state 90° cable
M/369/LSU/1	M/370/LSU/1	M/418/EAU/1	M/419/EAU/1
M/369/LSU/3	M/370/LSU/3	M/418/EAU/3	M/419/EAU/3
		M/420/EAN/1	M/421/EAN/1
		M/420/EAN/3	M/421/EAN/3









## Precision linear slide tables

M/261100/M

Double acting

Ø 10 and 12 mm

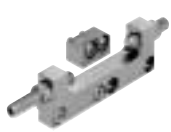
### Accessories

Ø	Stroke adjustment bolt (metal stop)		Stroke adjustment bolt (rubber stop)		Push side stroke adjustment assembly (metal stop)	
	Pull side	Push side	Pull side	Push side	Standard	Symmetric
						
10	M/P73424/3	M/P73424/2	M/P73425/3	M/P73425/2	QM/261110/I7/*	QM/261110/S7/*
12	M/P73424/6	M/P73424/5	M/P73425/6	M/P73425/5	QM/261112/I7/*	QM/261112/S7/*
Ø	Push side stroke adjustment assembly (rubber stop)		Push side stroke adjustment assembly (shock absorber)		Switch rail	
	Standard	Symmetric	Standard	Symmetric	Standard	Symmetric
						
10	QM/261110/I5/*	QM/261110/S5/*	QM/261110/I8/*	QM/261110/S8/*	M/P73430/2/*	M/P73429/2/*
12	QM/261112/I5/*	QM/261112/S5/*	QM/261112/I8/*	QM/261112/S8/*	M/P73430/3/*	M/P73429/3/*
Ø	Push and pull side stroke adjustment assembly (rubber stop)		Push and pull side stroke adjustment assembly (shock absorber)		Magnet	
						
10	QM/261110/6/*	QM/261110/3/*	QM/261110/4/*	M/P73454/1	M/P73431/3	
12	QM/261112/6/*	QM/261112/3/*	QM/261112/4/*	M/P73454/1	M/P73431/3	

\* Insert standard stroke length (Ø 10 mm: 15, 30 and 45 mm; Ø 12 mm: 20, 30, 45 and 60 mm)

Rohne



Actuators

# Precision linear slide tables

M/261100/M

Double acting

Ø 10 and 12 mm

Dimensions in mm

M/26111\*/R1/IP/\*\* Standard slide tables (Ø 10 and 12 mm)

M/26111\*/R1/SP/\*\* Symmetric slide tables (Ø 10 and 12 mm)

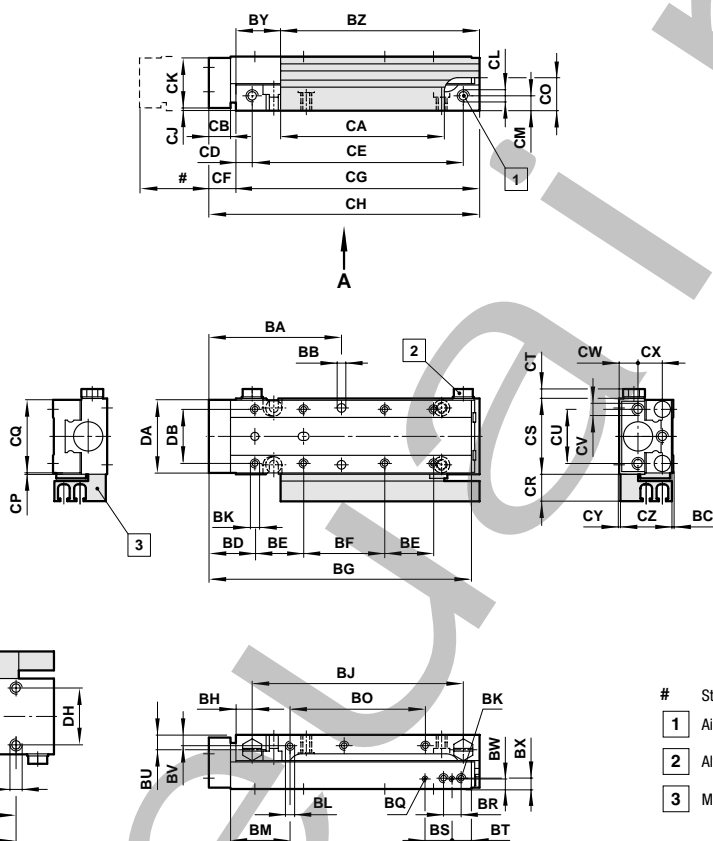

Model	Ø	ØBB	BC	BD	BH	BK	BL	BM	BQ	BR	BS	BT	BU			
M/261110/R1/P/**	10	3.2	0.5	17	6	M3 x 3 deep	M3 x 5 deep	20	M2 x 3 deep	6.5	10	7.2	5.5			
M/261112/R1/P/**	12	4	1	20	6	M3 x 4 deep	M3 x 5 deep	23	M2 x 3 deep	6.5	10	8.1	5.5			
Model	Ø	BV	BW	BX	BY	CB	CD	CF	CJ	CK	CL	CM	CO	CP	CQ	CR
M/261110/R1/P/**	10	4	3.7	4	16.5	8	6	10	1	18.5	M5	5.5	12.2	0.5 ±0.025	27±0.2	10
M/261112/R1/P/**	12	5.5	4.2	4.5	18.5	8	6	10	1	20.5	M5	5.5	13.7	0.5 ±0.025	32±0.2	10
Model	Ø	CS	CT	CU	CV	CW	CX	CY	CZ	DA	DB	DC	DE	DH		
M/261110/R1/P/**	10	28±0.2	3.5	20	M4 x 8 deep	7	9	0.5	19	27	21	3.3	24	21		
M/261112/R1/P/**	12	33±0.2	3.5	24	M4 x 8 deep	8	9	2	19	32	25	4.4	25	24		

Model	Stroke	BA	BE	BF	BG	BJ	BO	BZ	CA	CE	CG	CH	DF	DG	kg	kg (Magnet)
M/261110/R1/P/15	15	39	18	-	67	48	20	43.5	30.5	48	60	70	20	32	0.230	0.015
M/261110/R1/P/30	30	44	18	15	82	63	35	58.5	45.5	63	75	85	35	47	0.270	0.020
M/261110/R1/P/45	45	49	18	30	97	78	50	73.5	60.5	78	90	100	50	62	0.320	0.025
M/261112/R1/P/20	20	45	20	-	75	54	20	47.5	34.5	54	66	76	20	36	0.320	0.017
M/261112/R1/P/30	30	53	25	-	85	64	30	57.5	44.5	64	76	86	30	46	0.370	0.020
M/261112/R1/P/45	45	53	25	15	100	79	45	72.5	59.5	79	91	101	45	61	0.425	0.025
M/261112/R1/P/60	60	53	25	30	115	94	60	87.5	74.5	94	106	116	60	76	0.495	0.030

Note: drawing shows standard model. For symmetric model see data sheet page no. 2.3.003.09

# Precision linear slide tables

M/261100/M

Double acting

Ø 10 and 12 mm

Dimensions in mm

- M/26111\*/R3\*/P/\*\* Standard precision linear slide table with push and pull side stroke adjustment. metal stops
- M/26111\*/R6\*/P/\*\* Standard precision linear slide table with push and pull side stroke adjustment. rubber stops
- M/26111\*/R7\*/P/\*\* Standard precision linear slide table with push side stroke adjustment. metal stop
- M/26111\*/R5\*/P/\*\* Standard precision linear slide table with push side stroke adjustment. rubber stop

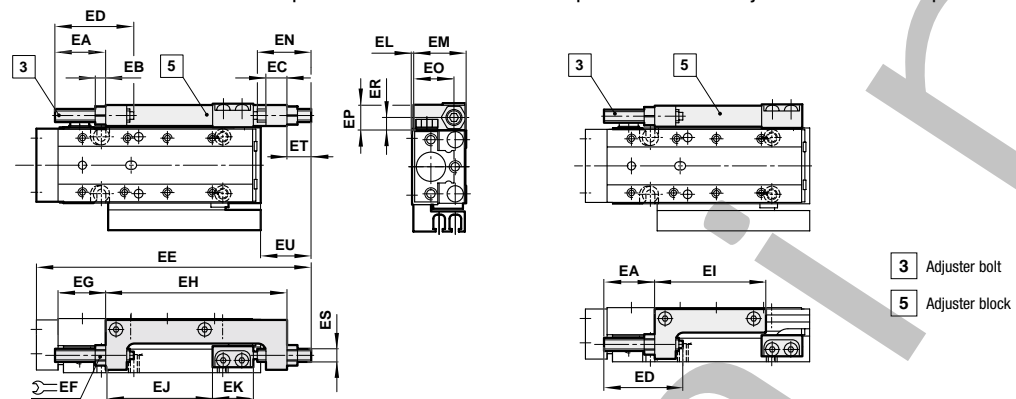

Model	EA	EB	EC	ED	EF	EG	EK	EL	EM	EN	EO	EP	ER	ES	ET	EU
M/261110*/R*/P/**	max. 19.3	4	8	30	7	16.5	15.5	0.5	19	22	13.5	8	4	M5	max. 9.2	19.7
M/261112*/R*/P/**	max. 19.8	5	7.5	30	8	19	15.5	0.5	21	22	15.5	10	5	M6	max. 9.7	20.7

Model	Stroke	EE	EH	EI	EJ	kg Slide table	kg Push side stroke adjuster Basic model +	kg Push and pull side stroke adjuster Basic model +
M/261110*/R*/P/15	15	max. 89.7	54	27	25.7	0.230	0.035	0.055
M/261110*/R*/P/30	30	max. 104.7	69	42	40.7	0.270	0.045	0.065
M/261110*/R*/P/45	45	max. 119.7	84	57	55.7	0.320	0.055	0.075
M/261112*/R*/P/20	20	max. 96.7	58	28	30.2	0.320	0.045	0.080
M/261112*/R*/P/30	30	max. 106.7	68	38	40.2	0.370	0.055	0.090
M/261112*/R*/P/45	45	max. 121.7	83	53	55.2	0.425	0.070	0.105
M/261112*/R*/P/60	60	max. 136.7	98	68	70.2	0.495	0.085	0.120

- M/26111\*/R4\*/P/\*\* Standard precision linear slide table with push and pull side stroke adjustment, shock absorbers
- M/26111\*/R8\*/P/\*\* Standard precision linear slide table with push side stroke adjustment, shock absorber

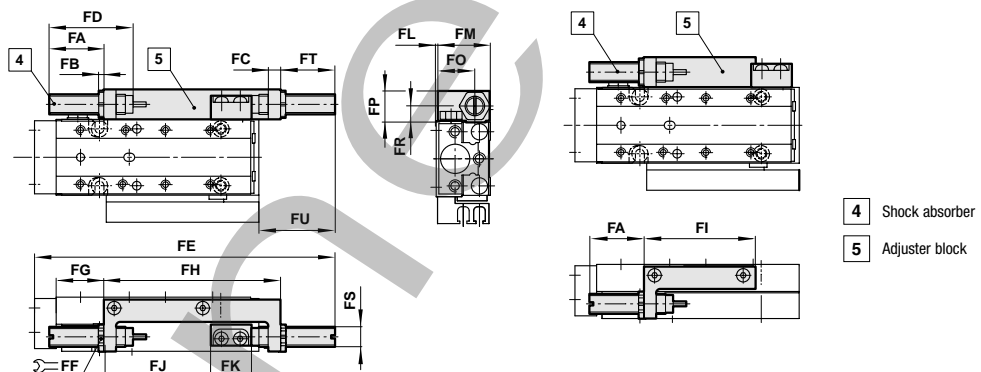

Model	FA	FB	FC	FD	FF	FG	FK	FL	FM	FO	FP	FR	FS	FT	FU
M/261110*/R4*/P/**	max. 21.3	2	4.2	32	11	16.5	15.5	0.5	19	13	12	6	M8	max. 18.2	max. 29.7
M/261112*/R4*/P/**	max. 20.8	2	4.7	32	11	18	15.5	0.5	21	15	12	6	M8	max. 18.7	max. 30.7

Model	Stroke	FE	FH	FI	FJ	kg Slide table	kg Push side stroke adjuster Basic model +	kg Push and pull side stroke adjuster Basic model +
M/261110*/R4*/P/15	15	max. 99.7	55	max. 27	25.7	0.230	0.045	0.075
M/261110*/R4*/P/30	30	max. 114.7	70	max. 42	40.7	0.270	0.055	0.085
M/261110*/R4*/P/45	45	max. 129.7	85	max. 57	55.7	0.320	0.065	0.095
M/261112*/R4*/P/20	20	max. 106.7	60	max. 29	31.2	0.320	0.055	0.095
M/261112*/R4*/P/30	30	max. 116.7	70	max. 39	41.2	0.370	0.065	0.105
M/261112*/R4*/P/45	45	max. 131.7	85	max. 54	56.2	0.425	0.075	0.115
M/261112*/R4*/P/60	60	max. 146.7	100	max. 69	71.2	0.495	0.090	0.130

Actuators

# Low profile linear slide tables

M/261200/M

Double acting

Ø 8 to 20 mm

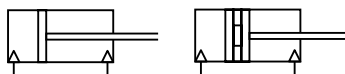

Slim but robust construction make these units ideal for moving relatively heavy loads within a confined space

Light weight

Magnetic switching for positional feedback

Excellent service life

## Technical data

Medium:

Compressed air, filtered, lubricated or non-lubricated

Operation:

Double acting with linear guide

Operating pressure:

2 to 7 bar

Operating temperature:

+5°C to +60°C

Consult our Technical Service for use below +2°C

Cylinder diameters:

8, 10, 15, 20 mm

Strokes:

30, 45, 60 mm (Ø 8 & 10 mm)

30, 45, 60, 80, 100 mm (Ø 15 & 20 mm)

Speed:

300 mm/s maximum

Materials

Slide table, body and end plates: aluminum alloy

Piston rod: stainless steel

Linear guide: stainless steel

Stroke adjustment bolts and nuts: nickel plated carbon steel

Elastomers: synthetic rubber

## Standard models

Ø	Port size	Model (Magnetic) Stroke adjustment (rubber stops)
8	M5	M/261208/MR/I/**
10	M5	M/261210/MR/I/**
15	M5	M/261215/MR/I/**
20	M5	M/261220/MR/I/**

\* Insert stroke length in mm.

## Standard strokes

Ø	30	45	60	80	100
8	●	●	●		
10	●	●	●		
15	●	●	●	●	●
20	●	●	●	●	●

## Options selector

M/2612\*\*\*/\*R/\*/\*

Piston diameter (mm)	Substitute
8	08
10	10
15	15
20	20

Piston type	Substitute
Magnetic	M
Non-magnetic	I

Standard stroke length (mm)
30, 45 & 60 mm (Ø 8 & 10 mm)
30, 45, 60, 80 & 100 mm (Ø 15 & 20 mm)

Location of switch rail and stroke adjusters	Substitute
Standard	I
Symmetric	S

## Switches with LED indication

Reed In-line cable	Reed 90° cable	Solid state In-line cable	Solid state 90° cable
M/369/LSU/1	M/370/LSU/1	M/418/EAU/1	M/419/EAU/1
M/369/LSU/3	M/370/LSU/3	M/418/EAU/3	M/419/EAU/3
		M/420/EAN/1	M/421/EAN/1
		M/420/EAN/3	M/421/EAN/3

ACT-136

# Low profile linear slide tables

M/261200/M

Double acting

Ø 8 to 20 mm

Dimensions in mm

- M/2612\*\*/\*R/I/\*\* Standard slide tables (Ø 8 & 10 mm)
- M/2612\*\*/\*R/S/\*\* Symmetric slide tables (Ø 8 & 10 mm)

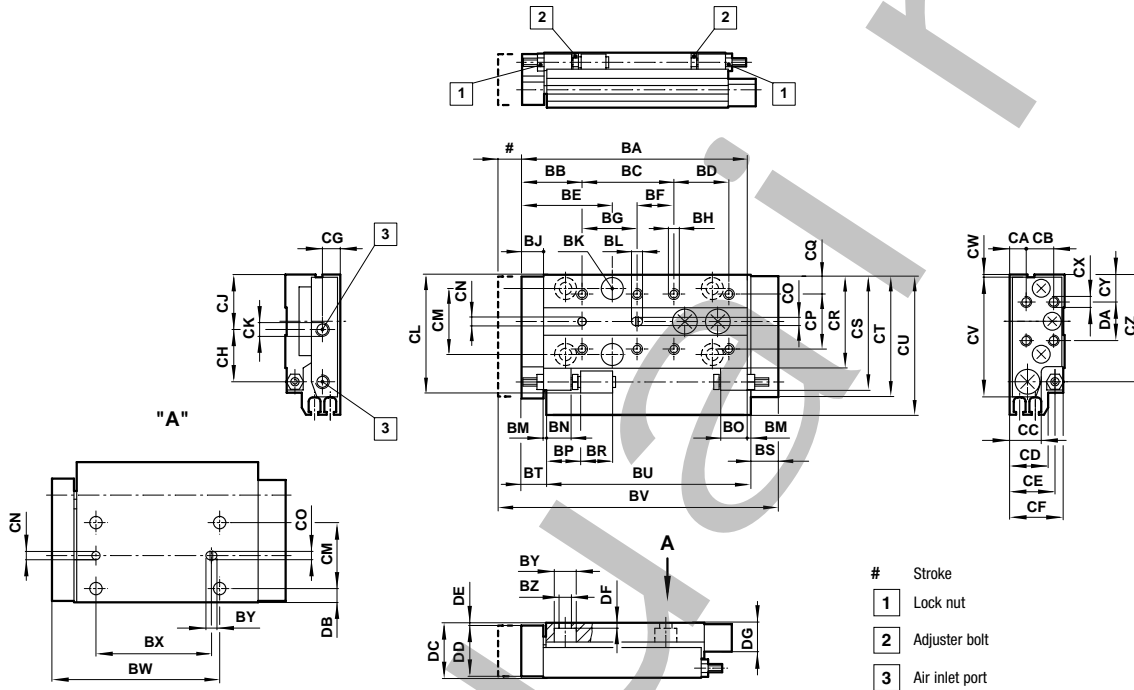

Model	Ø	BB	BD	BH	BJ	Ø BK	BL	BM	BN	BO	BP	BR	BS	BT	ØBY	BZ
M/261208/*R/*/**	8	22	20	M4 x 4 deep	8	8	4	1	9	10	12.5	9	10	9	8	4.5
M/261210/*R/*/**	10	26	25	M4 x 4 deep	10	8	4	1	9	10	14	14	10	11	8	4.5
Model	Ø	CA	CB	CC	CD	CE	CF	CG	CH	CJ	CK	CL	CM	ØCN H9	ØCO H9	CP
M/261208/*R/*/**	8	6	10	11.5	14	16.5	19.5	6.5	19	20	M5	43	24	3 x 3 deep	3 x 3 deep	20
M/261210/*R/*/**	10	6	12	12.5	15	18.5	22.5	7	20	27	M5	52	30	3 x 3 deep	3 x 3 deep	25
Model	Ø	CR	CS	CT	CU	CV	CX	CY	CZ	DA	DB	DC	DD	DE	DF	DG
M/261208/*R/*/**	8	34	42	44.5	51	44	M4 x 6 deep	10	39	14	5	20	18.5	1	2	10.5
M/261210/*R/*/**	10	40	51	53.5	60.5	53	M4 x 8 deep	12	47	16	5	23	21.5	1	4	11.5

Model	Ø	Stroke	BA	BC	BE	BF	BG	BU	BV	BW	BX	CW	kg	kg (Magnet)
M/261208/*R/*/30	8	30	74	25	33	-	-	66	85	61	42	0.5	0.196	0.002
M/261208/*R/*/45	8	45	89	40	33	20	20	81	100	76	57	0.5	0.231	0.002
M/261208/*R/*/60	8	60	89	40	33	35	20	96	115	91	72	0.5	0.266	0.002
M/261210/*R/*/30	10	30	84	25	38	-	-	74	95	69	44	0.5	0.390	0.003
M/261210/*R/*/45	10	45	99	40	38	15	25	89	110	84	59	0.5	0.405	0.003
M/261210/*R/*/60	10	60	114	55	38	30	25	104	125	99	74	0.5	0.420	0.003

Actuators

# Low profile linear slide tables

M/261200/M

Double acting

Ø 8 to 20 mm

Dimensions in mm

M/2612\*\*/\*R/I/\*\* Standard slide tables (Ø 15 & 20 mm)

M/2612\*\*/\*R/S/\*\* Symmetric slide tables (Ø 15 & 20 mm)

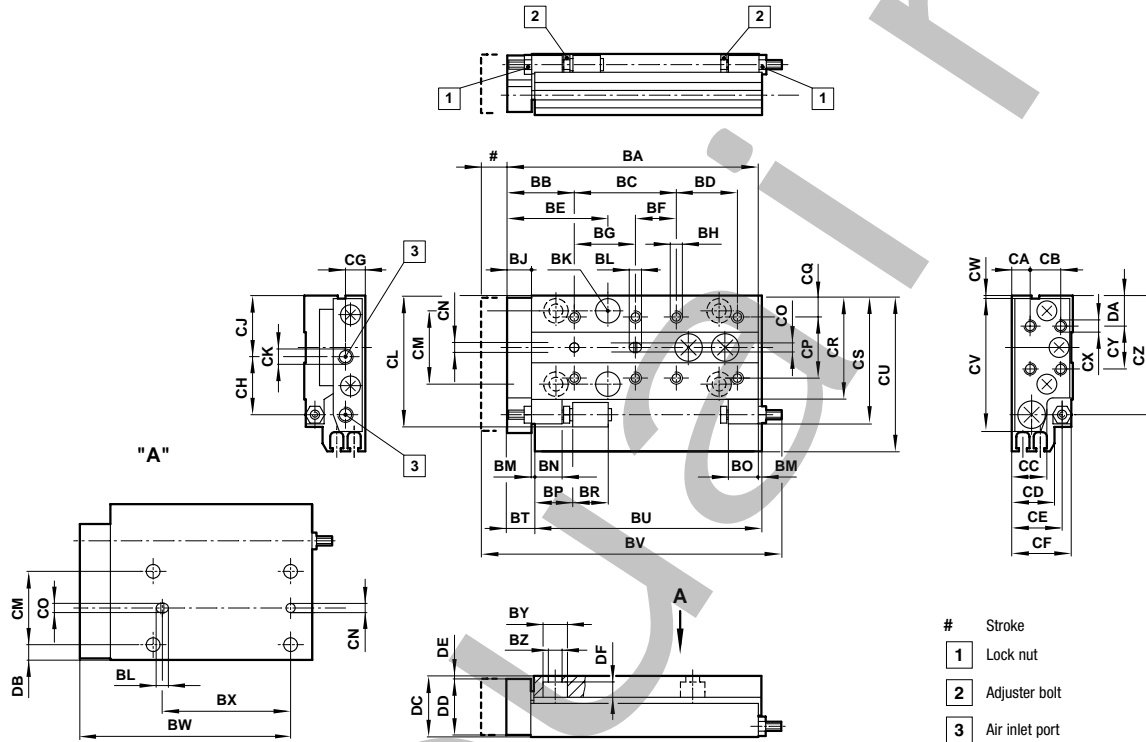

Model	Ø	BB	BD	BH	BJ	Ø BK	BL	BM	BN	BO	BP	BR	BS	BT	ØBY	ØBZ
M/261215/*R/*/**	15	26	35	M5 x 6 deep	12	10	5	1	13	14	18.5	14	12	13	10	5.5
M/261220/*R/*/**	20	26	40	M6 x 10 deep	14	13	7	1	19	20	25.5	14	-	15	13	6.5
Model	Ø	CA	CB	CC	CD	CE	CF	CG	CH	CJ	CK	CL	CM	ØCN H9	ØCO H9	CP
M/261215/*R/*/**	15	8	15	18	20	25	29.5	6.5	52	6	M5	64.5	36	4 x 4 deep	4 x 4 deep	35
M/261220/*R/*/**	20	9	20	20.5	25	32	37.5	6.5	77	8	M5	94	58	6 x 5 deep	6 x 5 deep	60
Model	Ø	CR	CS	CT	CU	CV	CX	CY	CZ	DA	DB	DC	DD	DE	DF	DG
M/261215/*R/*/**	15	50	63	-	75.5	68	M5 x 10 deep	20	58	15	7	30	28.5	1	6.5	
M/261220/*R/*/**	20	74	91	-	104	95	M6 x 12 deep	30	85	22	8	38	36.5	1	5	

Model	Ø	Stroke	BA	BC	BE	BF	BG	BU	BV	BW	BX	CW	kg	kg (Magnet)
M/261215/*R*/30	15	30	95	25	41	-	-	83	105	77	43	0.5	0.857	0.006
M/261215/*R*/45	15	45	110	40	45	-	-	98	120	92	58	0.5	0.880	0.006
M/261215/*R*/60	15	60	125	55	45	20	35	113	135	107	73	0.5	0.903	0.006
M/261215/*R*/80	15	80	145	75	45	40	35	133	155	127	93	0.5	0.933	0.006
M/261215/*R*/100	15	100	165	95	45	60	35	153	175	147	113	0.5	0.963	0.006
M/261220/*R*/30	20	30	111	35	46.5	-	-	97	124.5	90	65	0.5	1.230	0.007
M/261220/*R*/45	20	45	126	50	52.5	-	-	112	139.5	105	80	0.5	1.378	0.007
M/261220/*R*/60	20	60	141	65	52.5	25	40	127	154.5	120	95	0.5	1.533	0.007
M/261220/*R*/80	20	80	161	85	52.5	45	40	147	174.5	140	115	0.5	1.736	0.007
M/261220/*R*/100	20	100	181	105	52.5	65	40	167	194.5	160	135	0.5	1.939	0.007

Actuators

# Compact linear slide tables

M/261300/M

Double acting

Ø 10 & 16 mm



Short, smooth, low friction movement within a set envelope make these units ideal for many applications such as clamping and positioning

Light weight

Magnetic switching for positional feedback

Excellent service life

## Technical data

Medium:

Compressed air, filtered, lubricated or non-lubricated

Operation:

Double acting compact slide table with external guide

Operating pressure:

1 to 7 bar

Operating temperature:

+5°C to +60°C

Consult our Technical Service for use below +2°C

Cylinder diameters:

10 & 16 mm

Strokes:

10, 20, 30 mm

Speed:

400 mm/s maximum (10 or 20 mm stroke)

350 mm/s maximum (30 mm stroke)

Materials

Body: aluminum

Slide table: aluminium (stoppers: nickel plated hardened steel; dust seals: nitrile rubber;

Allen bolts: nickel plated steel)

Stroke adjustment bolts (rubber stop):

stainless steel, rubber Stroke adjustment bolt

nuts: nickel plated carbon steel

End covers: synthetic resin

End cover circlips: nickel plated steel

Shock absorbers: nickel plated copper alloy

(Ø 16 mm nickel plated carbon steel)

Elastomers: synthetic rubber



## Standard models

Ø	Port size	Model (Magnetic Stroke adjustment (rubber stops))	Service kit
10	M5	M/261310/MR6/IP/**	QM/261310/00
16	M5	M/261316/MR6/IP/**	QM/261316/00

\* Insert stroke length in mm.

## Standard strokes

Ø	10	20	30
10	●	●	●
16	●	●	●

## Options selector

M/2613\*\*\*/\*\*R\*/IP/\*\*

Piston diameter (mm)	Substitute	Stroke lengths (mm)	Substitute
10	10	10	10
16	16	20	20
		30	30
Type	Substitute	Stroke adjustment	Substitute
Magnetic	M	In and outstroke adjustment, rubber stops	6
Non-magnetic	I	In and outstroke adjustment, shock absorbers	9

## Switches with LED indication

Reed In-line cable	Reed 90° cable	Solid state In-line cable	Solid state 90° cable
M/369/LSU/1	M/370/LSU/1	M/418/EAU/1	M/419/EAU/1
M/369/LSU/3	M/370/LSU/3	M/418/EAU/3	M/419/EAU/3
		M/420/EAN/1	M/421/EAN/1
		M/420/EAN/3	M/421/EAN/3

## Accessories

Model	Ø (mm)	Stroke adjustment bolt (rubber stop)	Shock absorber	Magnet	Switch rail 10 mm stroke	20 mm stroke	30 mm stroke
M/261310/**R*/IP/**	10	M/P73425/8	M/P73454/1	M/P73431/1	M/P73427/3	M/P73427/4	M/P73427/5
M/261316/**R*/IP/**	16	M/P73425/9	M/P73454/2	M/P73431/1	M/P73427/6	M/P73427/7	M/P73427/8

ACT-140



www.norgren.com/info/US-ACT-140

# Compact linear slide tables

M/261300/M  
Double acting  
Ø 10 & 16 mm  
Dimensions in mm

M/2613\*\*/\*R\*/IP/\*\* Standard slide tables (Ø 10 & 16 mm)

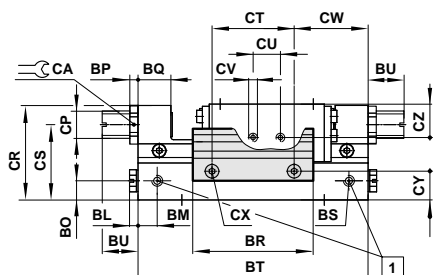

- # Stroke
- 1 Air ports (side ported)
- 2 Alternative ports
- 3 Magnetic version

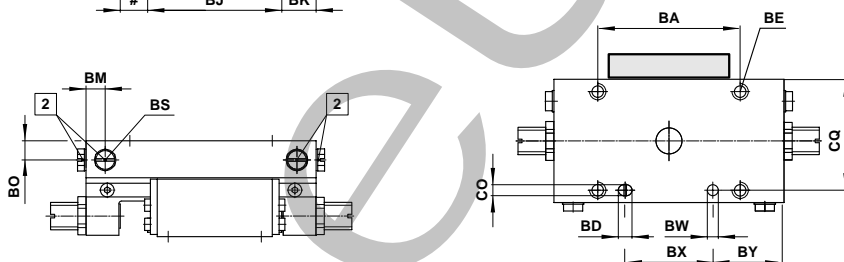
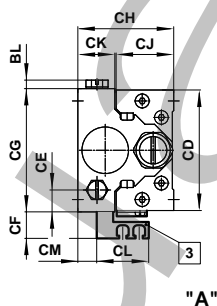
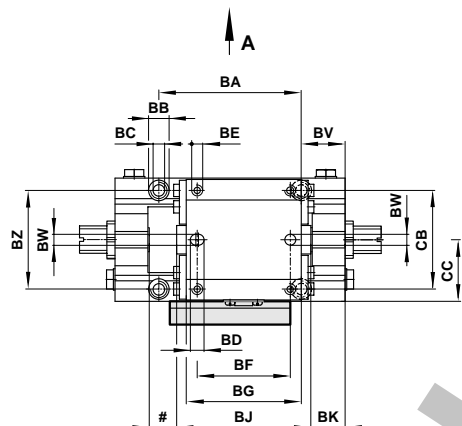

Model	Ø	Ø BB	Ø BC	BD	BE	BK	BL	BM	BO	BP	BQ	BS		
M/261310/*R*/IP/**	10	6 x 3.5 deep	3.3	4	M4 x 6 deep	10.5	3.1	6.5	5.5	2	10	M5		
M/261316/*R*/IP/**	16	7.5 x 4.5 deep	4.3	5	M5 x 9 deep	12.5	3.1	7	7	3	12	M5		
Model	Ø	BU	BW	BZ	CA	CB	CC	CD	CE	CF	CG	CH	CJ	CK
M/261310/*R*/IP/**	10	max. 9.5	3 x 3 deep	26	11	25	16.5	33 ±0.2	7	8.5	34 ±0.2	28	18	9.5
M/261316/*R*/IP/**	16	max. 9.5	4	36	13	36	22	44 ±0.2	8	8.5	45 ±0.2	35	21	13.5
Model	Ø	CL	CM	CO	CP	CQ	CR	CS	CU	CV	CX	CY	CZ	
M/261310/*R*/IP/**	10	19	3	3*	M8	30 ±0.1	27.5	21.5	10	M2	M3	6.5	9.2	
M/261316/*R*/IP/**	16	19	7	4*	M10 x 1	40.5 ±0.1	34.5	27.5	10	M2	M3	10.5	12.2	

\* +0.06 +0.012

Model	Ø	Stroke	BA	BF	BG	BJ	BR	BT	BX	BY	CT	CW	kg	kg (Magnet)
M/261310/*R*/IP/10	10	10	44	26	35	41	44	72	24	24	30	21	0.16	0.02
M/261310/*R*/IP/20	10	20	68	40	49	55	54	96	48	24	40	28	0.21	0.02
M/261310/*R*/IP/30	10	30	96	60	68	74	64	125	76	24.5	50	37.5	0.27	0.03
M/261316/*R*/IP/10	16	10	52	34	42	49	44	84	32	26	30	27	0.28	0.02
M/261316/*R*/IP/20	16	20	72	44	52	59	54	104	52	26	40	32	0.34	0.02
M/261316/*R*/IP/30	16	30	100	62	70	77	64	132	80	26	50	41	0.41	0.03

Actuators

## Compact linear slide tables

M/261300/M

Double acting

Ø 10 & 16 mm

Dimensions in mm

M/2613\*\*/\*R9/IP/\*\* Slide table with shock absorbers (Ø 10 & 16 mm)

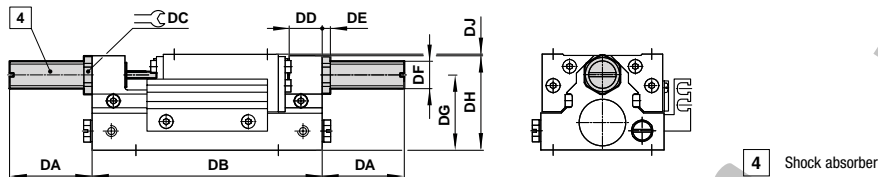

	Ø	DA	DC	DD	DE	DF	DG	DH	DJ
M/261310/*R9/IP/**	10	max. 21.5	11	10	2	M8	21.5	27.5	-
M/261316/*R9/IP/**	16	max. 37.5	13	12	3	M10	27.5	34.5	0.1

Model	Ø	Stroke	DB	kg	kg (Magnet)
M/261310/*R9/IP/10	10	10	72	0.17	0.02
M/261310/*R9/IP/20	10	20	96	0.22	0.02
M/261310/*R9/IP/30	10	30	125	0.28	0.03
M/261316/*R9/IP/10	16	10	84	0.32	0.02
M/261316/*R9/IP/20	16	20	104	0.39	0.02
M/261316/*R9/IP/30	16	30	132	0.45	0.03

ACT-142



Actuators

# Synchronous linear slide tables

M/261400/M

Double acting  
Ø 6 mm

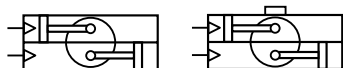

Precise synchronous slide table movement makes these units ideal for use as escapements or grippers

Compact envelope dimensions

High cycle rate – 120 cycles/minute

Light weight

Magnetic switching for positional feedback

Excellent service life

### Technical data

Medium:

Compressed air, filtered, lubricated or non-lubricated

Operation:

Double acting with synchronous slide table movement

Operating pressure:  
3 to 7 bar

Operating temperature:  
+5°C to +60°C

Consult our Technical Service for use below +2°C

Cylinder diameters:  
6 mm

Strokes:  
5, 10 mm

Speed:  
120 cycles/minute maximum

### Materials

Slide tables: stainless steel

Guide rail: stainless steel

Side plates: nickel plated aluminum alloy and nickel plated steel

Piston rods: nickel plated aluminum alloy

Hexagon socket bolts: nickel plated steel

Stroke adjustment bolts: nickel plated steel

Stroke adjustment bolts with rubber stops: stainless steel and urethane rubber

Locknuts: nickel plated steel

Elastomers: nitrile rubber



### Standard models

Ø	Port size	Model (Magnetic)	Service kit
6	M3	M/261406/MR1/I/**	QM/261406/00

\* Insert stroke length in mm.

### Standard strokes

Ø	5	10
6	●	●

### Options selector

M/261406/★R★/★/★

Type	Substitute	Standard stroke lengths
Magnetic	M	5 and 10 mm
Non-magnetic	I	
Stroke adjustment	Substitute	Location of switch rail and stroke adjusters
No stroke adjustment	1	Standard (right side of ports)
Stroke adjustment, metal stops	3	Alternative (left side of ports)
Stroke adjustment, rubber stops	6	

### Switches with LED indication

Reed In-line cable	Reed 90° cable	Solid state In-line cable	Solid state 90° cable
M/369/LSU/1	M/370/LSU/1	M/418/EAU/1	M/419/EAU/1
M/369/LSU/3	M/370/LSU/3	M/418/EAU/3	M/419/EAU/3
		M/420/EAN/1	M/421/EAN/1
		M/420/EAN/3	M/421/EAN/3

### Mountings and accessories

Stroke	Stroke adjustment bolt (metal stop) and nut	Stroke adjustment bolt (rubber stop) and nut	Mounting bracket with fixing bolts	Magnet (with fixing screws)	Switch rail
5					
10	M/P73424/1	M/P73425/1	QM/261406/5/22	M/P73431	M/P73427/1
	M/P73424/1	M/P73425/1	QM/261406/10/22	M/P73431	M/P73427/1

ACT-144

# Synchronous linear slide tables

**M/261400/M**  
Double acting  
Ø 6 mm  
Dimensions in mm

M/261406/\*R1/\*/\*\*  
Standard synchronous linear slide table (Ø 6 mm)

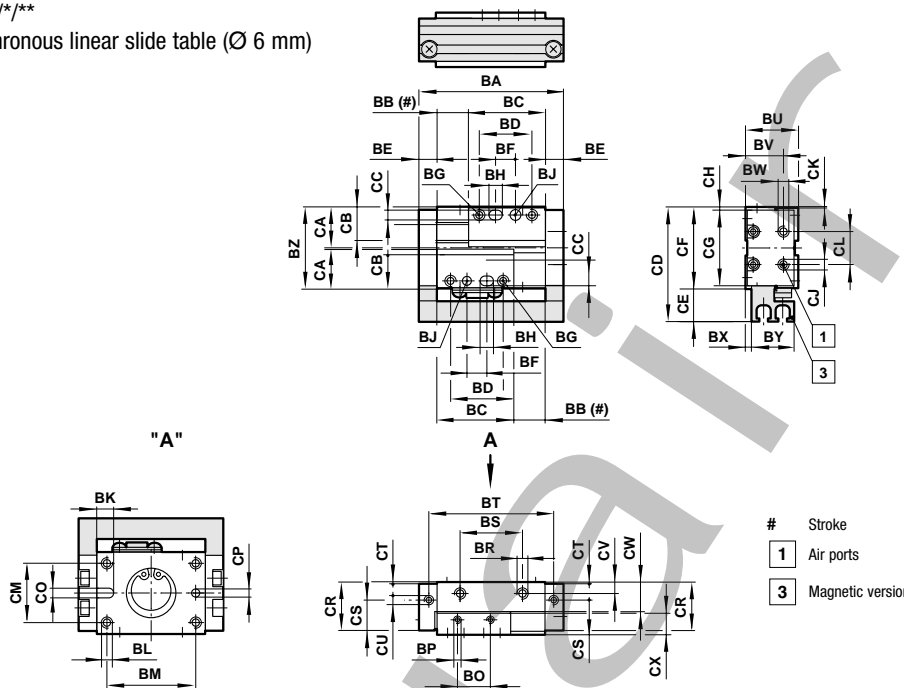

Model	Ø	BC	BD	BE	BF	BG	BH	Ø BJ	BK	BL	BO
M/261406/*R1/*/**	6	22.4 -0.1	16	5.5	6	M3 x 3 deep	4	3 x 2.5 deep	5	M3 x 3 deep	10
Model	Ø	P	BR	BU	BV	BX	BY	BZ	CA	CB	
M/261406/*R1/*/**	6	M2 x 2.5 deep	M3 x 3 deep	16 ±0.05	11.5	1.8	13	24.4 ±0.05	12	10 -0.1	
Model	Ø	CC	CD	CE	CF	CG	CH	CJ	CK	CL	CM
M/261406/*R1/*/**	6	3 x 2.5 deep	35	10	25 -0.1	23	1	M3	0.3 ±0.1	10	18
Model	Ø	CO	CP	CR	CS	CT	CU	CV	CW	CX	
M/261406/*R1/*/**	6	3 x 3 deep	Ø 3 x 3 deep	14.7	9.2	0.5	M 2.5 x 3 deep	3.5	9	6.5	
Model	Ø	Stroke	BA	BB	BM	BS	BT	kg	kg (Magnet)		
M/261406/*R1*/5	6	5	39	5 +0 -0.7	22	14	33	0.070	0.008		
M/261406/*R1*/10	6	10	44	10 +0 -0.7	27	19	38	0.075	0.008		

M/261406/\*R3/\*/\*\* Synchronous linear slide table with metal stops (Ø 6 mm)  
M/261406/\*R6/\*/\*\* Synchronous linear slide table with rubber stops (Ø 6 mm)

QM/261406\*/22 Mounting bracket

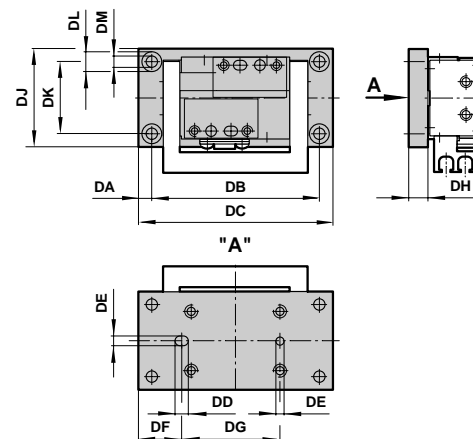
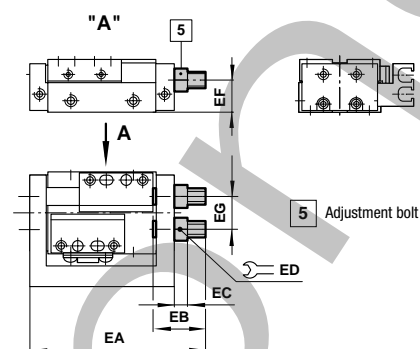

Model	Ø	EB	EC	ED	EF	EG
M/261406/*R3/*/**	6	16	4	7	10.5	10
Model	Ø	Stroke	EA max.	kg		
M/261406/*R3*/5	6	5	49.5	0.005		
M/261406/*R3*/10	6	10	54.5	0.005		

Ø	DA	DD	Ø DE +0.05	DF	DH	DJ	DK	Ø DL	DM
6	4	4	3 x 3 deep	10	6	30	22	6 x 3.2 deep	Ø 3.5
Ø	Stroke (max.)	DB	DC	kg					
6	5	46	54	0.027					
6	10	51	59	0.030					

# Linear slide tables

Norgren linear slide tables are ideal for transporting loads over short distances solving such applications as picking and placing components, fluid dispensing and product testing. They can be widely applied within many industry sectors and are ideal for OEMs, end users and automation specialists alike.

As well as the information within this section detailing individual families, the following technical data will help in ensuring the most appropriate linear slide table is chosen. Please refer to catalogue data sheets for full specification details.

## Theoretical forces

Ø	Theoretical forces (N) at 6 bar	Ø	Theoretical forces (N) at 6 bar
6	17	15	106
	10.8 (M/261400)	16	120
8	30	20	188
10	47	25	294
12	68	32	482

## Stroke adjustment range

Range	Ø	Stroke length (mm)	Metal or rubber stoppers	Shock absorber
M/261000	6	All	-5 mm both sides	-
		8	-5 mm both sides	-10 mm both sides
	10	10	-5 mm both sides	-7 mm both sides
		10	-6 mm both sides	-10 mm both sides
	12	15	-7 mm both sides	-15 mm both sides
		15	-5 mm both sides	-10 mm both sides
M/261100	10	All	-5 mm both sides	-15 mm both sides
		10	-15 mm push side	-19 mm push side
M/261200	10	All	-5 mm pull side	-16 mm pull side
		10	-15 mm push side	-18 mm push side
	16	All	-5 mm pull side	-16 mm pull side
		16	-5 mm both sides	-5 mm both sides
M/261400	6	All	-7 mm both sides	-19 mm both sides
		6	-6 mm both sides	-30 mm both sides
M/61200	All	All	-5 mm	-

## Accuracy

Standard

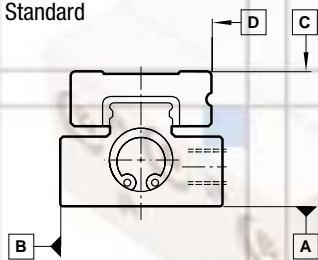

M/261000		Parallelism Plane C with respect to plane A	Parallelism Plane D with respect to plane B	Running parallelism Plane C with respect to plane A	Running parallelism Plane D with respect to plane B
Ø					
6		0.03	0.03	0.005	0.005
8		0.03	0.03	0.005	0.005
10		0.02	0.02	0.004	0.004
12		0.02	0.02	0.004	0.004
16		0.02	0.02	0.003	0.003
M/261100		Parallelism Plane C with respect to plane A	Parallelism Plane D with respect to plane B	Running parallelism Plane C with respect to plane A	Running parallelism Plane D with respect to plane B
Ø	Stroke length (mm)				
10	15	0.02	0.02	0.004	0.004
10	30	0.02	0.02	0.004	0.004
10	45	0.02	0.02	0.004	0.004
12	20	0.02	0.02	0.004	0.004
12	30	0.02	0.02	0.004	0.004
12	45	0.02	0.02	0.004	0.004
12	60	0.02	0.02	0.006	0.006

All values in mm.

## Maximum loads

Range	Ø	Stroke length (mm)	Maximum load (kg)			
			No stroke adjustment	Metal stoppers	Rubber stoppers	Shock absorber
M/261000	6	All	0.3	0.15	0.2	-
		8	0.3	0.25	0.5	1.0
	10	All	0.8	0.4	0.8	1.6
		12	1.2	0.6	1.2	2.0
	16	2.0	1.0	2.0	4.0	
M/261100	10	All	0.8	0.3	0.8	1.6
	12	All	1.2	0.5	1.2	2.0
M/261200	8	All	-	1.5	1.5	-
		10	-	2.0	2.0	-
	15	All	-	4.0	4.0	-
		20	All	-	8.0	8.0

Range	Ø	Stroke length (mm)	Maximum load (kg)			
			No stroke adjustment	Metal stoppers	Rubber stoppers	Shock absorber
M/261300	10	All	-	-	0.8*	1.6*
		16	-	-	2.0*	4.0*
M/261400	6	All	-	0.1	0.1	-
M/61200	16	All	-	-	2.0	-
		20	All	-	-	4.0
	25	All	-	-	6.0	-
	32	All	-	-	9.0	-

## Theoretical moments

Range	Ø	Stroke length (mm)	Theoretical moments (Nm)		
			Mx	My	Mz
M/261000	6	5	0.87	0.42	0.42
		6	0.87	0.42	0.42
	8	10	0.87	0.42	0.42
		20	1.8	1.7	1.7
	10	10	2.3	1.2	1.4
		20	3.3	2.8	3.1
	12	15	4.7	2.4	2.9
		25	7.3	6.5	7.7
	16	20	7.5	4.3	3.8
		30	9.6	7.5	6.6
M/26110	10	All	1.9	1.8	2.0
	12	All	3.8	3.0	3.4
M/261200	8	All	1.3	0.45	0.45
	10	All	2.1	0.79	0.88
	15	All	4.5	1.6	1.7
	20	All	13	3.6	3.4
M/261300	10	10	1.2	0.6	0.6
		20	1.4	0.9	0.9
	16	10	1.8	1.3	1.3
		20	2.8	1.4	1.4
	16	30	3.6	1.9	1.9
M/261400	6	All	0.54	0.29	0.29

Range	Ø	Stroke length (mm)	Theoretical moments (Nm)			
			Mx	My	Mz	
M/61200/M	16	All	10.0	14.0	14.0	
		20	25. 50	14.0	14.0	14.0
		75	20.0	20.0	20.0	
	25	100. 150	28.0	28.0	28.0	
		25. 50	26.0	20.0	20.0	
		75. 100. 150	52.0	40.0	40.0	
M/61200/MR	16	All	24.0	14.0	14.0	
		20	26.0	10.0	10.0	
	25	20	66.0	34.0	34.0	
32	20	120.0	48.0	48.0		

Without stroke adjuster

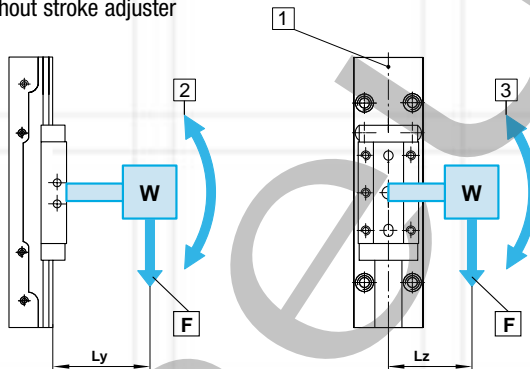

- 1 Guide centre line
- 2 Moment My
- 3 Moment Mz
- 4 Moment Mx
- 5 Stroke adjuster

$$F[N] = 9,8 \times W[kg]$$

With stroke adjuster

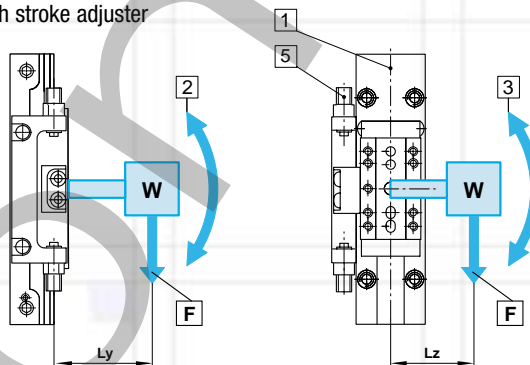

$$F[N] = 9,8 \times W[kg]$$

W(kg): mass of a loaded work  
 F(N): gravity acting on a loaded work  
 Lx, Ly, and Lz (m): distance between the centre line of the guide and the centre of gravity of the loaded work

To calculate theoretical moments use the following formula -  
 Gravity acting on load (9.8) x mass of load (kg) x distance between the centre line of the guide and the centre of gravity of the loaded work (m). Calculated values should not exceed those in the 'Theoretical moments' table.

Actuators

# Slide tables

M/61200/M, M/61200/MR

Double acting

Ø 16 to 32 mm

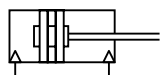

**M/61200/M:** Slide table with adjustable guide

**M/61200/MR:** Slide table with precision linear ball bearing

Stroke adjustable at each endposition

High repeatability

Compact design

### Technical data

Medium:

Compressed air, filtered, lubricated or non-lubricated

Operation:

M/61200/M Double acting with adjustable guide

M/61200/MR Double acting with precision linear ball bearing

Operating pressure:

1 to 10 bar

Operating temperature:

0°C to +80 °C

Consult our Technical Service for use below +2°C

Cylinder diameters:

16, 20, 25, 32 mm

Strokes:

25, 50, 75, 100 (Ø 16 mm)

25, 50, 75, 100, 150 (Ø 20, 25, 32 mm)

Materials

Body: anodised aluminum

Carriage: anodised aluminum

End covers: anodised aluminum

Piston rod: stainless steel (Martensitic)

Seals: nitrile rubber, polyurethane

Linear guide: stainless steel

Guide rail: plastic

Buffer: elastomer

### Standard models

Ø	Port size	Model	Adjustable guide	Precision linear ball bearings
16	M5	M/61216/M		M/61216/MR
20	M5	M/61220/M		M/61220/MR
25	M5	M/61225/M		M/61225/MR
32	G1/8	M/61230/M		M/61230/MR

\* Insert stroke length in mm.

Order optional shock absorbers separately. See page 197

Order magnetically operated switches separately, see page 199

Cylinder sizing and speed control see page 6

### Options selector

M/612\*\*\*/\*\*/\*\*\*\*

Cylinder diameters (mm)	Substitute
16	16
20	20
25	25
32	32

Stroke length in mm
150 max.

Variants	Substitute
Magnetic piston, adjustable guide	M
Magnetic piston, precision linear ball bearing	MR
Magnetic piston, adjustable cushioning, adjustable guide or linear roller bearing on request	

### Switches



	Model	Plug-in cable	Groove cover
Reed	M/50/LSU/*V M/50/LSU/CP	M/P73001/5 (5 m)	M/P72725/1000
Solid state	M/50/EAP/*V M/50/EAP/CP	M/P73001/5 (5 m)	

\*Insert cable length – 2, 5 or 10 m. For details see page 198

# Slide tables

M/61200/M, M/61200/MR

Double acting

Ø 16 to 32 mm

Dimensions in mm

M/61216/M. .../MR

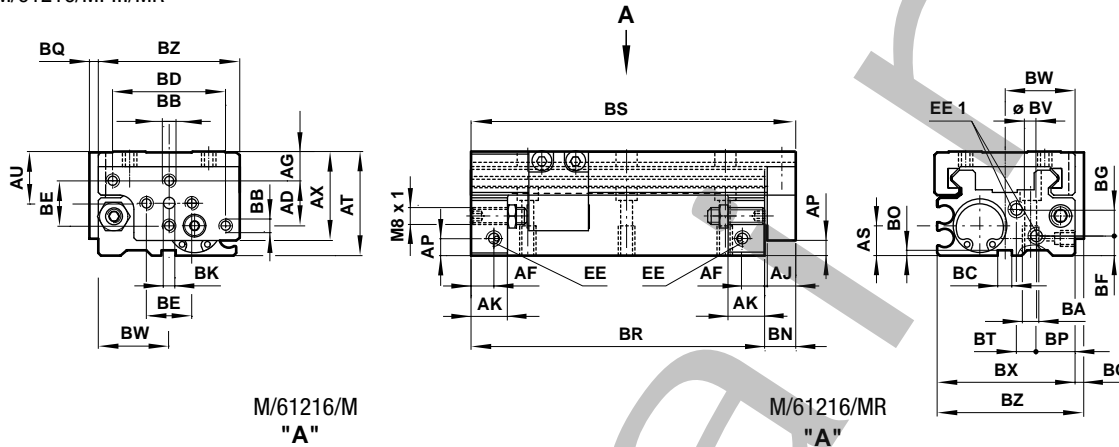

M/61216/M  
"A"

M/61216/MR  
"A"

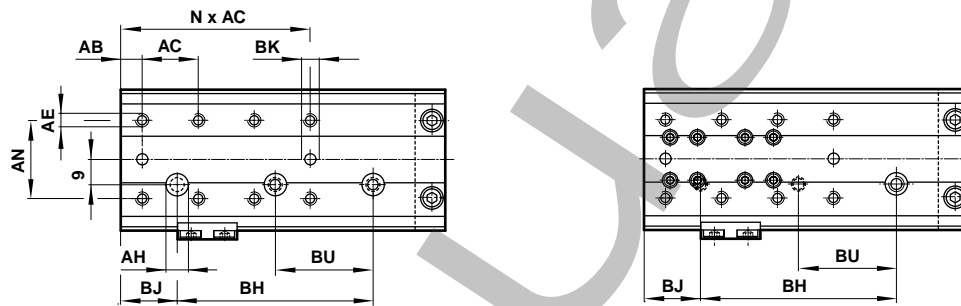

Ø	AB	AC	AD	AE	AG	Ø AH	AJ	AN	AP	AS	AT	AU	AX	BA	BB	Ø BC H7
16	7.5	20	16	M4 – 5.5 deep	10.5	8	10	28	6	10.5	37	18.5	31.5	M5 – 8 deep	M4	5
Ø	BD	BE	BF	BG	Ø BK H7	BN	BO	BP	BQ	BT	Ø BV	BW	BX	BZ	EE	EE 1
16	40	16	7	9.3	4	11	2	14	2.5	6.6	4.2	25	49	50	M5 – 5.5 deep	M5 – 7 deep

Ø 16 mm

Model	Stroke	AF	AK	BH	BJ	BR	BS	BU	N	kg
M/61216/M/25	25	8	14	40	20	81	92	–	2	0.28
M/61216/MR/25	25	8	14	40	20	81	92	–	2	0.34
M/61216/M/50	50	8	14	70	20	106	117	35	3	0.35
M/61216/MR/50	50	8	14	70	20	106	117	35	3	0.41
M/61216/M/75	75	8	14	80	20	131	142	40	4	0.45
M/61216/MR/75	75	8	14	80	20	131	142	40	4	0.54
M/61216/M/100	100	8	14	120	20	156	167	60	5	0.52
M/61216/MR/100	100	8	14	120	20	156	167	60	5	0.62

Actuators

# Slide tables

M/61200/M, M/61200/MR

Double acting

Ø 16 to 32 mm

M/61220/M, M/61225/M

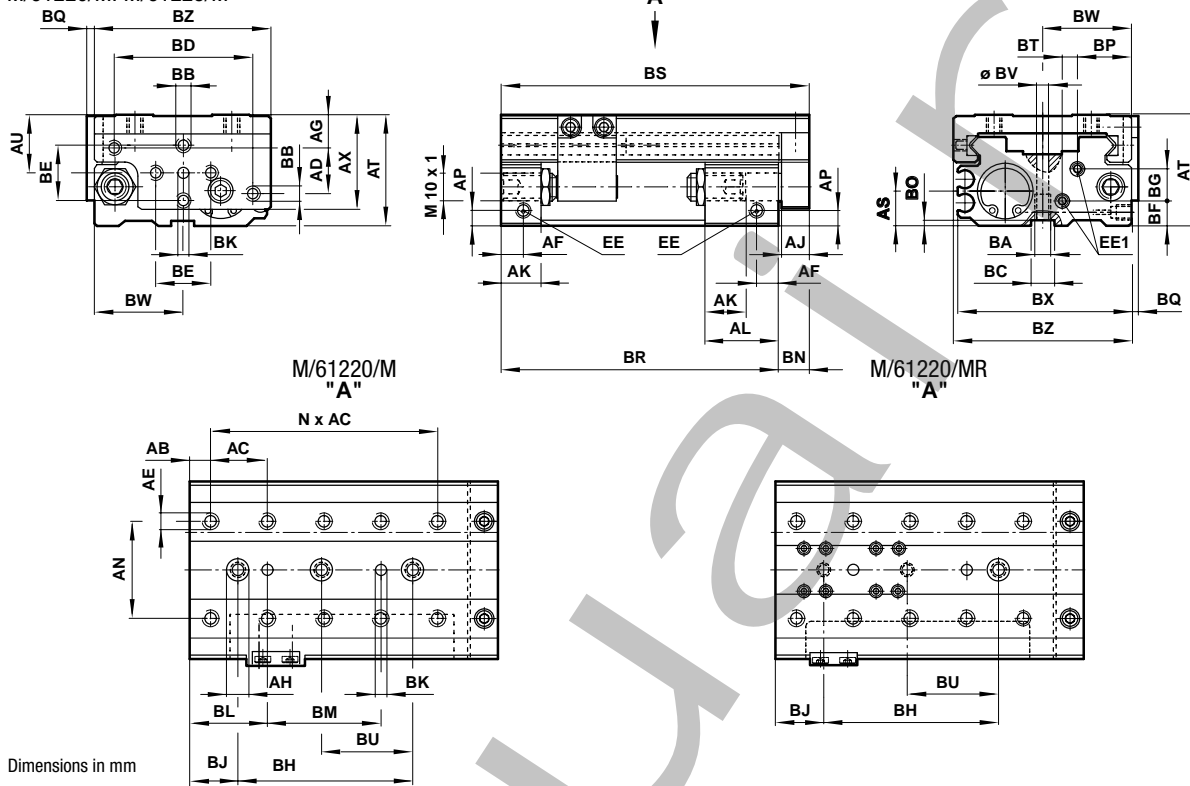

Dimensions in mm

Ø	AB	AC	AD	AE	AG	Ø AH	AJ	AN	AP	AS	AT	AU	AX	BA	BB	Ø BCH7
20	7.5	25	16.5	M5 – 6.5 deep	12	8	10	35	5.5	12.5	40	20	34	M5 – 10 deep	M5	10
25	7.5	25	20	M5 – 8.0 deep	14	9	12	40	7	15	48	24	40	M6 – 10 deep	M5	10
Ø	BD	BE	BF	BG	Ø BKH7BN	BO	BP	BQ	BT	Ø BV	BW	BX	BZ	EE	EE 1	
20	50	20	9	11.5	4	11	2	19.5	2.5	5.5	4.2	32	62.5	64	M5 – 5.5 deep	M5 – 7 deep
25	65	22	12	11.5	4	13	2	19.5	3.5	12	5.1	39.5	76.2	79	M5 – 5.5 deep	M5 – 7 deep

M/61220/M, .../MR

Model	Stroke	AF	AK	AL	BH	BJ	BL	BM	BR	BS	BU	N	kg
M/61220/M/25	25	9	13.5	13.5	25	22.5	7.5	25	75	86	–	2	0.41
M/61220/MR/25	25	9	14.5	26.5	50	22.5	7.5	50	100	111	25	2	0.50
M/61220/M/50	50	9	13.5	13.5	50	22.5	7.5	50	100	111	25	3	0.53
M/61220/MR/50	50	9	14.5	26.5	75	22.5	32.5	50	125	136	37.5	3	0.62
M/61220/M/75	75	9	14.5	14.5	100	22.5	32.5	75	145	156	50	4	0.66
M/61220/MR/75	75	9	14.5	21.5	100	22.5	32.5	75	145	156	50	4	0.79
M/61220/M/100	100	9	14.5	14.5	100	22.5	32.5	100	180	191	50	5	0.78
M/61220/MR/100	100	9	14.5	31.5	100	22.5	32.5	100	180	191	50	5	0.94
M/61220/M/150	150	9	14.5	14.5	150	22.5	32.5	100	240	251	75	5	1.03
M/61220/MR/150	150	9	14.5	41.5	150	22.5	32.5	100	240	251	75	5	1.24

M/61225/M, .../MR

Model	Stroke	AF	AK	AL	BH	BJ	BL	BM	BR	BS	BU	N	kg
M/61225/M/25	25	9.5	14.5	14.5	50	17.5	7.5	50	85	98	25	2	0.65
M/61225/MR/25	25	9.5	14.5	41.5	75	22.5	32.5	50	115	128	37.5	3	0.78
M/61225/M/50	50	9.5	14.5	14.5	75	20	32.5	50	115	128	37.5	3	0.85
M/61225/MR/50	50	9.5	14.5	41.5	100	22.5	32.5	75	140	153	50	4	0.92
M/61225/M/75	75	9.5	14.5	14.5	100	22.5	32.5	100	165	178	50	5	1.05
M/61225/MR/75	75	9.5	14.5	41.5	100	22.5	32.5	100	165	178	50	5	1.26
M/61225/M/100	100	9.5	14.5	14.5	150	22.5	32.5	125	190	203	75	6	1.20
M/61225/MR/100	100	9.5	14.5	41.5	150	22.5	32.5	125	190	203	75	6	1.20
M/61225/M/150	150	9.5	14.5	14.5	150	22.5	32.5	125	240	253	75	6	1.60
M/61225/MR/150	150	9.5	14.5	41.5	150	22.5	32.5	125	240	253	75	6	1.60

ACT-150

# Slide tables

M/61200/M, M/61200/MR

Double acting

Ø 16 to 32 mm

Dimensions in mm

M/61232/M.../MR

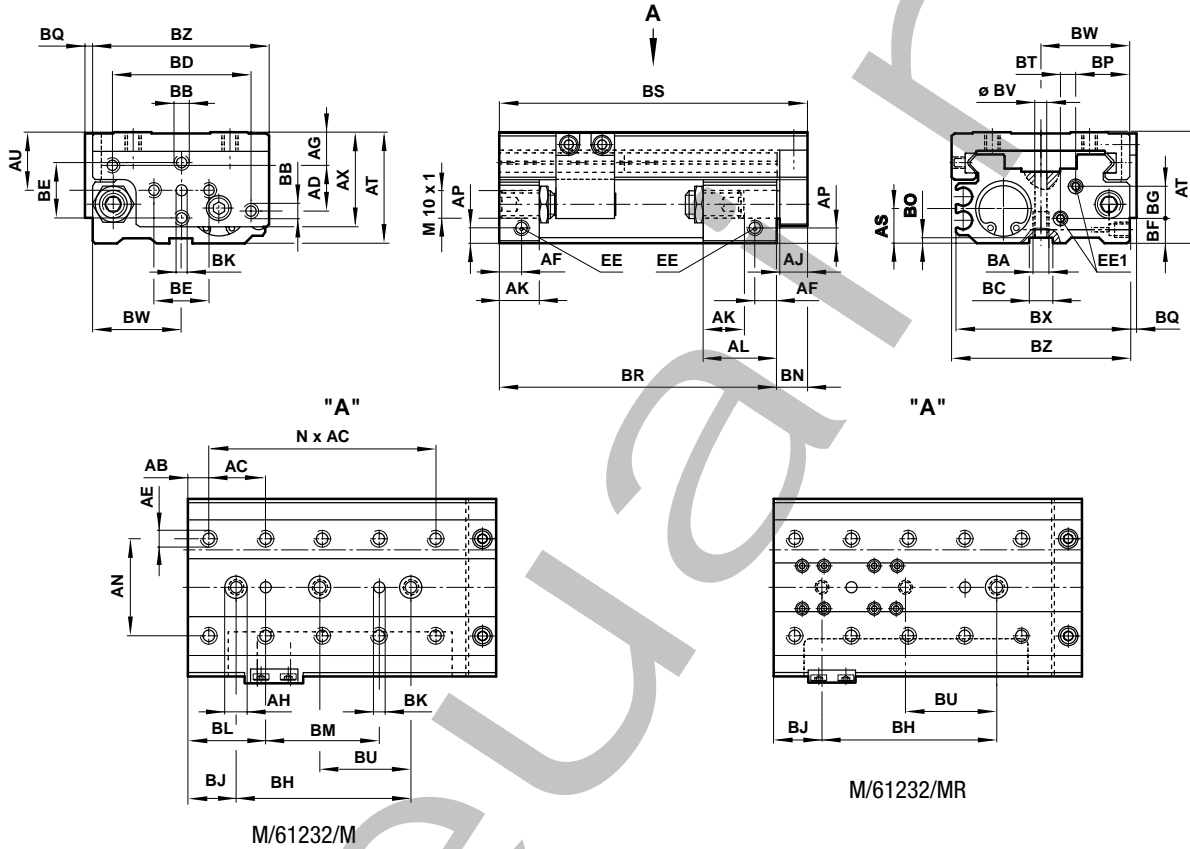

Ø	AB	AC	AD	AE	AG	ØAH	AH	AN	AP	AS	AT	AU	AX	BA	BB	Ø BCH
32	7.5	30	26	M6 – 8.5 deep	15	11	12	50	10	19	57	28	48	M8 – 14 deep	M6	10
Ø	BD	BE	BF	BG	Ø BKH7	BN	BO	BP	BQ	BT	ØBV	BW	BX	BZ	EE	EE 1
32	75	25	17.5	13.5	5	13	2	24.5	3.5	12	6.6	46	90.5	92	G1/8-10 deep	G1/8-10 deep

Model	Stroke	AF	AK	AL	BH	BJ	BL	BM	BR	BS	BU	N	kg
M/61232/M/25	25	8	16	16	50	20	7.5	50	90	103	25	2	1.00
M/61232/MR/25	25	8	19	43	75	22.5	37.5	50	120	133	37.5	3	1.20
M/61232/M/50	50	11	19	43	90	30	40	60	145	158	45	3	1.32
M/61232/MR/50	50	11	19	43	90	30	37.5	60	145	158	45	3	1.70
M/61232/M/75	75	11	19	43	120	30	40	90	170	183	50	4	1.63
M/61232/MR/75	75	11	19	43	120	30	37.5	90	170	183	50	4	1.96
M/61232/M/100	100	11	19	43	130	30	40	100	195	208	60	5	1.86
M/61232/MR/100	100	11	19	43	130	30	37.5	100	195	208	60	5	2.23
M/61232/M/150	150	11	19	43	150	30	40	120	245	258	75	5	2.48
M/61232/MR/150	150	11	19	43	150	30	37.5	120	245	258	75	5	2.98