



Air Prep



70 Series

Stainless Steel FRL Series

We're everywhere you need us to be!



70 and 71 Series

Features and Benefits	3-11
Particulate Filter	3
Coalescing Filter	4
Regulator	5
Particulate Filter/Regulator	6
Lubricator	7
Miniature Filters	8
Miniature Regulator	9
Miniature Particulate Filter/Regulator	10
Replacement and Repair Kits	10
	11

Pneumatics



70 and 71 Series Stainless Steel Series

- 2 Series Available – High Flow and Miniature
- 316 Stainless Steel Construction
- All Viton Seals
- 5 Micron Particulate
- 4 Grades Coalescing
- Exceeds NACE Specifications
- High Flow in a Compact Size



70 and 71 Series
Stainless Steel FRL Series

Stainless Steel Particulate Filter
F70B Series

- 316 Stainless Steel Body Construction
- All Seals Made of Viton®
- 5 Micron Element Standard
- Meets NACE Specifications

Specifications

Temperature Range °F (°C): 40°-180° (4°-82°)
 Max. Operating Pressure PSIG (BAR): 300 (20)
 Weight, lbs. (kg.): 1.88 (.85)
 Element: Sintered Polypropylene

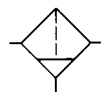

ANSI SYMBOL



Flow Ratings (based on 100 PSI inlet)

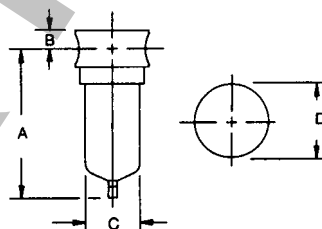
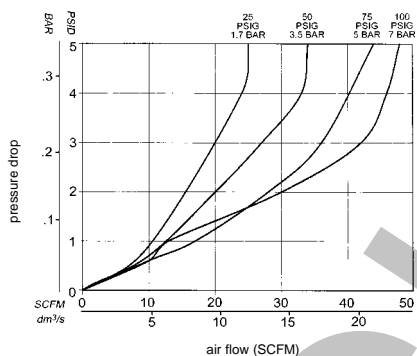

Dimensions

top dimensions = inches
 bottom dimensions (in parenthesis) = millimeters

SERIES	A	B	C	D
70	5.00 (127.0)	0.56 (14.0)	1.75 (44.0)	2.38 (60.0)

How To Order

F 70 B - 04 A _

Model:

F = Filter

Series:

70 = Stainless Steel
 4.0 oz. (1.2 Liter)
 Bowl Capacity

Element:

B = 5 Micron (Standard)

Threads:

- = NPTF
 G = G Tap (Bsp)

Options:

A = Auto Drain
 H = 0-250 PSI

Port Size:

04 = 1/2

NEED MORE PARTS AND INFORMATION?

- See page 11 for information on ordering replacement parts.



70 and 71 Series
Stainless Steel FRL Series



ANSI SYMBOL

Stainless Steel Coalescing Filter

F70D Series

- 316 Stainless Steel Body Construction
- Complete Coalescing Filter Line
- All Seals Made of Viton®
- Meets NACE Specifications

Specifications

Temperature Range °F (°C): 40°-180° (4°-82°)

Max. Operating Pressure PSIG (BAR): 300 (20)

Weight, lbs. (kg.): 1.88 (.85)

Flow Rating (based on 100 PSI inlet)

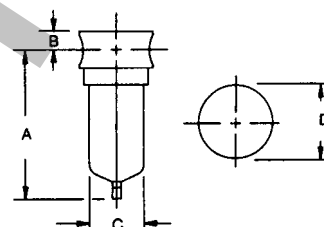
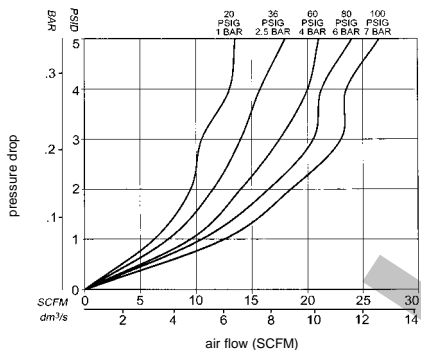

Dimensions

top dimensions = inches
bottom dimensions (in parenthesis) = millimeters

SERIES	A	B	C	D
70	5.00 (127.0)	0.56 (14.0)	1.75 (45.0)	2.38 (60.0)

How To Order

F 70 D - 04 A _

Model:

F = Filter

Series:

70 = Stainless Steel
4.0 oz. (0.12 Liter)
Bowl Capacity

Element:

C = 0.7 Micron
D = 0.3 Micron (Standard)
E = 0.1 Micron
F = Adsorber

Options:

A = Auto Drain
D = Pleated Prefilter

Port Size:

04 = 1/2

Threads:

- = NPTF
G = G Tap (BSPP)

NEED MORE PARTS AND INFORMATION?

• See page 11 for information on ordering replacement parts.



70 and 71 Series
Stainless Steel FRL Series

Stainless Steel Regulator

R70 Series

- 316 Stainless Steel Body Construction
- All Seals Made of Viton®
- 0-125 PSI Standard
- Meets NACE Specifications

Specifications

Temperature Range °F (°C): 40° to 150° (4° to 65°)

Max. Operating Pressure PSIG (BAR): 350 (24)

Weight, lbs. (kg.): 1.79 (.81)

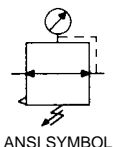

ANSI SYMBOL

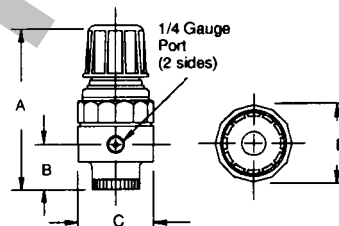

Dimensions

top dimensions = inches

bottom dimensions (in parenthesis) = millimeters

SERIES	A	B	C	D
70	4.94 (125.0)	1.38 (35.0)	2.31 (59.0)	2.44 (62.0)

Flow Ratings (based on 100 PSI inlet)

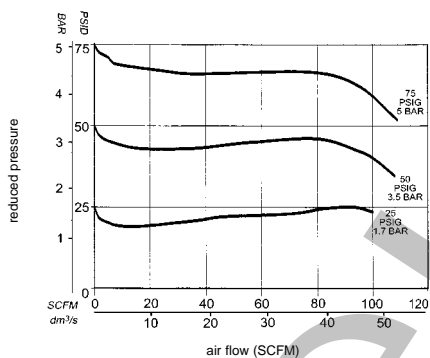

How To Order

R 70 N - 04 G _

Model:

R = Regulator

Series:

70 = Stainless Steel

Element:

N = Non-Relieving

R = Relieving (Standard)

Options:

G = Regulator Gauge

H = 0-250 PSI

P = Regulator Panel Unit

Port Size:

04 = 1/2

Threads:

- = NPTF

G = G Tap (BSPP)

NEED MORE PARTS AND INFORMATION?

• See page 11 for information on ordering replacement parts.



70 and 71 Series
Stainless Steel FRL Series



Stainless Steel Particulate
Filter/Regulator

P70 Series

- 316 Stainless Steel Body Construction
- All Seals Made of Viton®
- 0-125 PSI Standard
- Meets NACE Specifications

Specifications

Temperature Range °F (°C): 40° to 180° (4° to 82°)

Max. Operating Pressure PSIG (BAR): 300 (20)

Weight, lbs. (kg.): 2.43 (1.1)

Element: Sintered Polypropylene

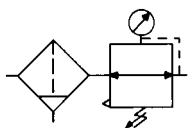

ANSI SYMBOL



Flow Ratings (based on 100 PSI inlet)

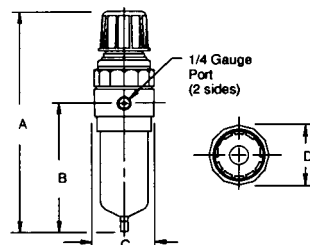
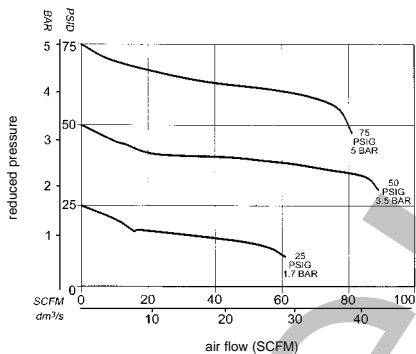

Dimensions

top dimensions = inches

bottom dimensions (in parenthesis) = millimeters

SERIES	A	B	C	D
70	8.50 (216.0)	4.94 (125.0)	2.38 (60.0)	2.44 (62.0)

How To Order

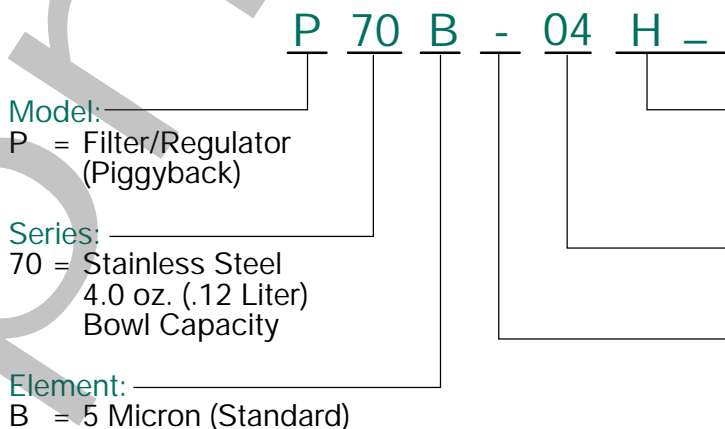

NEED MORE PARTS AND INFORMATION?

- See page 11 for information on ordering replacement parts.



70 and 71 Series
Stainless Steel FRL Series

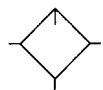

ANSI SYMBOL

Stainless Steel Lubricator

L70L Series

- 316 Stainless Steel Body Construction
- All Seals Made of Viton®
- Meets NACE Specifications

Specifications

Temperature Range °F (°C): 40° to 150° (4° to 65°)

Max. Operating Pressure PSIG (BAR): 350 (24)

Weight, lbs. (kg.): 1.79 (.81)

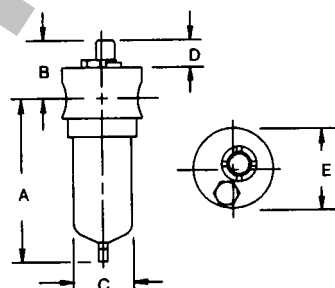

Flow Ratings (based on 100 PSI inlet)

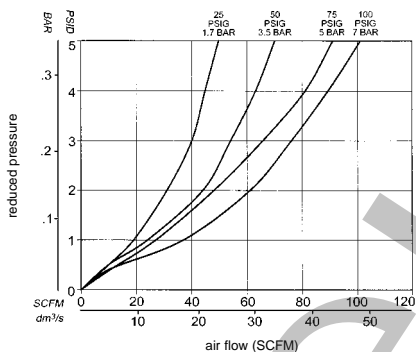

Dimensions

top dimensions = inches
bottom dimensions (in parenthesis) = millimeters

SERIES	A	B	C	D	E
70	5.00 (126.0)	1.81 (46.0)	1.75 (45.0)	0.94 (24.0)	2.38 (60.0)

How To Order

L 70 L - 04

Model:
L = Lubricator

Series:
70 = Stainless Steel
4.0 oz. (.12 liter)
Bowl Capacity

Element:
L = All Lubricators

Port Size:
04 = 1/2

Threads:
- = NPTF
G = G Tap (BSPP)

NEED MORE PARTS AND INFORMATION?

- See page 11 for information on ordering replacement parts.



70 and 71 Series
Stainless Steel FRL Series



Miniature Stainless Steel Particulate Filter
Specifications

Temperature Range °F (°C): 40° to 150° (4° to 65°)
Max. Operating Pressure PSIG (BAR): 350 (24)
Weight, lbs. (kg.): 1.79 (.81)

MODEL NUMBER	PIPE SIZE	MICRON RATING
F71B-02	1/4	5

Flow Ratings (based on 100 PSI inlet)

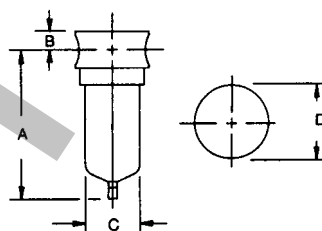
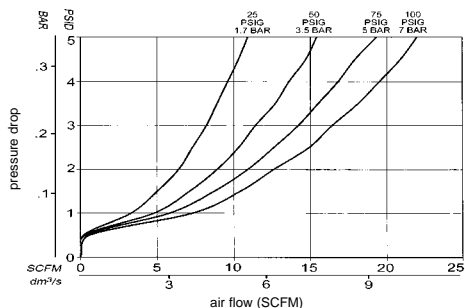

Dimensions

top dimensions = inches
bottom dimensions (in parenthesis) = millimeters

SERIES	A	B	C	D
71	3.69 (94.0)	0.37 (9.4)	1.56 (40.0)	1.56 (40.0)

Miniature Stainless Steel Coalescing Filter
Specifications

Temperature Range °F (°C): 40° to 150° (4° to 65°)
Max. Operating Pressure PSIG (BAR): 300 (20)
Weight, lbs. (kg.): 0.7 (0.31)
Element: Borosilicate Glass

MODEL NUMBER	PIPE SIZE	MICRON RATING
F71C-02	1/4	0.7
F71D-02	1/4	0.3
F71E-02	1/4	0.1
F71F-02	1/4	Adsorbing

Flow Ratings (based on 100 PSI inlet)

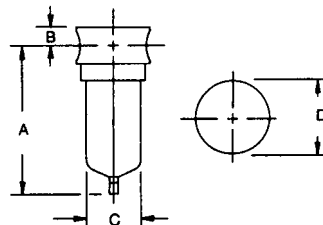
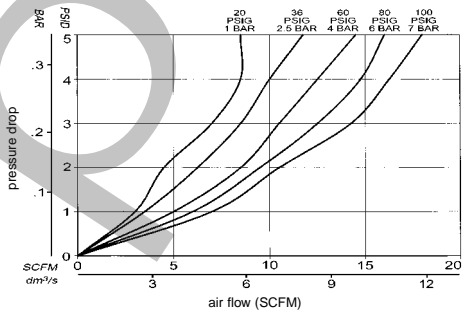

Dimensions

top dimensions = inches
bottom dimensions (in parenthesis) = millimeters

SERIES	A	B	C	D
71	3.69 (94.0)	0.37 (9.4.0)	1.56 (40.0)	1.56 (40.0)

NEED MORE PARTS AND INFORMATION?

See page 11 for information on ordering replacement parts.



70 and 71 Series
Stainless Steel FRL Series



Miniature Stainless Steel Regulator

Specifications

Temperature Range °F (°C): 40° to 150° (4° to 65°)

Max. Operating Pressure PSIG (BAR): 350 (24)

Weight, lbs. (kg.): 0.5 (0.23)

MODEL NUMBER	PIPE SIZE
--------------	-----------

R71R-02 1/4

*For gauge add a "G" at the end of model number.

Flow Ratings (based on 100 PSI inlet)

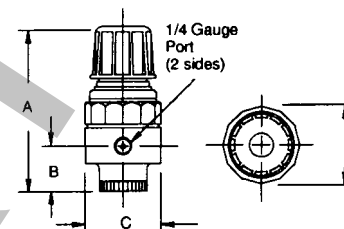
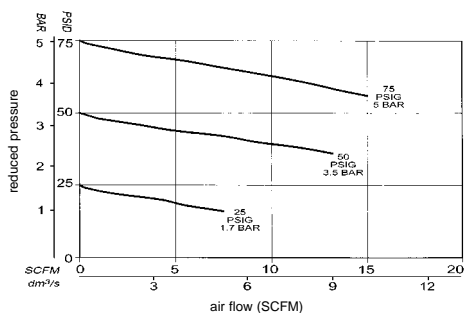

Dimensions

top dimensions = inches
bottom dimensions (in parenthesis) = millimeters

SERIES	A	B	C	D
71	2.88 (73.0)	0.50 (12.7)	1.56 (40.0)	1.56 (40.0)



Miniature Stainless Steel Particulate
Filter/Regulator

Specifications

Temperature Range °F (°C): 40° to 150° (4° to 65°)

Max. Operating Pressure PSIG (BAR): 300 (20)

Weight, lbs. (kg.): 0.8 (0.37)

MODEL NUMBER	PIPE SIZE	MICRON RATING
--------------	-----------	---------------

P71B-02 1/4 5

*For gauge add a "G" at the end of model number.

Flow Ratings (based on 100 PSI inlet)

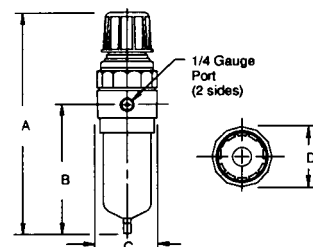
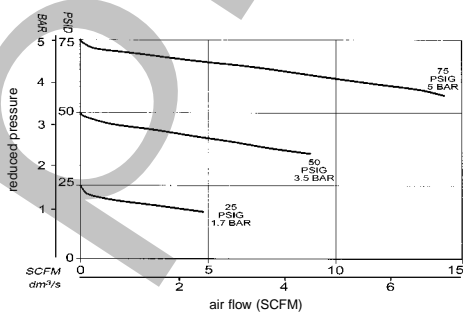

Dimensions

top dimensions = inches
bottom dimensions (in parenthesis) = millimeters

SERIES	A	B	C	D
71	6.13 (156.0)	3.75 (95.0)	1.56 (40.0)	1.56 (40.0)

NEED MORE PARTS AND INFORMATION?

See page 11 for information on ordering replacement parts.



70 and 71 Series Stainless Steel FRL Series



Replacement Kits

70 Series Stainless Steel Particulate Filter

► Element Replacement Kits

includes filter element only

kit #	description
EKF20A	70 Series, 40 micron element
EKF20B	70 Series, 5 micron element

70 Series Stainless Steel Coalescing Filter

► Element Replacement Kits

includes filter element only

kit #	description
EKF20C	70 Series, 0.7 micron element EKF20CD
EKF20CD	70 Series, 0.7 micron element with prefilter
EKF20D	70 Series, 0.3 micron element
EKF20DD	70 Series, 0.3 micron element with prefilter
EKF20E	70 Series, 0.1 micron element
EKF20ED	70 Series, 0.1 micron element with prefilter
EKF20F	70 Series, adsorbing element

70 Series Stainless Steel Regulator

► Regulator Repair Kits

kit #	description
RKC70	70 Series, cage kit (inc. adjustment knob and spring cage)
RKR70R	70 Series, (inc. relieving diaphragm and inner valve)
RKR70N	70 Series, (inc. non-relieving diaphragm and inner valve)

70 Series Stainless Steel Lubricator

► Lubricator Repair Kits

includes adjustment assembly

kit #	description
RKL70	70 Series, lubricator repair kit

71 Series Stainless Steel Particulate Filter

► Element Replacement Kits

includes filter element only

kit #	description
EKF10A	71 Series, 40 micron element
EKF10B	71 Series, 5 micron element

71 Series Stainless Steel Coalescing Filter

► Element Replacement Kits

includes filter element only

kit #	description
EKF10C	71 Series, 0.7 micron element
EKF10CD	71 Series, 0.7 micron element with prefilter
EKF10D	71 Series, 0.3 micron element
EKF10DD	71 Series, 0.3 micron element with prefilter
EKF10E	71 Series, 0.1 micron element
EKF10ED	71 Series, 0.1 micron element with prefilter
EKF10F	71 Series, adsorbing element

71 Series Stainless Steel Regulator

► Regulator Repair Kits

includes diaphragm and inner valve

kit #	description
RKR71R	71 Series, regulator repair kit (relieving)
RKR70N	71 Series, regulator repair kit (non-relieving)