

ORDER
ONLINE



Grippers



GR Series

Adjustable Angular Gripper

We're everywhere you need us to be!



GR90 Series Angular Grippers	3-5
Features & Benefits	3
How to Order	3
Dimensions	4
Technical Specifications	5

Pneuhair



GR90 Series
Angular Grippers



GR90-Series Angular Grippers

The GR90-Series has a double acting piston attached to a cross bar by a connecting rod. The linear movement of the piston is transformed into angular movement of the jaws through a double toggle link mechanism.

A. Body:

Hardcoat anodized with Teflon®, reduced friction, reduced wear. Front and side ports standard.

B. Jaws:

Hardened alloy steel.
Keyway slot for tooling location.
180° if jaw motion.

C. Locking Adjustment Screw:

Jaw rotations can be adjusted from 0-90° to be custom fit to each application.

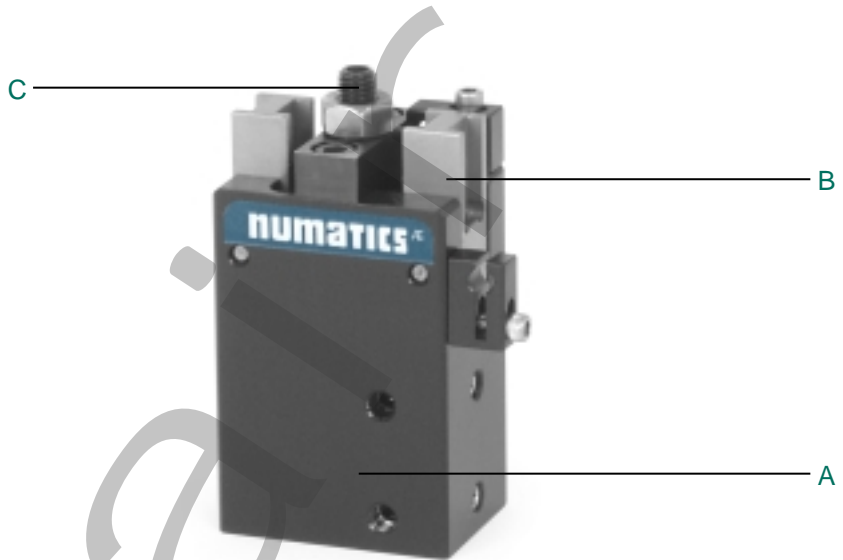

How to Order

GR90 1 6 D X

Seal Type

- 1 = Buna-N Seals
- 2 = Viton Seals

Sensing Type

Standard Cord Set

- 4 = Prox Switch - PNP (sourcing)
- 5 = Prox Switch - NPN (sinking)
- 6 = No Sensing

Quick Disconnect Cord Set

- W = Prox Switch - PNP (sourcing) Straight
- V = Prox Switch - NPN (sinking) Straight
- U = Prox Switch - PNP (sourcing) 90 Deg.
- T = Prox Switch - NPN (sinking) 90 Deg.

Prox switches are 4 mm diameter.

Special Options

- X = No Options

Sensing Position

- A = Single Position Open
- B = Single Position Close
- C = Two Position Sensing
- D = No Sensing

When ordering additional switches & Seal Kits:

SENSING KITS STANDARD CORD SET		SENSING KITS QUICK DISCONNECT CORD SET	
Hall Effect-PNP (Sourcing)	PX04PS	Hall Effect-PNP (Sourcing)	PX04PQ
Hall Effect-NPN (Sinking)	PX04NS	Hall Effect-NPN (Sinking)	PX04NQ
		90° 5 meter cable	PXC90
		Straight 5 meter cable	PXCST
		(5m Cables)	



GR90 Series Angular Grippers



GR90 Dimensions

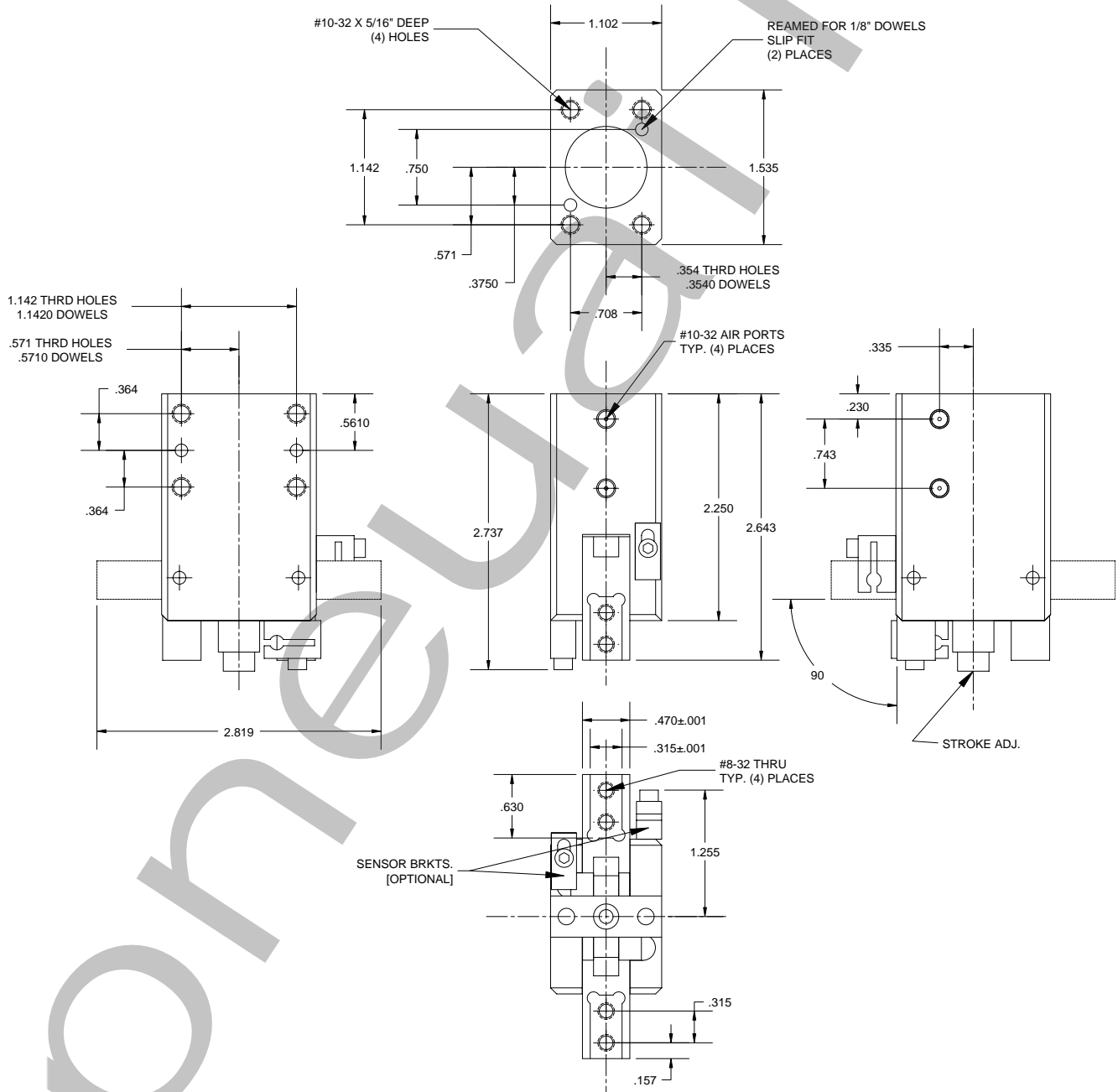



GR90 Series
Angular Grippers



GR90-Series Gripper Performance Data

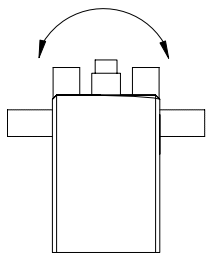

Position A

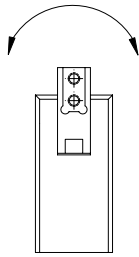

Position B

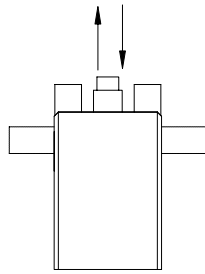

Position C

Gripper Specifications

	GR90
Grip Force	
open @ 100 psi	55 lbs
close @ 100 psi	52 lbs.
Displacement	0.46 cu. in.
Max Operating Pressure	120 psi
Side Play	±0.001
Weight	7 oz.

Recommended Maximum Load Ratings

	GR90	
Max Load Position A	30 in-lb	3.4 Nm
Max Load Position B	30 in-lb	3.4 Nm
Max Load Position C	40 lbs.	18Kgf

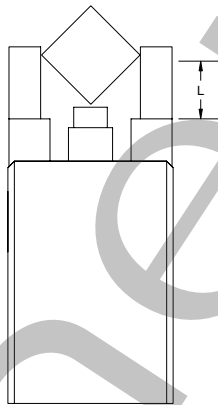

L (FINGER LENGTH)	GR90
1 Inch	30 lbs.
1.5 Inches	25 lbs.
2 Inches	15 lbs.

Force at 80 psi.