

ORDER  
ONLINE

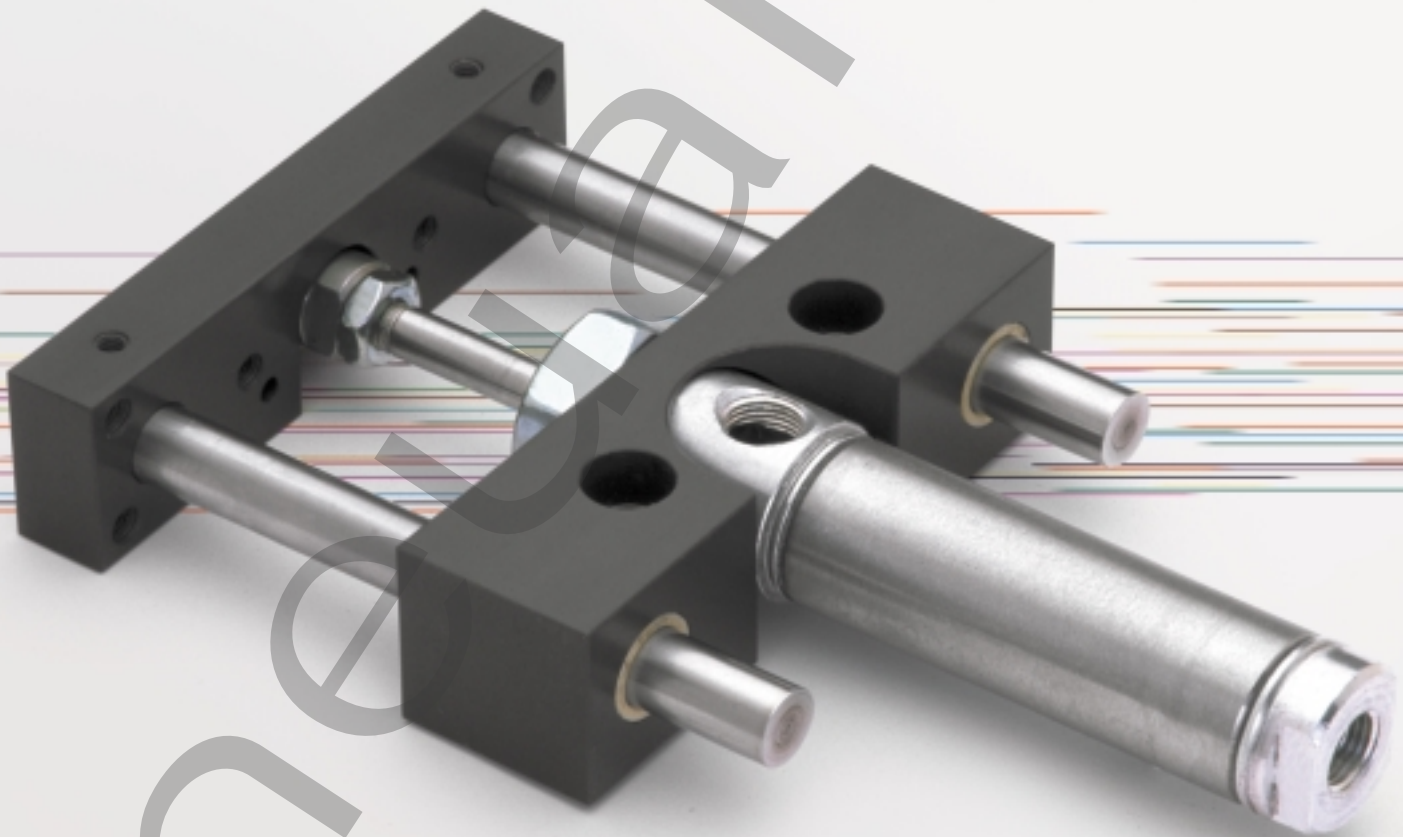

Slides



***LC Series***

***Light Duty Slide***

*We're everywhere you need us to be!*



## LC Series

LC Series .....	3-6
Features and Benefits .....	3
How To Order .....	4
Dimensions .....	5
Technical Specifications .....	6

Pneuhair



LC Series

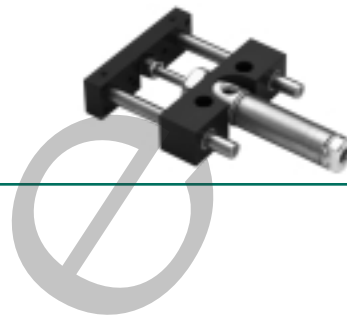

The “LC” series provides guided linear motion at a lower cost. External cylinder is mounted rigidly to the cross body which drives the tool plate. The tool plate motion is guided by two hardened linear rods. The linear rods are supported by engineered polymer plastic bushings.

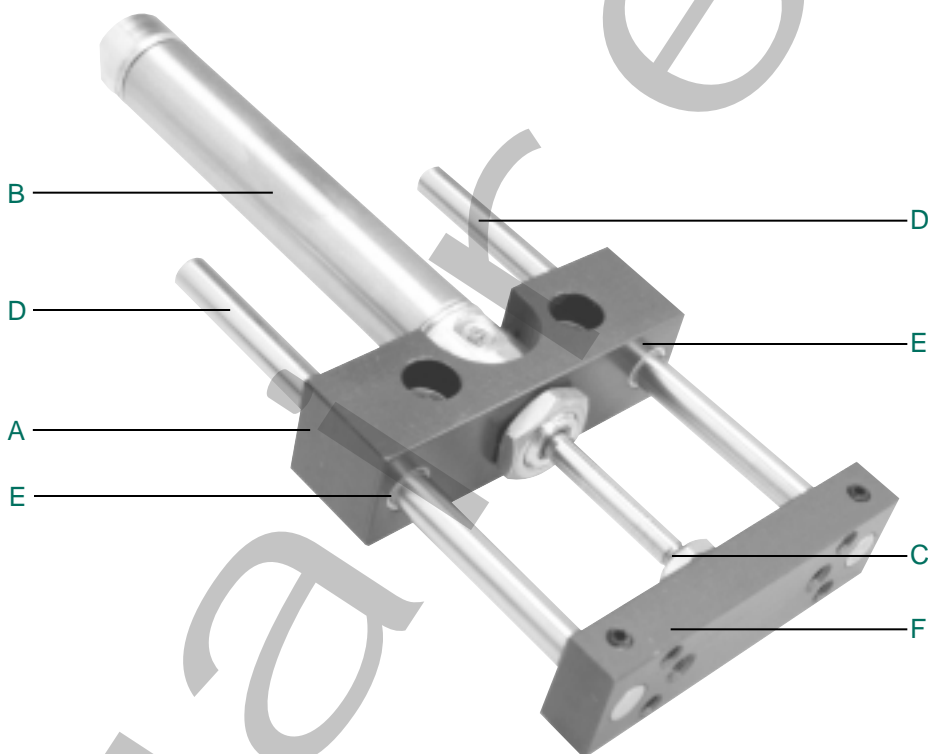

**A. Body:**

Hardcoat anodized aluminum .....lightweight, durable, high strength to weight ratio  
Easy access mounting .....drilled and counterbored for flush mount

**B. Air Cylinder:**

Standard stainless steel body and piston rod .....corrosion resistant  
Standard with magnetic piston .....sensing options, reed, hall effect and proximity able to be added in the field  
Optional cushion control .....decelerated motion on 1-1/16 bore and greater

**C. Alignment Coupler:**

360 degrees of float.....isolates air cylinder from destructive side loads maximum cylinder life

**D. Guide Shafts:**

Hardened steel .....hardness Rc60-65, low friction, long life  
Optional stainless steel .....hardness Rc50-55, corrosion resistant

**E. Bushings:**

Engineered plastic polymer .....low friction, high durability, no lubrication required  
Maximum rigidity .....superior rod diameter to bushing length ratio

**F. NuMate™ Mounting:**

Direct mount mounting system .....eliminates adapter and transition plate  
Patent No. 5,560,281 .....mounts directly to other Numatics Motion Control products



LC Series

How to Order

LC 075 04 H 1 6 D XX

Bore Sizes

- 056 = 9/16 Inch
- 075 = 3/4 Inch
- 106 = 1-1/16 Inches
- 150 = 1-1/2 Inches

Standard Stroke

- 01 = 1"
- 02 = 2"
- 03 = 3"
- 04 = 4"
- 05 = 5"
- 06 = 6"

Guide Shaft Type

- H = Hardened Steel Shafts
- S = Stainless Steel Shafts

Cylinder Type

- 1 = Buna-N Seals
  - 2 = Viton Seals (no magnet)
  - 3\* = Buna-N with Cushions\*
  - 4\*\* = Viton Seals with Magnet
- \*Head cushion factory set, see page 5 for dimensional changes. Available on bore sizes 106 and 150.  
\*\* Max. Temperature of slide is 140° F.

Options

- XX = No Options
  - SE\* = Stop Collars for Extend Stroke Adjust
  - SR\* = Stop Collars for Retract Stroke Adjust
  - SB\* = Stop Collars for Extend and Retract
- \*Stop collars will be stainless when guide shafts are stainless

Sensing Position

- A = Single Position Extend
- B = Single Position Retract
- C = Extend and Retract
- D = No Sensing

Sensing Type

- Standard Cord Set
  - 1 = Hall Effect - PNP (sourcing)
  - 2 = Hall Effect - NPN (sinking)
  - 3 = Reed Switch
  - 4 = Prox Switch on Cylinder - PNP (sourcing)
  - 5 = Prox Switch on Cylinder - NPN (sinking)
  - 6 = No Sensing
- Quick Disconnect Cord Set
  - Z = Hall Effect - PNP (sourcing)
  - Y = Hall Effect - NPN (sinking)
  - X = Reed Switch
  - W = Prox Switch on Cylinder - PNP (sourcing) Straight
  - V = Prox Switch on Cylinder - NPN (sinking) Straight
  - U = Prox Switch on Cylinder - PNP (sourcing) 90 Deg.
  - T = Prox Switch on Cylinder - NPN (sinking) 90 Deg.

Reference the sensing section of the catalog for sensing specifications.

Example order:

Part Number: LC07504H1GDXX\*  
 Part Description: 3/4" diameter bore x 4" stroke, buna seals, hardened steel guide shafts, no switches, no special options.

\*When entering an order, DO NOT use spaces or dashes.

When ordering additional accessories:

SWITCH DESCRIPTION	STANDARD PART NO.	QUICK DISCONNECT PART NO.
Hall Effect - PNP (Sourcing)	HPNPS31*	HPNPQ31*
Hall Effect - NPN (Sinking)	HNPNS32*	HNPNQ32*
Reed Switch	RSS02*	RSQ02*
Prox Switch - PNP (Sourcing)	SWPP - 0001	SWPP - QS01
Prox Switch - NPN (Sinking)	SWPN - 0001	SWPN - QS01
Prox Switch - PNP 90°	-	SWPP - QL01
Prox Switch - NPN 90°	-	SWPN - QL01
90° 5 meter cable	-	PXC90
Straight 5 meter cable	-	PXCST

\*Bands and tracks required for mounting.  
 Reference bracket in the Switch Application Chart in the Sensor section.



LC Series

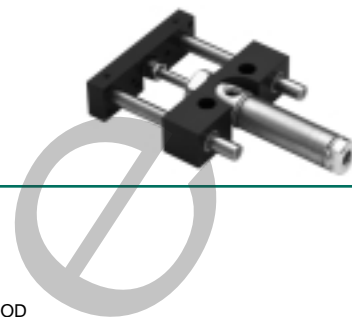

LC Series Dimensions

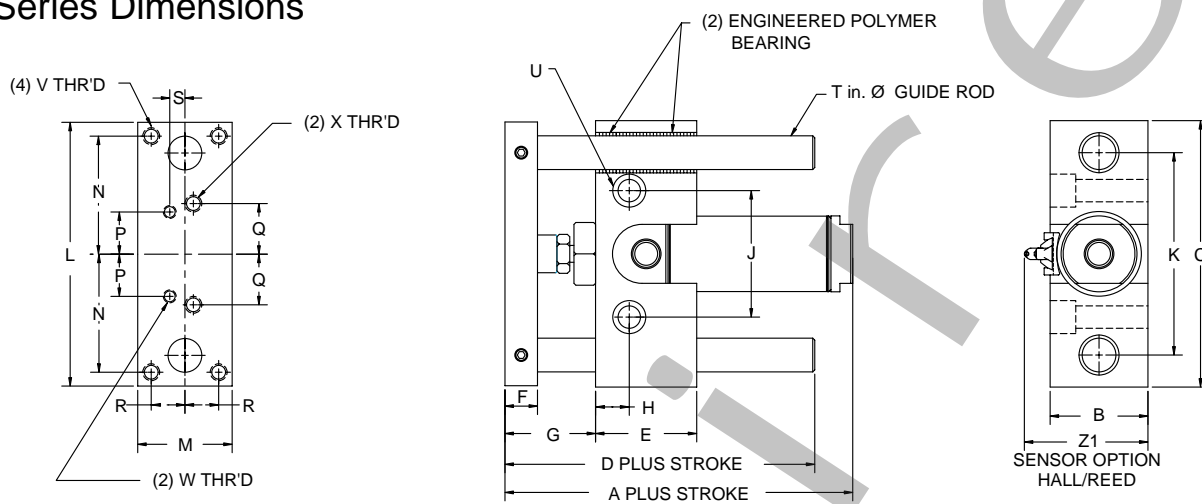

	LC056	LC075	LC106	LC150
A	2.97	3.75	4.16	4.75
B	0.75	0.98	1.45	1.75
C	2.50	3.40	3.95	5.00
D	2.11	2.78	3.60	3.94
E	0.75	1.00	1.50	1.50
F	0.36	0.47	0.48	0.625
G	0.86	1.09	1.34	1.56
H	0.375	0.50	0.50	0.50
J	1.25	1.50	1.875	2.25
K	2.00	2.50	3.00	3.75
L	2.46	3.36	3.91	4.97
M	0.70	0.94	1.40	1.72
N	0.75	1.50	1.75	2.25
P	--	0.50	0.625	0.750
Q	0.625	0.625	0.75	0.937
R	0.218	0.312	0.50	0.625
S	--	0.187	0.35	0.375
T	0.25	0.375	0.50	0.625
U	c'bore for #10 SHCS	c'bore for 1/4 SHCS	c'bore for 5/16 SHCS	c'bore for 5/16 SHCS
V	#8-32 thru	#10-32 thru	1/4-20 thru	5/16-18 thru
W	--	#6-32 Thru	#10-32 thru	1/4-20 thru
X	#10-32 thru	#10-32 thru	1/4-20 thru	5/16-18 thru
Z1	1.16	1.35	1.76	2.13

CUSHION CYLINDER OPTION				
	LC056	LC075	LC106	LC150
A	-	-	4.41	4.94

Unit Weight Table

	LC056	LC075	LC106	LC150
Base Unit Weight	0.33	0.78	1.96	3.48
Adder/inch of stroke	0.05	0.11	0.15	0.28
Add base weight to inch adder X stroke	Sample weight calculation: Model LC075 W/3", .78 + (3x .11)=1.11lbs			

Unit Output Force Table

	LC056	LC075	LC106	LC150
Extend Force (lbs)	0.24	0.44	0.88	1.76
Retract Force (lbs)	0.22	0.39	0.81	1.61
Multiply force factor X input pressure in psi	Sample output force calculation: Model LC075 extend force @ 70psi, 0.44 x 70=30.8lbs			



LC Series

Maximum Dynamic Load and Deflection Ratings

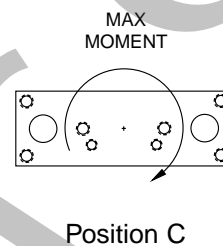
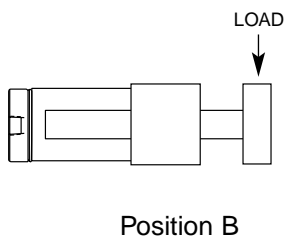
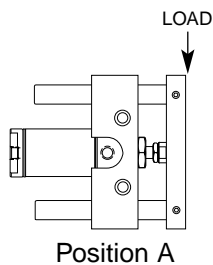

Stroke	LC056			LC075			LC106			LC150		
	Pos A&B Load (lbs)	Pos A&B Deflection (in)	Pos C Max Moment	Pos A&B Load (lbs)	Pos A&B Deflection (in)	Pos C Max Moment	Pos A&B Load (lbs)	Pos A&B Deflection (in)	Pos C Max Moment	Pos A&B Load (lbs)	Pos A&B Deflection (in)	Pos C Max Moment
1	3.00	0.0006	3 inlb	3.00	0.0002	5 inlb	8.0	0.0002	8 inlb	12.0	0.0015	12 inlb
2	1.50	0.0010	3 inlb	2.50	0.0004	5 inlb	4.0	0.0003	8 inlb	6.0	0.0020	12 inlb
3	1.00	0.0017	3 inlb	1.67	0.0007	5 inlb	2.7	0.0004	8 inlb	4.0	0.0028	12 inlb
4	0.75	0.0025	3 inlb	1.25	0.0009	5 inlb	2.0	0.0005	8 inlb	3.0	0.0038	12 inlb
5	0.60	0.0035	3 inlb	1.00	0.0013	5 inlb	1.6	0.0007	8 inlb	2.4	0.0050	12 inlb
6	0.50	0.0047	3 inlb	0.84	0.0017	5 inlb	1.3	0.0009	8 inlb	2.0	0.0064	12 inlb

Rotational Clearance

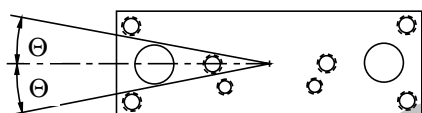

LC056	LC075	LC106	LC150
+/- 0.17°	+/- 0.15°	+/- 0.15°	+/- 0.15°

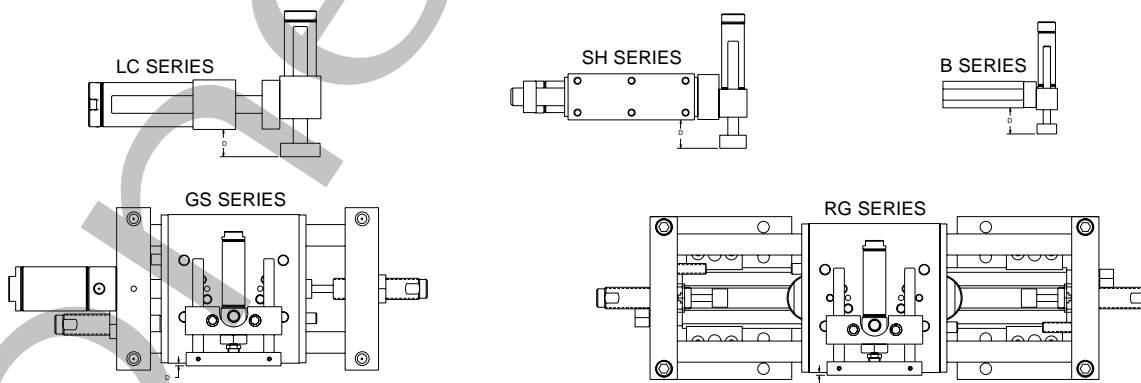

NuMate™ Compatibility Table & Edge Reference

	LC056	LC075	LC106	LC150	SH056	SH075	SH106	SH150	SH200	GS075	GS106	GS150	GS200	RG25B	RG32C	RG32D	B04	B06	B08
LC056	0.86	0.75	0.86	-	0.73	0.92	-	-	-	-0.28	-0.14	-	-	-0.14	-	-	1.02	0.92	0.93
LC075	-	-	0.86	0.71	1.09	0.96	1.00	-	-	-0.54	-0.35	0.09	-	-0.35	0.09	-	-	-	0.97
LC106	-	-	-	0.96	-	-	1.09	1.15	-	-	-0.85	-0.41	-0.54	-0.85	-0.41	-0.54	-	-	-
LC150	-	-	-	-	-	-	-	0.93	1.18	-	-	-0.89	-1.02	-	-0.89	-1.02	-	-	-

\* All Dimensions in these charts are in inches