

ORDER  
ONLINE



Slides



# ***PST Series***

***Precision Slide Table***

*We're everywhere you need us to be!*



## PST Series Power Slides

PST Series Power Slides .....	3-9
Features and Benefits .....	3
How To Order .....	3
Technical Specifications .....	4-6
Dimensions .....	7-9

Pneumair



PST Series  
Precision Slides



“PST” Precision Slide Table

Series PST Slide provides smooth precise linear motion with high accuracy at twice the thrust of a single bore cylinder. The precision linear rail system supports the load through the entire stroke length.

- A. Dual square rails provide high load capabilities and precise linear motion.
- B. Twin bores deliver twice the thrust of a single bore cylinder.
- C. Optional stroke adjustment available for extend stroke .
- D. Axial mounting and locating holes standard.
- E. Sensing groove for Hall or Reed switches.

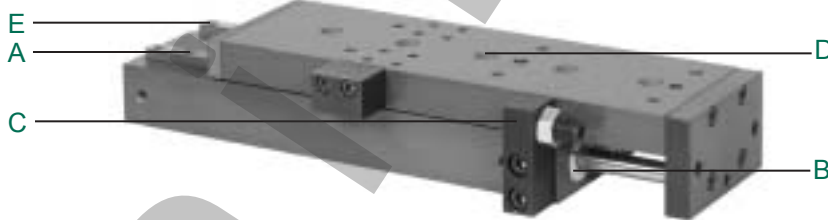

How to Order

PST 16 050 B 1 6 D 4 4

Bore Sizes

- 16 = 16 mm
- 20 = 20 mm
- 25 = 25 mm

Standard Stroke

- 010 = 10 mm
- 020 = 20 mm
- 025 = 25 mm
- 030 = 30 mm
- 040 = 40 mm
- 050 = 50 mm
- 075 = 75 mm
- 100 = 100 mm

Seal Option

- 1 = Buna
- 2 = Viton

Sensing Type

- Standard Cord Set
    - 1 = Hall Switch - PNP (sourcing)
    - 2 = Hall Switch - NPN (sinking)
    - 3 = Reed Switch
    - 6 = No Sensing
  - Quick Disconnect Cord Set
    - Z = Hall Switch - PNP (sourcing)
    - Y = Hall Switch - NPN (sinking)
    - X = Reed Switch
- See Sensor section.

Shock Option

- Hardware Only
  - 1 = Extend
  - 2 = Retract
  - 3 = Extend/Retract
  - 4 = No Shock Hardware
- Hardware and Shocks
  - A = Extend
  - B = Retract
  - C = Extend/Retract

Stroke Adjustment

- 1 = Extend Stroke
- 2 = Retract Stroke
- 3 = Extend/Retract
- 4 = No Stroke Adjustment

Sensing Position

- A = Single Position Extend
- B = Single Position Retract
- C = Extend and Retract
- D = No Sensing

When Ordering Additional Sensors

SWITCH DESCRIPTION	STANDARD PART NO.	QUICK DISCONNECT PART NO.
Hall Effect - PNP (Sourcing)	HPNPS31	HPNPQ31
Hall Effect - NPN (Sinking)	HNPNS32	HNPNQ32
Reed Switch	RSS02	RSQ02
90° 5 meter cable	-	PXC90
Straight 5 meter cable	-	PXCST

Extend Stroke Adjustment Kit

MODEL NO.	PART NO.
PST16	PSTSAKE16
PST20	PSTSAKE20
PST25	PSTSAKE25

Retract Stroke Adjustment Kit

MODEL NO.	PART NO.
PST16	PSTSAKR16
PST20	PSTSAKR20
PST25	PSTSAKR25



PST Series  
Precision Slides



PST16 Technical Specifications

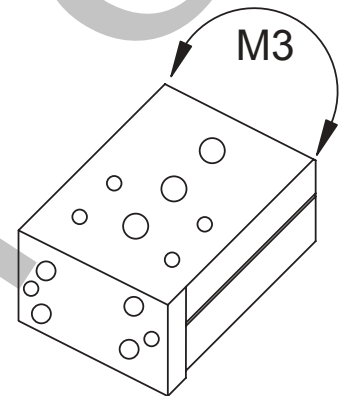
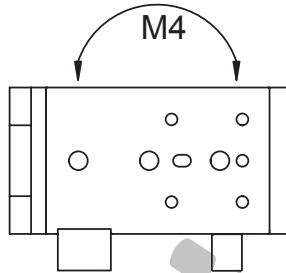
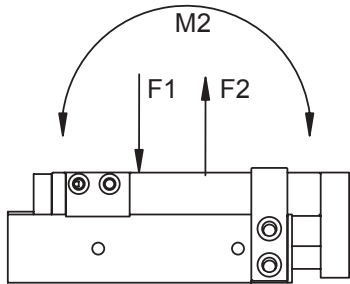

Technical Specifications

	PST16
M2 Nm (in.-lbs.)	2.4 (21.0)
M3 Nm (in.-lbs.)	2.8 (25.0)
M4 Nm (in.-lbs.)	2.3 (20.0)
F1: kg (lbs)	23.0 (50.0)
F2: kg (lbs)	16.0 (35.0)

Unit Output Force Table

BORE	EXTEND	RETRACT
16 (piston area inches sq.)	0.624	0.486
16 (piston area mm sq.)	402.0	302.0

Example:  
Pounds = PSI x Piston Area inches sq.  
Newtons = MPa x Piston Area mm sq.

PST016 Dimensions

	STROKE - MM (INCHES)						
	10	20	30	40	50	75	100
A	7.4 (0.29)	7.4 (0.29)	7.4 (0.29)	7.4 (0.29)	9.0 (0.35)	9.0 (0.35)	9.0 (0.35)
F	35.0 (1.38)	35.0 (1.38)	35.0 (1.38)	40.0 (1.57)	30.0 (1.81)	55.0 (2.16)	65.0 (2.56)
G	16.0 (0.63)	16.0 (0.63)	16.0 (0.63)	16.0 (0.63)	21.0 (0.83)	26.0 (1.02)	39.0 (1.53)
GA	16.0 (0.63)	16.0 (0.63)	16.0 (0.63)	16.0 (0.63)	51.0 (2.01)	61.0 (2.40)	109 (4.29)
H	40.0 (1.57)	40.0 (1.57)	40.0 (1.57)	50.0 (1.96)	30.0 (1.18)	35.0 (1.38)	35.0 (1.38)
HA	40.0 (1.57)	40.0 (1.57)	40.0 (1.57)	50.0 (1.97)	30.0 (1.18)	70.0 (2.76)	70.0 (2.76)
J	44.0 (1.73)	44.0 (1.73)	44.0 (1.73)	54.0 (2.13)	67.0 (2.65)	117.0 (4.62)	165.0 (6.51)
K	27.0 (1.06)	37.0 (1.47)	47.0 (1.86)	57.0 (2.24)	67.0 (2.65)	92.0 (3.63)	117.0 (4.61)
M	76.0 (2.99)	76.0 (2.99)	76.0 (2.99)	86.0 (3.39)	101.0 (3.98)	151.0 (5.94)	199 (7.83)
N	4.0	4.0	4.0	4.0	6.0	6.0	6.0
NN	2.0	2.0	2.0	2.0	3.0	4.0	5.0
Z	75.0 (2.95)	75.0 (2.95)	75.0 (2.95)	85.0 (3.35)	100.0 (3.94)	150.0 (5.91)	198.0 (7.80)
ZZ	87.0 (3.42)	87.0 (3.42)	87.0 (3.42)	97.0 (3.81)	112.0 (4.41)	162.0 (6.38)	210.0 (8.26)



PST Series  
Precision Slides



PST16 Dimensions

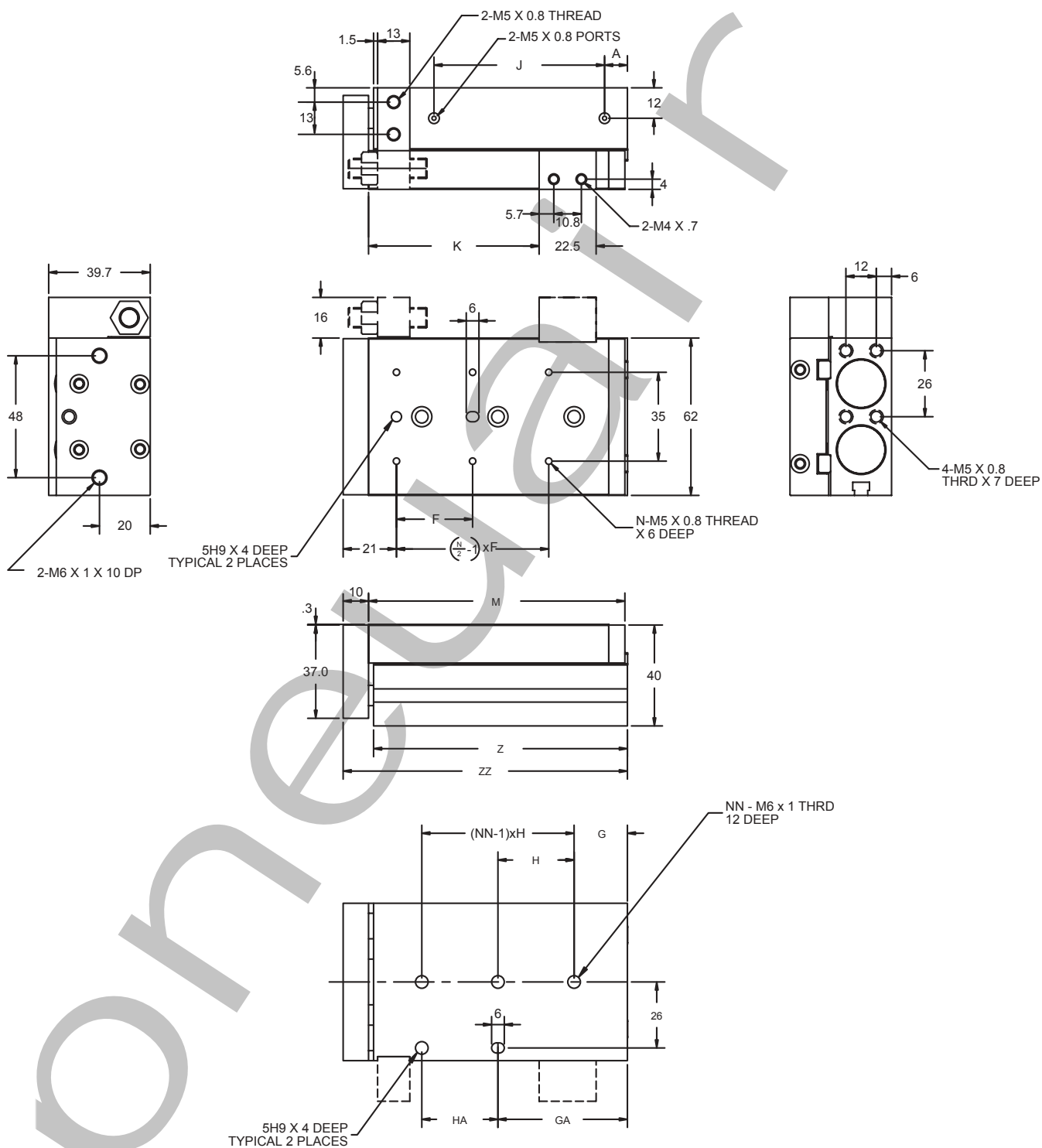



PST Series  
Precision Slides



PST20 Technical Specifications

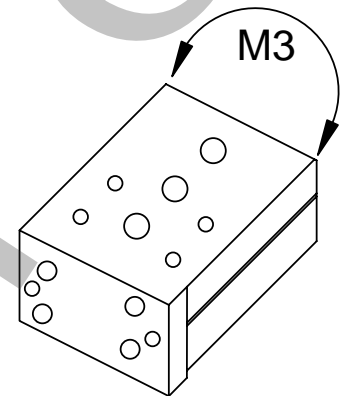
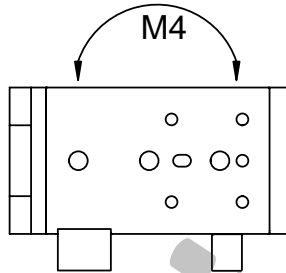
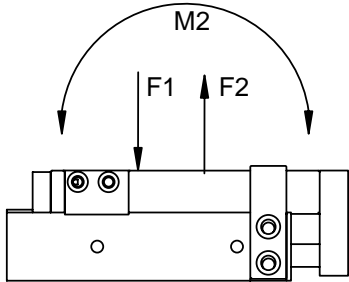

NOTE: PST20 max. stroke 100mm

Technical Specifications

	PST20
M2 Nm (in.-lbs.)	23.3 (206.6)
M3 Nm (in.-lbs.)	24.6 (217.9)
M4 Nm (in.-lbs.)	27.4 (242.7)
F1: kg (lbs)	29.4 (65.0)
F2: kg (lbs)	20.6 (45.5)

Unit Output Force Table

BORE	EXTEND	RETRACT
20 (piston area inches sq.)	0.973	0.730
20 (piston area mm sq.)	628.0	471.0

Example:  
Pounds = PSI x Piston Area inches sq.  
Newtons = MPa x Piston Area mm sq.

PST20 Dimensions

	STROKE - MM (INCHES)						
	10	20	30	40	50	75	100
A	10.0 (0.39)	10.0 (0.39)	10.0 (0.39)	10.0 (0.39)	10.5 (0.39)	10.5 (0.41)	10.5 (0.41)
F	50.0 (1.97)	50.0 (1.97)	50.0 (1.97)	60.0 (2.36)	35.0 (1.38)	60.0 (2.36)	70.0 (2.76)
G	15.0 (0.59)	15.0 (0.59)	15.0 (0.59)	15.0 (0.59)	15.0 (0.59)	19.0 (0.75)	37.0 (1.46)
GA	25.0 (0.98)	25.0 (0.98)	25.0 (0.98)	35.0 (1.38)	50.0 (1.97)	54.0 (2.13)	107 (4.21)
H	45.0 (1.77)	45.0 (1.77)	45.0 (1.77)	55.0 (2.16)	35.0 (1.38)	35.0 (1.38)	35.0 (1.38)
HA	35.0 (1.38)	35.0 (1.38)	35.0 (1.38)	35.0 (1.38)	35.0 (1.38)	70.0 (2.76)	70.0 (2.76)
J	45.6 (1.80)	45.6 (1.80)	45.6 (1.80)	55.0 (2.19)	70.1 (2.76)	109.1 (4.30)	162.1 (6.38)
K	29.3 (1.15)	39.3 (1.55)	49.3 (1.94)	59.3 (2.33)	69.3 (2.73)	94.3 (3.71)	119.3 (4.70)
M	83.0 (3.27)	83.0 (3.27)	83.0 (3.27)	93.0 (3.66)	108.0 (4.25)	147.0 (5.79)	200.0 (7.87)
N	4.0	4.0	4.0	4.0	6.0	6.0	6.0
NN	2.0	2.0	2.0	2.0	3.0	4.0	5.0
Z	81.5 (3.21)	81.5 (3.21)	81.5 (3.21)	91.5 (3.60)	106.5 (4.19)	145.5 (5.73)	198.5 (7.81)
ZZ	97.0 (3.82)	97.0 (3.82)	97.0 (3.82)	107.0 (4.21)	122.0 (4.80)	161.0 (6.34)	214.0 (8.43)



PST Series  
Precision Slides



PST20 Dimensions

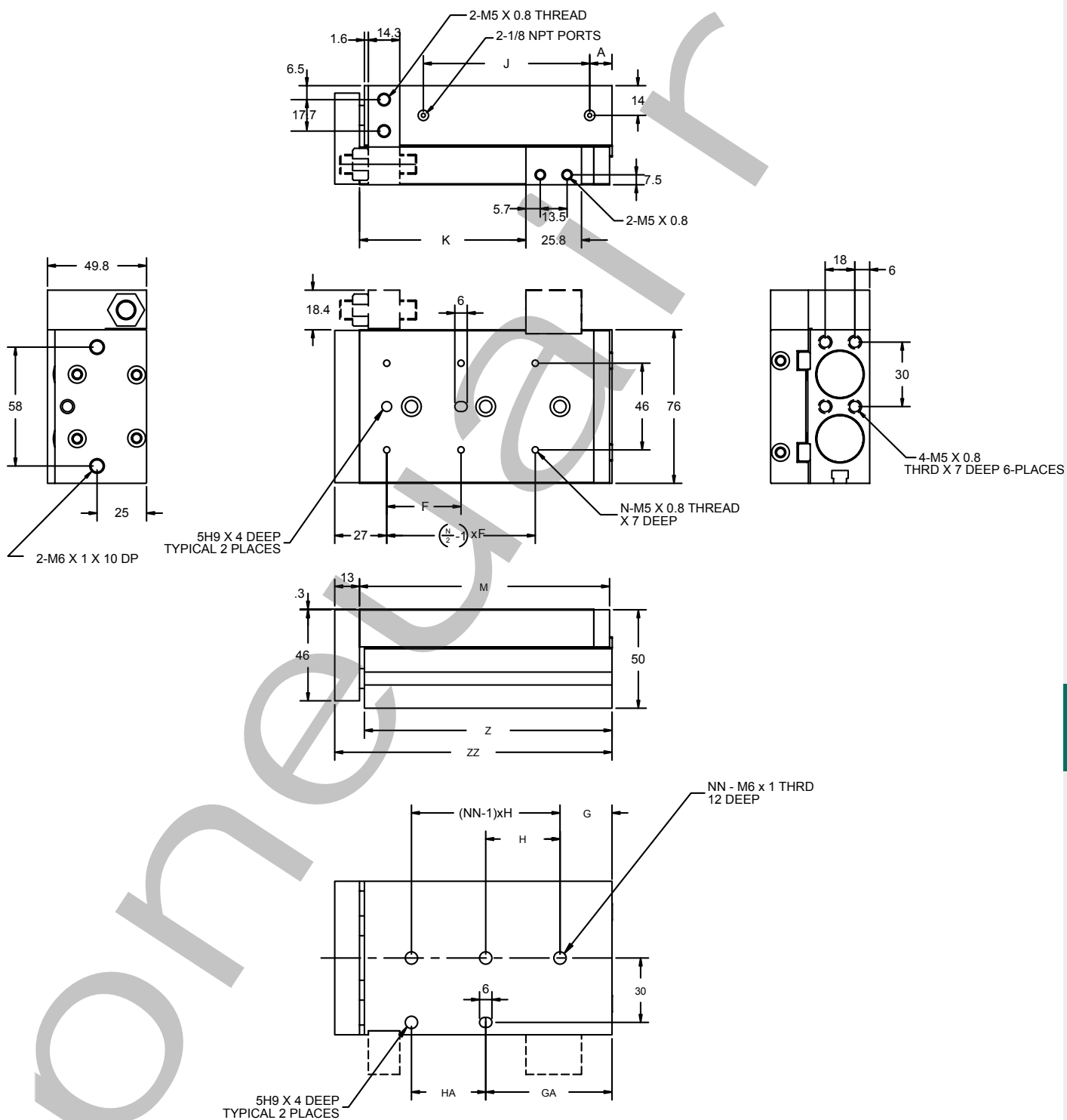



PST Series  
Precision Slides



PST25 Technical Specifications

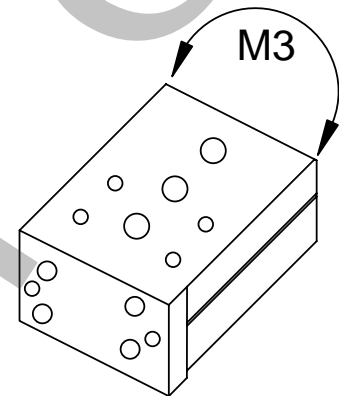
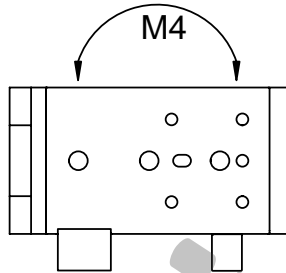
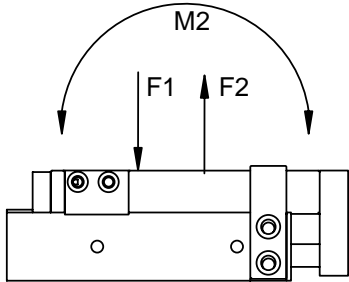

NOTE: PST25 max. stroke 100mm

Technical Specifications

	PST25
M2 Nm (in.-lbs.)	34.3 (303.3)
M3 Nm (in.-lbs.)	45.1 (399.9)
M4 Nm (in.-lbs.)	41.1 (364.1)
F1: kg (lbs)	40.8 (90.0)
F2: kg (lbs)	28.6 (63.2)

Unit Output Force Table

BORE	EXTEND	RETRACT
25 (piston area inches sq.)	1.522	1.171
25 (piston area mm sq.)	982.0	756.0

Example:  
Pounds = PSI x Piston Area inches sq.  
Newtons = MPa x Piston Area mm sq.

PST25 Dimensions

	STROKE - MM (INCHES)						
	10	20	30	40	50	75	100
A	8.89 (0.35)	8.89 (0.35)	8.89 (0.35)	8.89 (0.35)	12.09 (0.48)	12.07 (0.48)	12.07 (0.48)
F	50.0 (1.97)	50.0 (1.97)	50.0 (1.97)	60.0 (2.36)	35.0 (1.38)	59.94 (2.36)	70.0 (2.76)
G	22.0 (0.87)	22.0 (0.87)	22.0 (0.87)	22.48 (0.89)	20.02 (0.79)	26.01 (1.02)	32.00 (1.26)
GA	22.0 (0.87)	22.0 (0.87)	22.0 (0.87)	22.0 (0.87)	55.02 (2.17)	60.96 (2.40)	102.01 (4.02)
H	45.0 (1.77)	45.0 (1.77)	45.0 (1.77)	55.0 (2.16)	35.0 (1.38)	35.0 (1.38)	35.0 (1.38)
HA	45.0 (1.77)	45.0 (1.77)	45.0 (1.77)	55.0 (2.16)	35.0 (1.38)	70.0 (2.76)	70.0 (2.76)
J	50.80 (2.00)	50.80 (2.00)	50.80 (2.00)	61.01 (2.40)	70.82 (2.79)	111.84 (4.40)	152.83 (6.02)
K	30.86 (1.22)	40.84 (1.61)	50.80 (2.00)	60.86 (2.40)	70.87 (2.79)	95.86 (3.77)	120.85 (4.76)
M	92.00 (3.62)	92.00 (3.62)	92.00 (3.62)	102.01 (4.02)	115.01 (4.53)	156.01 (6.14)	197.00 (7.76)
N	4.0	4.0	4.0	4.0	6.0	6.0	6.0
NN	2.0	2.0	2.0	2.0	3.0	4.0	5.0
Z	90.50 (3.60)	90.50 (3.60)	90.50 (3.60)	100.97 (3.97)	113.51 (4.47)	154.5 (6.08)	195.50 (7.70)
ZZ	107.99 (4.25)	107.99 (4.25)	107.99 (4.25)	118.0 (4.65)	131.00 (5.16)	172.00 (6.77)	212.99 (8.39)





PST Series  
Precision Slides



PST25 Dimensions

