

NUMATROL® II

PRODUCT OF NUMATICS, INC.

Top Dimension = Inches
Bottom Dimension
(In Parentheses) = Millimeters

SPECIFICATIONS

These oil-tight pneumatic indicators are ruggedly constructed, bushing mounted and feature a metal pressure chamber. They are nonconsumptive and provide a 2-color, 2-position, ambient lighted, fluorescent signal, visible from the front and side. They are field adjustable for either 1-input with spring return or 2-input with "memory". The memory does not require continuous pressure to maintain its last signal input. These indicators are available in a variety of color combinations and are completely compatible with Numatrol II systems.

Field conversion may be made to select either single input, spring return or 2-input, maintained modes of operation. The illustration below shows the convenient adjustment on the rear of the indicator housing. Using the same adjustment, either of the two display colors and its individual input may be selected for single input operation. In the center position, this adjustment allows the indicator to accept two inputs for a maintained ("memory") mode of operation.

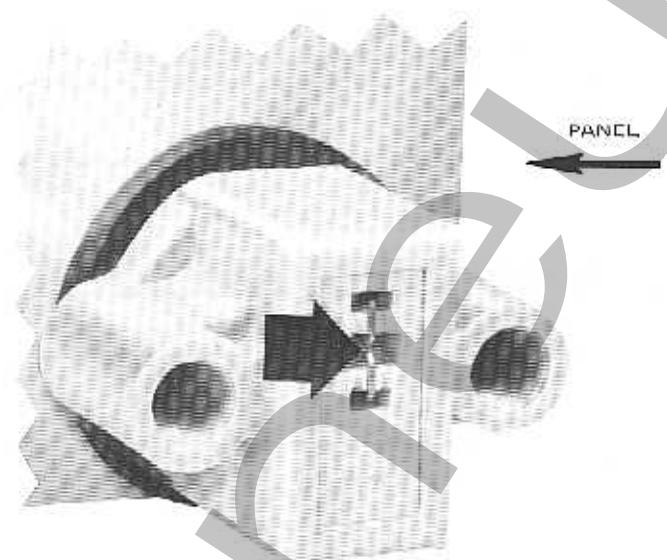
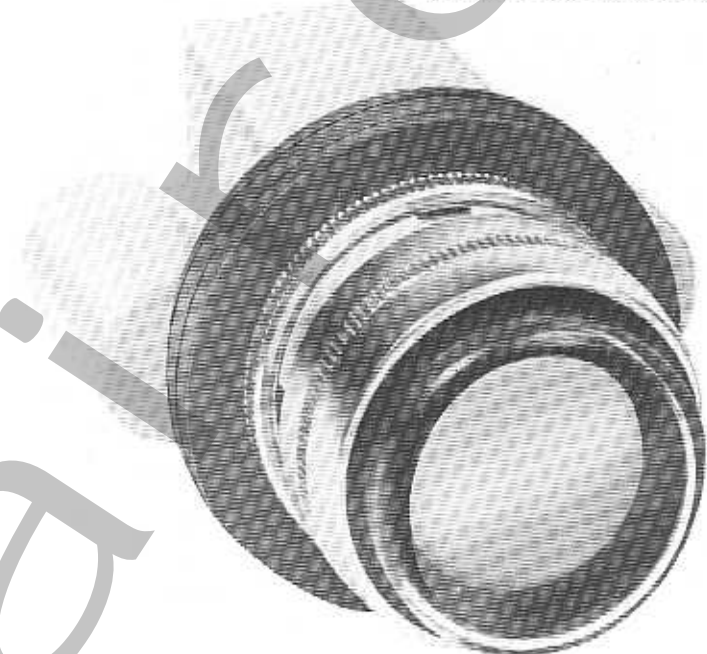

REAR VIEW
(ARROW SHOWS MODE
ADJUSTMENT CLIP)

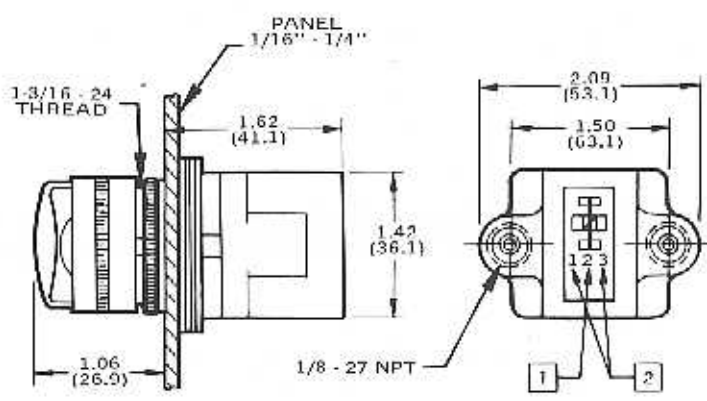

- 1 Maintained - 2 - Input with mode adjustment clip in No. 2 position.
- 2 Spring Return - Single Input with mode adjustment clip in position No. 1 or No. 3. Input same side as wire.

OPERATING DATA

PRESSURE RANGE: 50 - 150 PSIG maximum.
 TEMPERATURE RANGE: +35°F to +150°F ambient; 20°F with dry air.
 ACTUATION TIME: 1 second maximum.

MODEL SELECTION CHART

Number	Color Combination
215-156P	Red - Green
215-157P	Green - Black
215-158P	Red - Black
215-159P	Yellow - Black
215-160P	Amber - Black

CONTROL CABINETS and ACCESSORIES

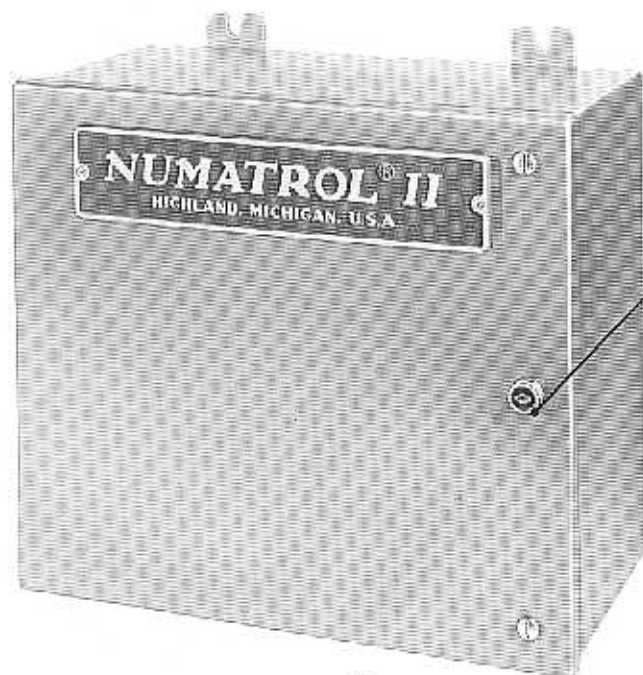

No. 137-152P
Lock and Key
Ass'y.

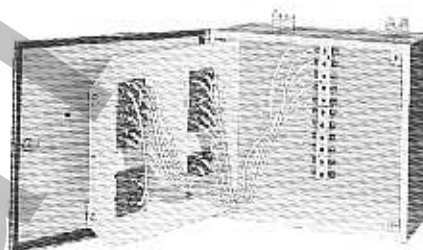
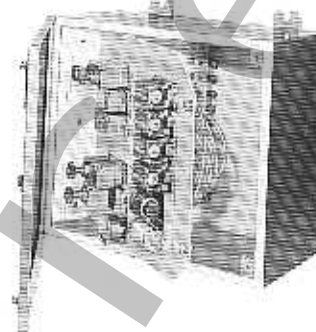

SPECIFICATIONS

Numatrol II control cabinets are specially made to house Numatrol components and facilitate installation. They are available in six convenient sizes. Each cabinet has an interior hinged panel which contains subbase mounting cutouts to fit all standard Numatrol II components. All tube connections are made behind this hinged panel, which is secured with spring-loaded screws when the circuit is complete.

The mounting cutouts in the hinged interior panel will also

accept Numatics' MARK 7 Line direct solenoid actuated valves when mounted on Numatrol II RA7 relay subbases. This permits a neat, compact housing arrangement of all power and control elements for a Numatrol II system. Consult the factory for proper ordering procedure when designing or installing a Numatrol II system.

The door of the cabinet uses spring-loaded screws and key-lock hardware. The Numatrol II nameplate shown is supplied only with complete Numatrol II systems.

MODEL SELECTION CHART

Number	Description	Number	Description	Number	Description
136-142C	8-Station Cabinet	Legend Plates, Standard inscription, .06 x .5 x 1.0" (1.5 x 12.7 x 25.4 mm):			
136-143C	12-Station Cabinet	122-162P*	RV1	122-175P*	TD4
136-144C	16-Station Cabinet	122-163P*	RV2	122-176P*	TD5
136-145C	24-Station Cabinet	122-164P*	RV3	122-177P*	S1
136-146C	30-Station Cabinet	122-165P*	RV4	122-178P*	S2
136-147C	36-Station Cabinet	122-166P*	RV5	122-179P*	S3
104-171A	Blank Station Plate	122-167P*	RV6	122-180P*	S4
122-139A	Caution Tag	122-168P*	RV7	122-181P*	S5
122-157P*	Legend Plate, .06 x .5 x 1.0" (1.5 x 12.7 x 25.4 mm), Custom inscription (1 line, 7 spaces)	122-169P*	RV8	122-182P*	S6
122-158P*	Legend Plate, .06 x 1.0 x 2.0" (1.5 x 25.4 x 50.8 mm), Custom inscription (4 lines, 16 spaces ea.)	122-170P*	RV9	122-249P*	F1
122-159P*	Legend Plate, .06 x .75 x 4.0" (1.5 x 19 x 101.6 mm), Custom inscription (3 lines, 23 spaces ea.)	122-171P*	RV10	122-250P*	F2
		122-172P*	TD1	122-251P*	R1
		122-173P*	TD2	122-252P*	R2
		122-174P*	TD3	122-253P*	R3
137-152P	Cabinet Lock and Key	* All legend plates are of Bakelite, self-bonding material.			

Top Dimension = Inches
Bottom Dimension (In Parentheses) = Millimeters

CONTROL CABINETS and ACCESSORIES

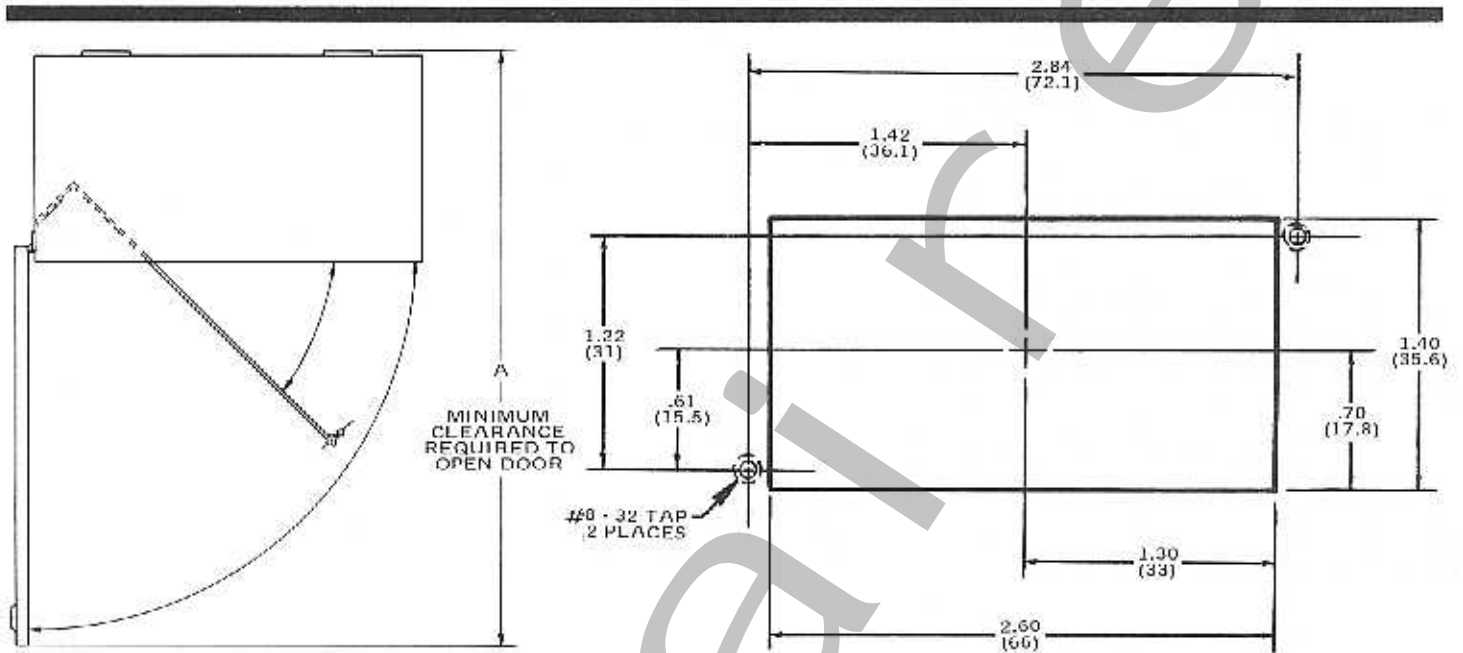

PANEL CUTOUT REQUIRED WHEN USING OTHER THAN NUMATROL CONTROL CABINETS (FULL SCALE)

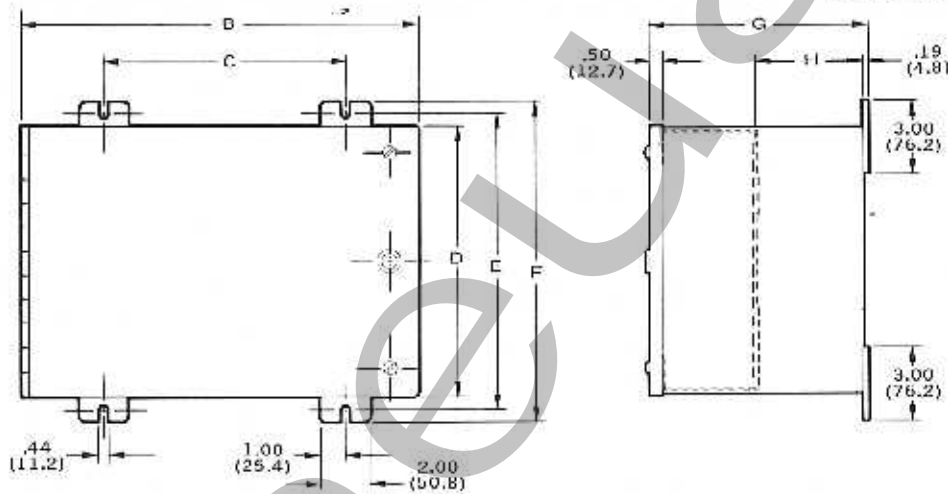

PANEL CUT-OUT ARRANGEMENT:

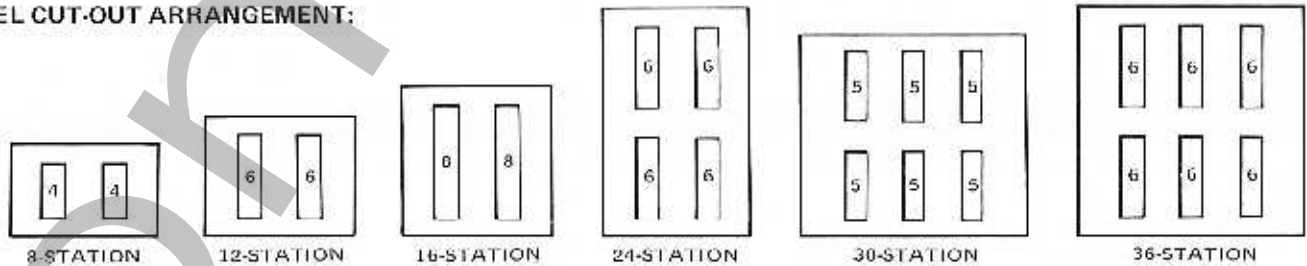

DIMENSIONS*								
SIZE	A	B	C	D	E	F	G	H
8-STATION	25.00 (635)	16.38 (416)	10.00 (254)	11.19 (284.2)	12.25 (311.1)	13.25 (336.5)	8.69 (220.7)	4.50 (114.3)
12-STATION	25.00 (635)	16.38 (416)	10.00 (254)	14.19 (360.4)	15.25 (387.3)	16.25 (412.7)	8.69 (220.7)	4.50 (114.3)
16-STATION	25.00 (635)	16.38 (416)	10.00 (254)	17.19 (436.6)	18.25 (463.5)	19.25 (488.9)	8.69 (220.7)	4.50 (114.3)
24-STATION	26.50 (673.1)	16.38 (416)	10.00 (254)	25.19 (639.8)	26.25 (666.7)	27.25 (692.1)	10.19 (258.8)	6.00 (152.4)
30-STATION	34.00 (863.6)	24.38 (619.2)	18.00 (457.2)	22.19 (563.6)	23.25 (590.5)	24.25 (615.9)	10.19 (258.8)	6.00 (152.4)
36-STATION	34.00 (863.6)	24.38 (619.2)	18.00 (457.2)	25.19 (639.8)	26.25 (666.7)	27.25 (692.1)	10.19 (258.8)	6.00 (152.4)

* Dimension in parentheses = millimeters

Top Dimension = Inches
Bottom Dimension
(In Parentheses) = Millimeters

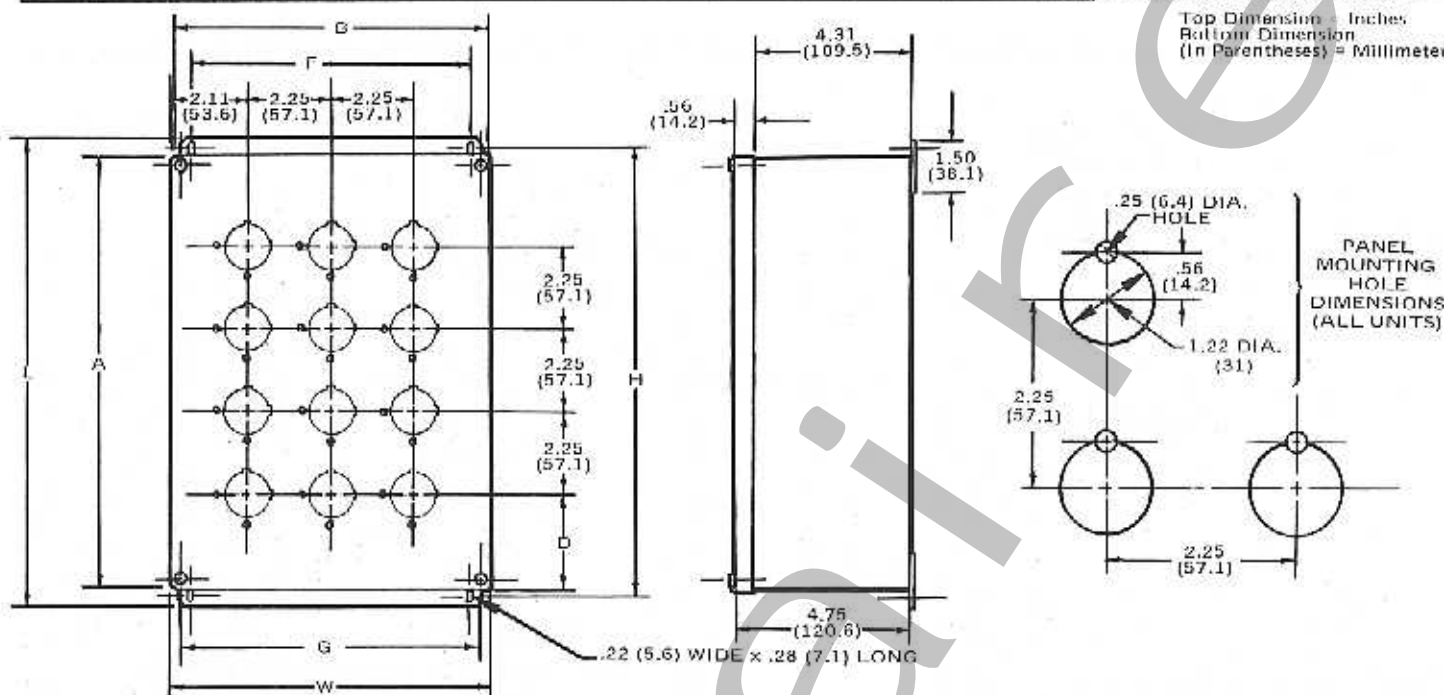

MODEL AND DIMENSION CHART

NUMBER	SIZE: A X B (TO OUTSIDE OF BOX BODY)	NO. OF HOLES	F	MOUNTING G	H	HOLE LOCATION D	OVERALL	
							I	W
136-103P	4.00 (102) x 4.00 (102)	1	3.12 (79.4)	3.75 (95.2)	4.50 (114.3)	2.11 (53.6)	5.00 (127)	4.22 (107)
136-118P	6.00 (152) x 4.00 (102)	2	3.12 (79.4)	3.75 (95.2)	6.50 (165.1)	1.51 (38.5)	7.00 (178)	4.22 (107)
136-104P	8.00 (203) x 4.00 (102)	3	3.12 (79.4)	3.75 (95.2)	8.50 (215.9)	1.86 (47.2)	9.00 (229)	4.22 (107)
136-105P	7.25 (184) x 6.25 (159)	4	5.37 (136.5)	6.00 (152.4)	7.75 (196.8)	2.61 (66.3)	8.25 (210)	6.17 (164)
136-119P	9.50 (241) x 6.25 (159)	6	5.37 (136.5)	6.00 (152.4)	10.00 (254)	2.61 (66.3)	10.50 (267)	6.17 (164)
136-106P	9.50 (241) x 8.50 (216)	9	7.62 (193.7)	8.25 (209.6)	10.00 (254)	2.61 (66.3)	10.50 (267)	8.72 (221)
136-107P	11.75 (298) x 8.50 (216)	12	7.62 (193.7)	8.25 (209.6)	12.25 (311.1)	2.61 (66.3)	12.75 (324)	8.72 (221)
136-108P	11.75 (298) x 10.75 (273)	16	9.87 (250.8)	10.50 (266.7)	12.25 (311.1)	2.61 (66.3)	12.75 (324)	10.97 (279)
136-109P	14.00 (356) x 13.00 (330)	25	12.12 (308.0)	12.75 (323.8)	14.50 (368.3)	2.61 (66.3)	15.00 (381)	13.22 (336)

HOLE ARRANGEMENT:

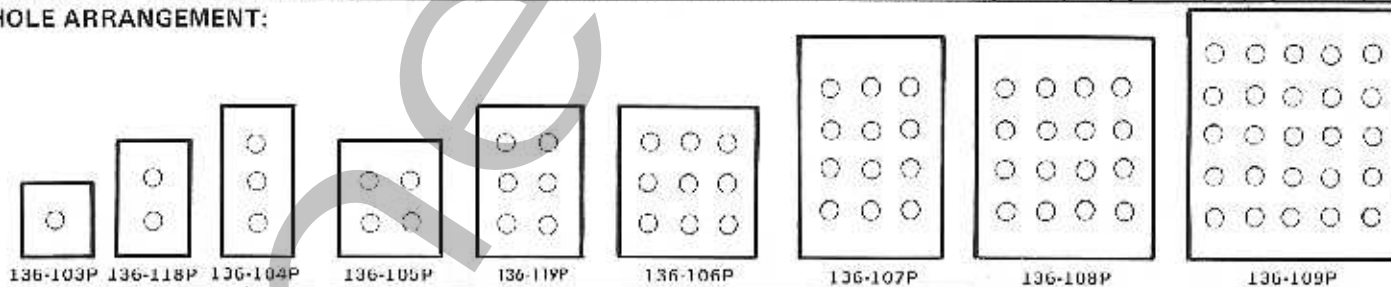

ACCESSORIES

DESCRIPTION	NUMBER	DESCRIPTION	NUMBER	DESCRIPTION	NUMBER
PUSHBUTTON NAMEPLATE STANDARD INSCRIPTION 	"CLOSE"	122-102P	"ON"	122-110P	BLANK STATION COVER
	"DOWN"	122-103P	"OPEN"	122-119P	
	"EMERG-STOP"	122-104P	"OPEN-CLOSE"	122-120P	
	"FOR-REV"	122-105P	"OUT"	122-121P	
	"FORWARD"	122-106P	"RAISE"	122-122P	
	"HAND AUTO"	122-107P	"RAISE-LOWER"	122-123P	
	"HIGH-LOW"	122-108P	"RESET"	122-124P	
	"IN"	122-109P	"REVERSE"	122-125P	
	"JOG"	122-110P	"RUN"	122-126P	
	"JOG-FOR"	122-111P	"START"	122-127P	
	"JOG-REV"	122-112P	"STOP"	122-128P	
	"JOG-RUN"	122-113P	"STOP-START"	122-129P	
	"LEFT-RIGHT"	122-114P	"TEST"	122-130P	
	"LOWER"	122-115P	"UP"	122-131P	
	"OFF"	122-116P	"UP-DOWN"	122-132P	
	"OFF-ON"	122-117P			
PUSHBUTTON NAMEPLATE CUSTOM INSCRIPTION:	ONE LINE, 13 SPACES	122-154P			
	TWO LINES, 13 SPACES EACH	122-155P			

JUNCTION BLOCK 213-229A

Provides three "I" connections and mounts in any standard panel opening.

MANIFOLD BLOCK 213-230A

Provides nine common connections and mounts in any standard panel opening.

NOTE: Both of the above assemblies use Shuttle Base No. 103-228B. Different covers provide the different connections.

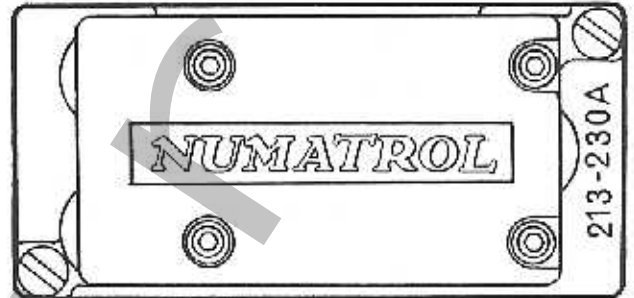

THE FOLLOWING BLOCKS MAY BE USED FOR MAKING TUBING CONNECTIONS WHEN PANEL OPENINGS ARE NOT AVAILABLE.

Junction Boxes are used for collecting tubes from various limits into one common sealrite conduit for connection to the control panel.

PARTS LIST	
DESCRIPTION*	NUMBER
JUNCTION BLOCK, 6 3-PORT STATIONS, 1/8 NPTF, 1.00 x 1.00 x 5.07 (25.4 x 25.4 x 149.1)	137-100D
JUNCTION BLOCK, 6 3-PORT STATIONS, 10-32 UNF-3B, .68 x .50 x 3.25 (22.35 x 12.25 x 82.55)	137-165D
MANIFOLD BLOCK, 8 COMMON PORTS, 1/8 NPTF, 1.00 x 1.00 x 2.00 (25.4 x 25.4 x 50.8)	137-124A
MANIFOLD BLOCK, 11 COMMON PORTS, 1/8 NPTF, 1.00 x 1.00 x 3.00 (25.4 x 25.4 x 76.2)	137-125A
JUNCTION BOX, 12.00 x 10.00 x 6.00 (304.8 x 254 x 152.4)	136-120P
JUNCTION BOX, 8.00 x 6.00 x 4.00 (203.2 x 152.4 x 101.6)	136-121P

*Dimensions in parentheses— millimeters

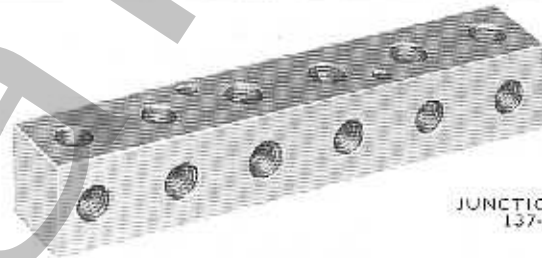

JUNCTION BLOCK
137-100B

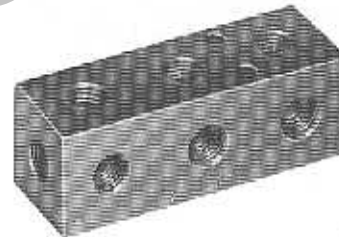

MANIFOLD BLOCK
137-125A

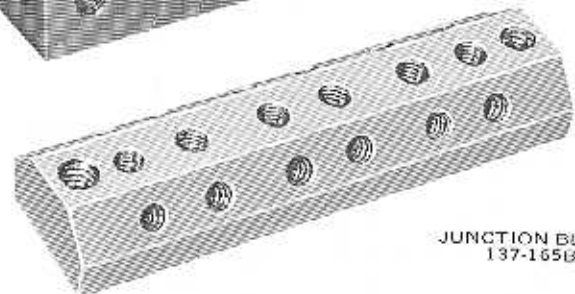

JUNCTION BLOCK
137-165B

PRESSURE INDICATOR 215-103P
(1/8 NPTF)



TEST FITTING 215-123A
(1/8 NPTF)



TEST GAGE, 20 - 120 PSIG 215-124P

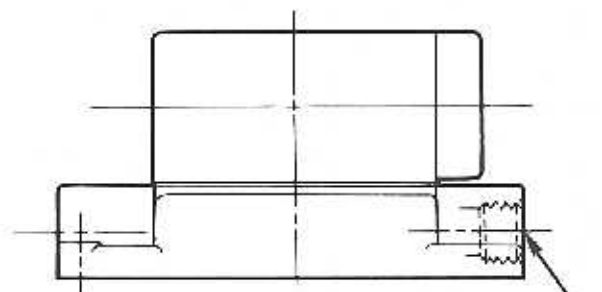

1/8 NPTF TAPPED HOLE IN EACH END IS CONNECTED TO PILOT PORTS FOR PRESSURE INDICATORS AND TEST FITTINGS.