

# 2-color Display Digital Pressure Switch



## Rated pressure

For general fluids:

**10 MPa** • **15 MPa**  
(ISE75) (ISE75H)

For air:

**1 MPa**  
(ISE70)

**Metal body type**  
(Aluminum die-cast)

2-color digital

IP67



Series **ISE70/75/75H**

## 2-color display (Green/Red)

- 4 different display settings are available.

	ON	OFF
1	Red	Green
2	Green	Red
3	Red	Red
4	Green	Green

*Abnormal conditions can be detected at a glance.*



## M12 connector

- Lead wire with M12 connector (5m)
- 2 types: Straight and right angle



Straight



Right angle



## With bracket

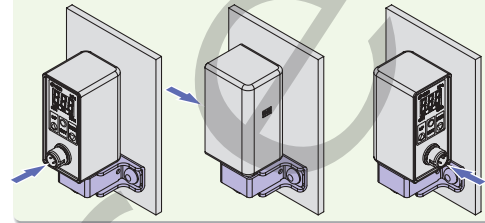

- Mounting orientation can be changed.



- Withstand pressure: Rated pressure x 3
- Type with initial display settings of PSI is also available as standard.
- Port size Rc1/4, NPT1/4, G1/4 (ISO1179)

## Functions

- Anti-chattering
- Display calibration
- Zero clear
- Key lock
- Unit conversion (fixed with SI units inside Japan)

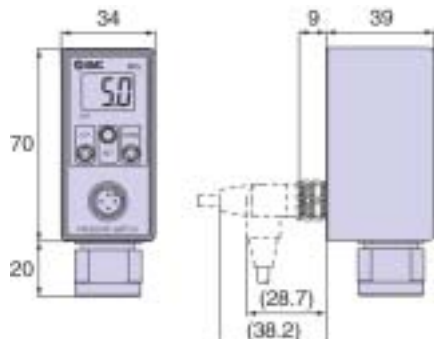
Model	ISE70	ISE75	ISE75H
	 Solid color	 Gray	 Orange
Rated pressure range	0 to 1MPa	0 to 10MPa	0 to 15MPa
Applicable fluids	Air, Non-corrosive gas Non-flammable gas	Fluids that do not corrode stainless steel SUS430 and SUS630	
Range of fluid temperatures*	0 to 50°C	-5 to 80°C	
Set pressure resolution	0.01MPa	0.1MPa	
Output type	1 setting - NPN open collector -1 output + PNP open collector -1 output		
Dimensions			

\* With no condensation or freezing