

**One-touch fitting (With built-in self-seal mechanism) to prevent air exhaust when removing tube.**

**Best for multiple use areas when pressure cannot be shut down.**

**10 types are available.**

**Electroless nickel plated-for copper-free applications.**

### Applicable Tubes

Tube material	Nylon, Soft nylon, Polyurethane
Tube O.D.	ø4, ø6, ø8, ø10, ø12

### Specifications

Operating fluid	Air	
Max. operating pressure	145psi {1.0MPa}	
Proof pressure	435psi {3.0MPa}	
Ambient and fluid temperature	32 to 140°F {5 to 60°C}	
Thread	Thread portion	JIB B 0203 (Taper pipe thread)
	Nut	JIB B 0211 Class 2 (Metric fine thread)
Sealant (Thread portion)	With sealant (Standard)	
Copper-free application	C3604BD Parts with electroless nickel plating	

### Principal Element Material

Body	C3604BD, PBT
Stud	C3604BD (Thread portion)
Chuck, Spring	Stainless Steel (SUS304)
Guide	C3604BD Polyacetal (POM)
Collet, Release button	Polyacetal (POM)
Valve, Retainer	Polyacetal (POM)
Stopper	C3604BD, Polyacetal (POM)
Packing, O-ring	NBR

# Series KC

## Self-seal Fittings

### Model

#### Half union

**KCH** P. 76



Use to pipe in the same direction from female thread portion.

#### Straight

**KCH** P. 77



Use to connect tubes in the same direction. One of two ports has a self-seal function.

#### Elbow union

**KCL** P. 76



Use to pipe at right angle to female thread portion. Most general type.

#### Straight plug for frequent use

**KCH** P. 77



Use to connect a self-seal fitting and a tube in the same direction. It can save the tube cutting labor in the case of frequent tube installation and removal.

#### Tee

**KCT** P. 76



Use to branch connection of tubes of both side 90° direction.

#### Elbow plug for frequent use

**KCL** P. 78



Use to pipe a tube at right angle to a self-seal fitting. It can save the tube cutting labor in the case of frequent tube installation and removal.

#### Union "Y"

**KCU** P. 76



Use to branch connection of tubes in the same direction. 2 branched ports has a self-seal function.

#### Check adaptor

**KCJ** P. 77



Use to add the self-seal mechanism to a usual one-touch fittings, Series KQ.

#### Bulkhead union

**KCE** P. 77



Use to junction connection of tubes for installation of panel. One of two ports has a self-seal function.

#### Bulkhead female union

**KCE** P. 77

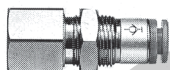

Use for transit connection of a tube and a male screw for installation of panel.

# Series KC

## Self-seal Fittings

### Half union: KCH



Applicable tube O.D. (mm)	Thread R(PT)	Part No.	H (Hex.)	L	A*	M	Effective orifice(mm <sup>2</sup> )		Weight (g)
							Nylon	Urethane	
4	M5×0.8	<b>KCH04-M5</b>	9.8	30.8	27.3	18	2.1	2.1	8
	1/8	<b>KCH04-01S</b>	10	26.1	22.1		2.6	2.6	
6	M5×0.8	<b>KCH06-M5</b>	11.8	32.4	28.9	19.5	2.4	2.4	10
	1/8	<b>KCH06-01S</b>	12	37.4	33.4		6.8	6.8	16
	1/4	<b>KCH06-02S</b>	14	28.9	22.9		19	6.8	6.8
8	1/8	<b>KCH08-01S</b>	14	42.4	38.4	21.5	16.2	13.1	20
	1/4	<b>KCH08-02S</b>		45.7	39.7				27
	3/8	<b>KCH08-03S</b>		17	34				27.5
10	1/4	<b>KCH10-02S</b>	17	50.5	44.5	24	25.6	20.4	34
	3/8	<b>KCH10-03S</b>		51.5	45				43
	3/8	<b>KCH12-03S</b>		19	54.2				47.7
12	1/2	<b>KCH12-04S</b>	22	41.6	33.6	25.5	35.4	30.4	41

\* Reference dimensions after R(PT) installation.

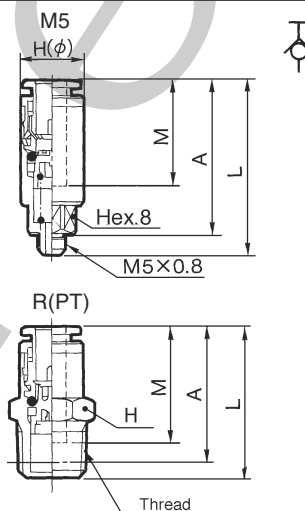

### Elbow union: KCL

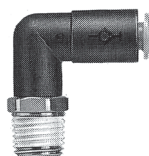

Applicable tube O.D. (mm)	Thread R(PT)	Part No.	H (Hex.)	øD1	øD2	L1	L2	A*	M	Effective orifice(mm <sup>2</sup> )		Weight (g)	
										Nylon	Urethane		
4	M5×0.8	<b>KCL04-M5</b>	8	10.4	8	25.3	16.7	18.4	18	1.9	1.9	6	
	1/8	<b>KCL04-01S</b>	10		10	23	24.2	2.3		2.3	11		
6	M5×0.8	<b>KCL06-M5</b>	8	12.8	8	26.8	17.4	20.3	19.5	2.2	2.2	7	
	1/8	<b>KCL06-01S</b>	12		12	28	25.1	27.5		6.2	6.2	13	
	1/4	<b>KCL06-02S</b>	14		12	28	29.1	29.5		19	6.2	6.2	21
8	1/8	<b>KCL08-01S</b>	14	15.2	14	34.1	27.1	30.7	21.5	13.0	10.5	16	
	1/4	<b>KCL08-02S</b>					31.1	32.7				24	29
	3/8	<b>KCL08-03S</b>					17	31.1				34.2	24
10	1/4	<b>KCL10-02S</b>	17	18.5	17	38	33.9	37.2	24	19.5	16.5	29	
	3/8	<b>KCL10-03S</b>					35.9	38.7				38	
	3/8	<b>KCL12-03S</b>					22	40.3				44.3	25.5
12	1/2	<b>KCL12-04S</b>	22	20.9	20.9	40.7	43.2	45.7	25.5	24.8	21.3	81	

\* Reference dimensions after R(PT) installation.

Note) øD1: max. diameter

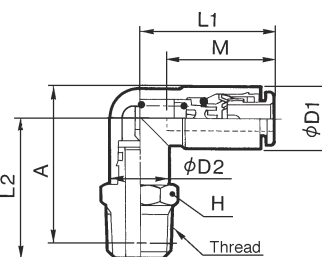

### Tee: KCT



Applicable tube O.D. (mm)	Part No.	øD	L	Q	M	Effective orifice(mm <sup>2</sup> )		Weight (g)
						Nylon	Urethane	
4	<b>KCT04-00</b>	10.4	28.6	5.3	18	2.8	2.8	9
6	<b>KCT06-00</b>	12.8	32.7	6.1	19	7.6	7.6	16
8	<b>KCT08-00</b>	15.2	39.2	7.1	21.5	13.7	11.1	24
10	<b>KCT10-00</b>	18.5	45.5	7.9	24	21.1	19.0	39
12	<b>KCT12-00</b>	20.9	49.2	8.6	25.5	28.3	24.3	52

Note) øD: max. diameter

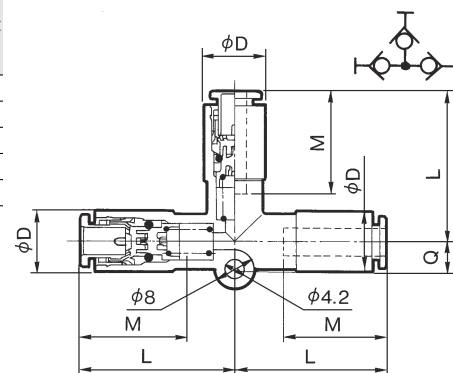

### Union "Y": KCU



Applicable tube O.D. (mm)	Part No.	øD	L1	L2	P	Q	M1	M2	Effective orifice(mm <sup>2</sup> )		Weight (g)
									Nylon	Urethane	
4	<b>KCU04-00</b>	10.4	43.1	27.3	10.4	10.6	18	16	3.7	3.7	9
6	<b>KCU06-00</b>	12.8	48	31.2	12.8	12.5	19	17	10.0	10.0	15
8	<b>KCU08-00</b>	15.2	57.6	38.9	15.2	14.7	21.5	18.5	21.7	15.1	23
10	<b>KCU10-00</b>	18.5	65.2	44.9	18.5	17.1	24	21	33.3	25.6	37
12	<b>KCU12-00</b>	20.9	70.1	48.8	20.9	19.1	25.5	22	48.9	38.7	49

Note) øD: max. diameter

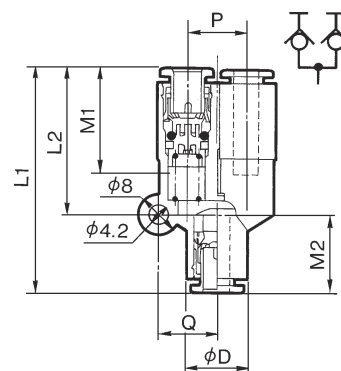

Self-seal Fittings

Check adaptor: KCJ



Applicable tube O.D. (mm)	Part No.	ød	øD	L	A	M	Effective orifice(mm <sup>2</sup> )		Weight (g)
							Nylon	Urethane	
4	KCJ04-99	4	9.8	49.5	33.5	18	2.6	2.6	9
6	KCJ06-99	6	11.8	54	37	19	6.8	6.8	13
8	KCJ08-99	8	14	61	42.5	21.5	16.2	13.1	20
10	KCJ10-99	10	17	70.4	49.4	24	25.6	20.4	33
12	KCJ12-99	12	19	74.4	52.4	25.5	35.4	30.4	43

Note) øD: max. diameter

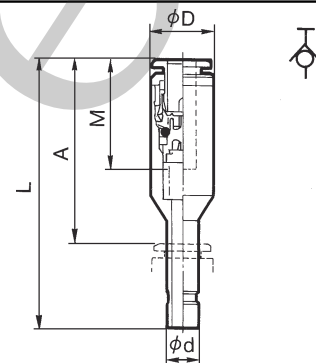

Bulkhead union: KCE

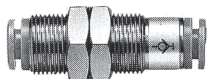

Applicable tube O.D. (mm)	Part No.	T (M)	H (Hex.)	L	Mounting hole	M1	M2	Effective orifice(mm <sup>2</sup> )		Weight (g)
								Nylon	Urethane	
4	KCE04-00	M12×1	14	42	13	18	16	2.6	2.6	21
6	KCE06-00	M14×1	17	45.5	15	19	17	6.8	6.8	30
8	KCE08-00	M16×1	19	52.5	17	21.5	18.5	16.2	13.1	39
10	KCE10-00	M20×1	24	59.5	21	24	21	25.6	20.4	84
12	KCE12-00	M22×1	27	63.2	23	25.5	22	35.4	30.4	115

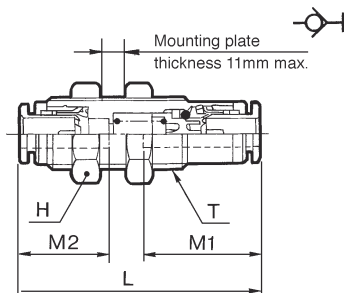

Bulkhead female union: KCE

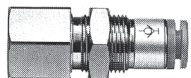

Applicable tube O.D. (mm)	Thread Rc (PT)	Part No.	T (M)	H1 (Hex.)	H2 (Hex.)	L1	L2	Mounting hole	M	Effective orifice(mm <sup>2</sup> )		Weight (g)
										Nylon	Urethane	
4	1/4	KCE04-02	M12×1	17	14	40.5	14.7	13	18	2.6	2.6	32
6	1/4	KCE06-02	M14×1	17	17	42.7	14.7	15	19	6.8	6.8	36
8	3/8	KCE08-03	M16×1	19	19	49.4	15	17	21.5	16.2	13.1	42
10	3/8	KCE10-03	M20×1	22	24	53.9	14.2	21	24	25.6	20.4	79
12	3/8	KCE12-03	M22×1	24	27	56.1	13.7	23	25.5	35.4	30.4	105

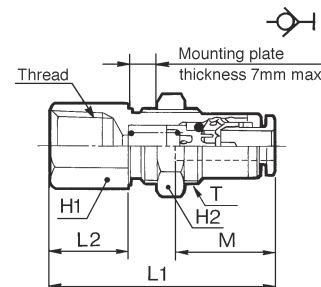

Straight: KCH

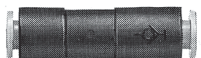

Applicable tube O.D. (mm)	Part No.	øD	L	M1	M2	Effective orifice(mm <sup>2</sup> )		Weight (g)
						Nylon	Urethane	
4	KCH04-00	10.4	42.1	18	16	2.6	2.6	5
6	KCH06-00	12.8	45.8	19	17	6.8	6.8	8
8	KCH08-00	15.2	52.8	21.5	18.5	16.2	13.1	11
10	KCH10-00	18.5	59.8	24	21	25.6	20.4	18
12	KCH12-00	20.9	63.5	25.5	22	35.4	30.4	24

Note) øD: max. diameter

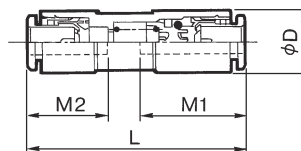

Straight plug for frequent use: KCH



Applicable tube O.D. (mm)	Part No.	ød	øD	L	A	M	Effective orifice(mm <sup>2</sup> )		Weight (g)
							Nylon	Urethane	
4	KCH04-99	4	9.8	40.6	22.6	16	5.6	5.6	5
6	KCH06-99	6	11.8	43.1	24.1	17	13.1	13.1	8
8	KCH08-99	8	14	46.7	25.2	18.5	26.1	18.0	11
10	KCH10-99	10	17	52.6	28.6	21	41.5	29.5	18
12	KCH12-99	12	19	54.9	29.4	22	58.3	46.1	24

Note) øD: max. diameter

