



Air Fittings

Fitting Series For Special Environment

- **Series KR (Flame Resistant One Touch)**
Inch/Metric Pgs. 110-117
- **Series KRM (Flame Resistant One Touch Manifold)**
Metric Pgs. 118-119
- **Series KG (Stainless Steel One Touch)**
Metric Pgs. 120-130
- **Series MS (Stainless Steel Barb)**
Metric Pgs. 131-134
- **Series KA (Anti-static One Touch)**
Inch/Metric Pgs. 135-139

Series KR

Flame Resistant One-touch Fittings

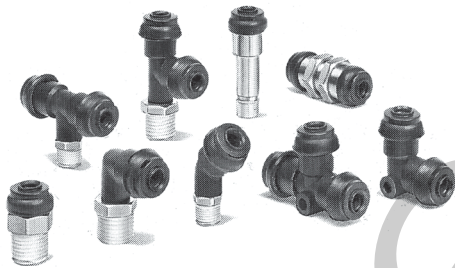
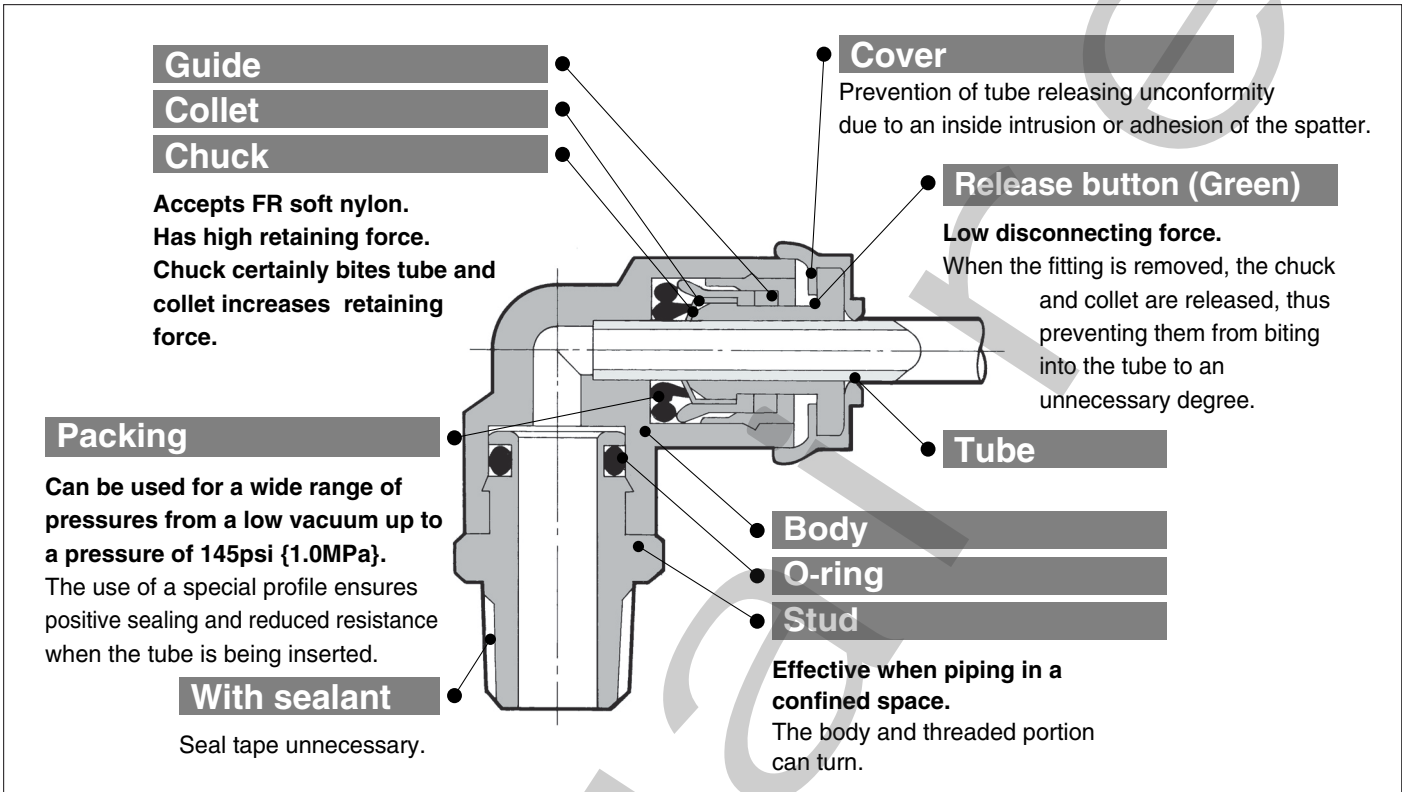

Applicable Tube

Tube material	FR soft nylon
Tube O.D.	ø6, ø8, ø10, ø12

Specifications

Operating fluid		Air, Water ^{Note1)}
Max. operating pressure		145psi {1.0MPa}
Proof pressure		435psi {3.0MPa}
Ambient and fluid temperature		32 to 140°F {0 to 60°C}
		Water 41 to 104°F {5 to 40°C}
Thread	Thread portion	JIS B 0203 (Taper pipe thread)
	Nut	JIS B 0211 Class 2 (Metric fine thread)
Sealant (Thread portion)		With sealant (Standard)

Note1) Applicable for general industry water. Consult P/A if using for other kind of fluid.
Surge pressure must be under the max. operating pressure.

Principal Element Material

Body	C3604BD, Flame resistance PBT (UL standard V-0)
Stud (Thread)	C3604BD
Chuck	Stainless steel (SUS304)
Guide	C3604BD, Flame resistance PBT (UL standard V-0)
Collet	Polyacetal (POM)
Release button	Flame resistance PBT (UL standard V-0)
Packing, O-ring	NBR
Cover	Flame resistance CR (UL standard V-0)













Fittings are supplied without cover, order cover separately.

Two types of covers:

- 1. Single layer tubing Cap — KR-**C Tubing — TRS
- 2. Double layer tubing Cap — ?????? Tubing — TRB

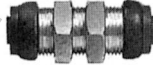
Flame Resistant One-touch Fittings

Series KR

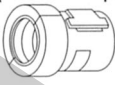
Model					
<p>Male connector KRH P. 112</p> 	<p>Use to pipe in the same direction from female threaded portion. Most general type.</p>	<p>Union elbow KRL P. 113</p> 	<p>Use to connect tubes in right angle.</p>	<p>Male run tee KRY P. 114-115</p> 	<p>Use to branch connection of tubes with size down in both side 90° direction.</p>
<p>Straight union KRH P. 116</p> 	<p>Use to connect tubes in the same direction.</p>	<p>Extended male elbow KRW P. 117</p> 	<p>The most appropriate use is when the elbow extends over a standard elbow for ease of tubing connection/disconnection.</p>	<p>Plug-in reducer KRR P. 115</p> 	<p>Use to a size down of one-touch fitting.</p>
<p>Male elbow KRL P. 112-113</p> 	<p>Use to pipe in right angle to female threaded portion. Most general type.</p>	<p>Branch tee KRT P. 114</p> 	<p>Use to branch line from female thread of both side 90° direction.</p>	<p>Bulkhead union KRE P. 115</p> 	<p>Used to connect two tubes through a panel.</p>
<p>45° male elbow KRK P. 117</p> 	<p>Used in applications where a 90° elbow or male connector stresses the tubing.</p>	<p>Union tee KRT P. 113</p> 	<p>Use to branch connection of tubes of both side 90° direction.</p>	<p>Plug KRP P. 116</p> 	<p>Use to shut no use one-touch fitting.</p>
<p>Spatter cover (TIRS/TIR) KR P. 116</p> 	<p>Prevention of tube releasing unconformity due to an inside intrusion or adhesion of the spatter.</p>	<p>Spatter cover (TRB) KR P. 116</p> 	<p>Prevention of tube releasing unconformity due to an inside intrusion or adhesion of the spatter.</p>		

Note: Spatter cover does not come standard with KR Series Fittings. They must be ordered separately.

Series KR

Flame Resistant One-touch Fittings

Male connector: KRH Inch



Applicable tube O.D. (Inch)	Thread NPT	Part No.	H (Hex.)	ØD	L	*A	M	Min. hole dia.	Wt. (gf)	
1/4	1/8	KRH07-34S	9/16 (14.29)	0.63 (16)	0.96 (24.5)	0.81 (20.5)	0.75 (19)	0.18 (4.6)	11	
	1/4	KRH07-35S			0.98 (25)	0.75 (19)			16	
	3/8	KRH07-36S			11/16 (17.46)	0.73 (18.5)			28	
3/8	1/4	KRH11-35S	11/16 (17.46)	0.80 (20.3)	1.40 (35.5)	1.16 (29.5)	0.91 (23)	0.28 (7)	32.5	
	3/8	KRH11-36S			1.22 (31)	0.96 (24.5)			30.5	
	1/2	KRH11-37S			7/8 (22.23)	1.14 (29)			0.83 (21)	47.5
1/2	1/4	KRH13-35S	7/8 (22.23)	0.96 (24.3)	1.44 (36.5)	1.20 (30.5)	0.94 (24)	0.35 (9)	45.7	
	3/8	KRH13-36S			1.40 (35.5)	1.14 (29)				0.38 (9.6)
	1/2	KRH13-37S			1.26 (32)	0.94 (24)				

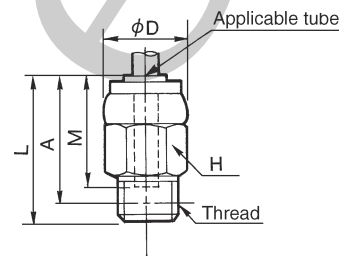

Note: Fitting cover ordered separately.

KRH Metric

Applicable tube O.D. (mm)	Thread R(PT)	Part No.	H (Hex.)	øD	L	A*	M	Effective orifice (mm ²)	Weight (g)
6	1/8	KRH06-01S	12	15.5	24.5	20.5	19	5.7	10.8
	1/4	KRH06-02S	14		25	19			15.8
	3/8	KRH06-03S	17		18.5	27.8			
8	1/8	KRH08-01S	14	17	30	26	20.5	18.0	21.9
	1/4	KRH08-02S	17		28.5	22.5			19.9
	3/8	KRH08-03S	17		25.5	19			26.9
10	1/8	KRH10-01S	17	20.8	32	28	23	29.5	20.3
	1/4	KRH10-02S			35.5	29.5			31.3
	3/8	KRH10-03S			31	24.5			54.3
	1/2	KRH10-04S			29	21			
12	1/4	KRH12-02S	19	22.8	36.5	30.5	24	46.1	43.5
	3/8	KRH12-03S	35		28.5	35.5			
	1/2	KRH12-04S	32		24	52.5			

* Reference dimensions after R(PT) thread installation.

Note: Fitting cover ordered separately.

Male elbow: KRL Inch



Applicable tube O.D. (Inch)	Thread NPT	Part No.	H (Hex.)	øD ₁	øD ₂	L ₁	L ₂	*A	M	Min. hole dia.	Wt. (gf)
1/4	1/8	KRL07-34S	7/16 (11.11)	0.68 (17.2)	0.39 (10)	0.89 (22.5)	0.93 (23.5)	1.10 (28)	0.75 (19)	0.18 (4.6)	11
	1/4	KRL07-35S	9/16 (14.29)				1.08 (27.5)	1.18 (30)			21
	3/8	KRL07-36S	11/16 (17.46)				1.16 (29.5)	1.24 (31.5)			33
3/8	1/4	KRL11-35S	11/16 (17.46)	0.89 (22.7)	0.67 (17)	1.10 (28)	1.16 (29.5)	1.38 (35)	0.91 (23)	0.28 (7)	24.5
	3/8	KRL1136S					1.24 (31.5)	1.44 (36.5)			34.5
	1/2	KRL11-37S					1.40 (35.5)	1.54 (39)			60.5
1/2	1/4	KRL13-35S	11/16 (17.46)	1.04 (26.5)	0.67 (17)	1.22 (31)	1.24 (31.5)	1.54 (39)	0.94 (24)	0.35 (9)	29.7
	3/8	KRL13-36S					1.32 (33.5)	1.61 (41)			37.7
	1/2	KRL13-37S					7/8 (22.23)	1.48 (37.5)			1.67 (42.5)

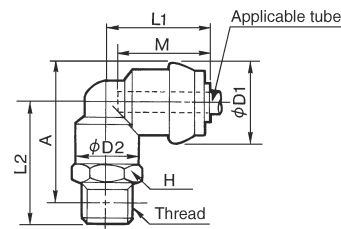

Note: Fitting cover ordered separately.

Flame Resistant One-touch Fittings

Male elbow: KRL Metric

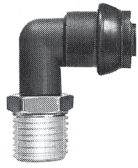

Applicable tube O.D.(mm)	Thread R(PT)	Part No.	H (Hex.)	øD1	øD2	L1	L2	A*	M	Effective orifice(mm ²)	Weight (g)
6	1/8	KRL06-01S	10	16.8	10	22	23	27.5	19	5.0	12.8
	1/4	KRL06-02S	14				27	29.5			10.8
	3/8	KRL06-03S	17				29	31			33.8
8	1/8	KRL08-01S	12	19.2	12	25	24.5	30	20.5	14.9	13.9
	1/4	KRL08-02S	14				28.5	32			21.9
	3/8	KRL08-03S	17				30.5	33.5			35.9
10	1/8	KRL10-01S	17	23.3	17	28.5	27	34.4	23	25.0	26.3
	1/4	KRL10-02S					30	35.4			27.3
	3/8	KRL10-03S					32	36.9			37.3
	1/2	KRL10-04S					36	39.4			64.3
12	1/4	KRL12-02S	17	25.7	17	30.5	31	37.9	24	39.7	29.5
	3/8	KRL12-03S					33	39.4			39.5
	1/2	KRL12-04S					37	41.9			66.5

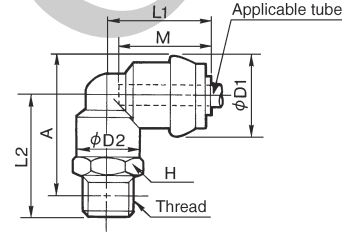

* Reference dimensions after R(PT) thread installation.
Note: Fitting cover ordered separately.

Union elbow: KRL Inch



Applicable tube O.D. (inch)	Part No.	øD	L	Q	M	Min. hole Dia.	Wt. (gf)
1/4	KRL07-00	0.68 (17.2)	0.89 (22.5)	0.21 (5.3)	0.75 (19)	0.18 (4.6)	8
3/8	KRL11-00	0.89 (22.7)	1.10 (28)	0.26 (6.6)	0.91 (23)	0.28 (7)	16
1/2	KRL13-00	1.04 (26.5)	1.22 (31)	0.31 (7.8)	0.94 (24)	0.38 (9.6)	21.4

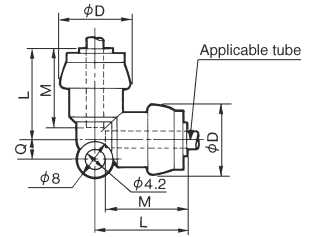

Note: Fitting cover ordered separately.

KRL Inch

Applicable tube O.D.(mm)	Part No.	øD	L	Q	M	Effective orifice(mm ²)	Weight (g)
6	KRL06-00	16.8	22	5.3	19	5.0	8.6
8	KRL08-00	19.2	25	6	20.5	14.9	12.8
10	KRL10-00	23.3	28.5	6.8	23	25.0	19.6
12	KRL12-00	25.7	30.5	7.5	24	39.7	24

Note: Fitting cover ordered separately.

Union tee: KRT Inch



Applicable tube O.D. (inch)	Part No.	øD	L	Q	M	Min. hole dia.	Wt. (gf)
1/4	KRT07-00	0.68 (17.2)	0.89 (22.5)	0.21 (5.3)	0.75 (19)	0.18 (4.6)	12
3/8	KRT11-00	0.89 (22.7)	1.10 (28)	0.26 (6.6)	0.91 (23)	0.28 (7)	22.5
1/2	KRT13-00	1.04 (26.5)	1.22 (31)	0.31 (7.8)	0.94 (24)	0.38 (9.6)	31.1

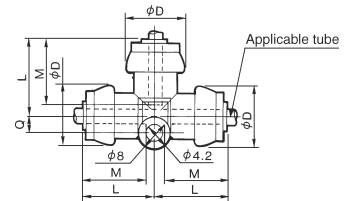

Note: Fitting cover ordered separately.

KRT Metric

Applicable tube O.D.(mm)	Part No.	øD	L	Q	M	Effective orifice (mm ²)	Weight (g)
6	KRT06-00	16.8	22	5.3	19	5.8	13.4
8	KRT08-00	19.2	25	6	20.5	17.7	18.7
10	KRT10-00	23.3	28.5	6.8	23	28.4	28.9
12	KRT12-00	25.7	30.5	7.5	24	45.4	32

Note: Fitting cover ordered separately.

Series KR

Flame Resistant One-touch Fittings

Branch tee: KRT Inch



Applicable tube O.D. (inch)	Thread NPT	Part No.	H (Hex.)	øD ₁	øD ₂	L ₁	L ₂	*A	M	Min. hole dia.	Wt. (gf)
1/4	1/8	KRT07-34S	⁷ / ₁₆ (11.11)	0.68 (17.2)	0.39 (10)	0.89 (22.5)	0.93 (23.5)	1.10 (28)	0.75 (19)	0.18 (4.6)	14
	1/4	KRT07-35S	⁹ / ₁₆ (14.29)				1.08 (27.5)	1.18 (30)			24
	3/8	KRT07-36S	¹¹ / ₁₆ (17.46)				1.16 (29.5)	1.24 (31.5)			37
3/8	1/4	KRT11-35S	¹¹ / ₁₆ (17.46)	0.89 (22.7)	0.67 (17)	1.10 (28)	1.16 (29.5)	1.38 (35)	0.91 (23)	0.28 (7)	32
	3/8	KRT11-36S	¹¹ / ₁₆ (17.46)				1.24 (31.5)	1.44 (36.5)			41
	1/2	KRT11-37S	⁷ / ₈ (22.23)				1.40 (35.5)	1.54 (39)			67
1/2	1/4	KRT13-35S	¹¹ / ₁₆ (17.46)	1.04 (26.5)	0.67 (17)	1.22 (31)	1.24 (31.5)	1.54 (39)	0.94 (24)	0.35 (9)	37.4
	3/8	KRT13-36S	¹¹ / ₁₆ (17.46)				1.32 (33.5)	1.61 (41)			46.4
	1/2	KRT13-37S	⁷ / ₈ (22.23)				1.48 (37.5)	1.67 (42.5)			72.4

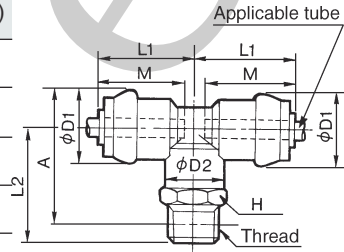

Note: Fitting cover ordered separately.

KRT Metric

Applicable tube O.D.(mm)	Thread R(PT)	Part No.	H (Hex.)	øD ₁	øD ₂	L ₁	L ₂	A*	M	Effective orifice(mm ²)	Weight (g)
6	1/8	KRT06-01S	10	16.8	10	22	23	27.5	19	6.0	13.8
	1/4	KRT06-02S	14				27	29.5			21.8
	3/8	KRT06-03S	17				29	31			35.8
8	1/8	KRT08-01S	12	19.2	12	25	24.5	30	20.5	18.2	15.9
	1/4	KRT08-02S	14				28.5	32			23.9
	3/8	KRT08-03S	17				30.5	33.5			37.9
10	1/8	KRT10-01S	17	23.3	17	28.5	27	34.5	23	29.0	32.5
	1/4	KRT10-02S					30	35.5			30.3
	3/8	KRT10-03S					32	37			40.3
	1/2	KRT10-04S					22	36			39.5
12	1/4	KRT12-02S	17	25.7	17	30.5	31	38	24	45.2	32.5
	3/8	KRT12-03S					33	39.5			42.5
	1/2	KRT12-04S					22	37			42

* Reference dimensions after R(PT) thread installation.

Note: Fitting cover ordered separately.

Male run tee: KRY Inch



Applicable tube O.D. (inch)	Thread NPT	Part No.	H (Hex.)	øD ₁	øD ₂	L ₁	L ₂	*A	M	Min. hole dia.	Wt. (gf)
1/4	1/8	KRY07-34S	⁷ / ₁₆ (11.11)	0.68 (17.2)	0.39 (10)	0.89 (22.5)	0.93 (23.5)	1.65 (42)	0.75 (19)	0.18 (4.6)	14
	1/4	KRY07-35S	⁹ / ₁₆ (14.29)				1.08 (27.5)	1.73 (44)			24
	3/8	KRY07-36S	¹¹ / ₁₆ (17.46)				1.16 (29.5)	1.79 (45.5)			37
3/8	1/4	KRY11-35S	¹¹ / ₁₆ (17.46)	0.89 (22.7)	0.67 (17)	1.10 (28)	1.16 (29.5)	2.03 (51.5)	0.91 (23)	0.28 (7)	32
	3/8	KRY11-36S	¹¹ / ₁₆ (17.46)				1.24 (31.5)	2.09 (53)			41
	1/2	KRY11-37S	⁷ / ₈ (22.23)				1.40 (35.5)	2.19 (55.5)			67
1/2	1/4	KRY13-35S	¹¹ / ₁₆ (17.46)	1.04 (26.5)	0.67 (17)	1.22 (31)	1.24 (31.5)	2.22 (56.5)	0.94 (24)	0.38 (9.6)	37.4
	3/8	KRY13-36S	¹¹ / ₁₆ (17.46)				1.32 (33.5)	2.28 (58)			46.4
	1/2	KRY13-37S	⁷ / ₈ (22.23)				1.48 (37.5)	2.38 (60.5)			72.4

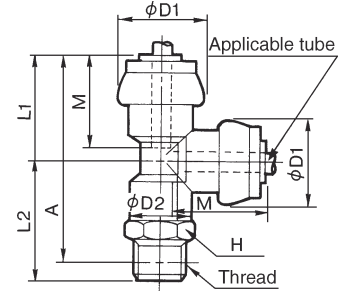

Note: Fitting cover ordered separately.

Male run tee: KRY Metric



Applicable tube O.D.(mm)	Thread R(PT)	Part No.	H (Hex.)	øD1	øD2	L1	L2	A*	M	Effective orifice(mm ²)	Weight (g)
6	1/8	KRY06-01S	10	16.8	10	22	23	41	19	5.8	14.6
	1/4	KRY06-02S	14				27	43			22.6
	3/8	KRY06-03S	17				29	44.4			36.6
8	1/8	KRY08-01S	12	19.2	12	25	24.5	45.5	20.5	17.7	16.8
	1/4	KRY08-02S	14				28.5	47.5			24.8
	3/8	KRY08-03S	17				30.5	49			38.8
10	1/8	KRY10-01S	17	23.7	17	28.5	27	51.5	23	28.4	32.3
	1/4	KRY10-02S					30	52.5			31.6
	3/8	KRY10-03S					32	54			41.6
	1/2	KRY10-04S					36	56.5			68.6
12	1/4	KRY12-02S	17	25.7	17	30.5	31	55.5	24	45.4	34
	3/8	KRY12-03S					33	57			44
	1/2	KRY12-04S					37	59.5			71

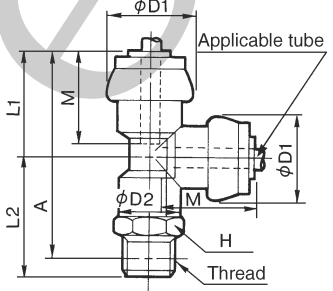

* Reference dimensions after R(PT) thread installation.
 Note: Fitting cover ordered separately.

Plug-in reducer: KRR Inch



Applicable tube O.D. (inch)	Size ød	Part No.	øD	L ₁	A	M	Min. hole dia.	Wt. (gf)
1/4	3/8	KRR07-11	0.63 (16)	1.65 (42)	0.79 (20)	0.75 (19)	0.18 (4.6)	20
	1/2	KRR07-13	0.63 (16)	1.65 (42)	0.71 (18)	0.91 (23)		28
1/4	1/2	KRR11-13	0.82 (20.8)	1.83 (46.5)	0.89 (22.5)	0.94 (24)	0.28 (7)	33.5

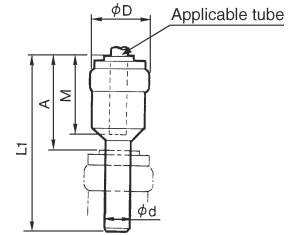

Note: Fitting cover ordered separately.

KRR Metric

Applicable tube O.D.(mm)	Applicable fitting size ød	Part No.	øD	L ₁	A	M	Effective orifice(mm ²)	Weight (g)
6	8	KRR06-08	16.8	39	18.5	19	5.7	3.9
	10	KRR06-10						4.4
8	10	KRR08-10	19.2	41.5	18.5	20.5	18.0	5.5
	12	KRR08-12		43	20			6.1
10	12	KRR10-12	23.3	44	20	23	32.8	36

Note: Fitting cover ordered separately.

Bulkhead union: KRE Inch

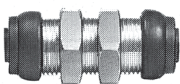

Applicable tube O.D. (Inch)	Thread UNF	Model	H (Hex.)	ØD	L	A	M	Min. hole dia.	Wt. (gf)
1/4	5/16 - 18	KRE07-00	¹¹ / ₁₆ (17.46)	0.63 (16)	1.52 (38.5)	0.60 (15.08)	0.75 (19)	0.18 (4.6)	35
3/8	1/8 - 14	KRE11-00	1 (25.4)	0.80 (20.3)	1.83 (42)	0.91 (23)	0.91 (23)	0.28 (7)	73
			¹¹ / ₈ (28.6)	0.96 (24.3)	1.91 (48.5)	1.03 (26.2)	0.94 (24)	0.38 (9.6)	
1/2	1-2	KRE13-00	¹¹ / ₈ (28.6)	0.96 (24.3)	1.91 (48.5)	1.03 (26.2)	0.94 (24)	0.38 (9.6)	100.4

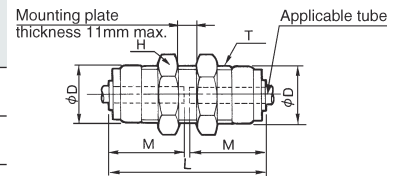

Note: Fitting cover ordered separately.

KRE Metric

Applicable tube O.D.(mm)	Part No.	T (M)	H (Hex.)	øD	L	Mounting hole	M	Effective orifice(mm ²)	Weight (g)
6	KRE06-00	M14×1	17	15.5	38.5	15	19	5.7	34.8
8	KRE08-00	M16×1	19	17	42	17	20.5	18.0	53.8
10	KRE10-00	M20×1	24	20.8	46.5	21	23	29.5	72.6
12	KRE12-00	M22×1	27	22.8	48.5	23	24	46.1	99

Note: Fitting cover ordered separately.

Series KR

Flame Resistant One-touch Fittings

Plug: KRP Inch



Applicable tube O.D. (inch)	Model	ØD	L	A	Weight (gf)
1/4	KRP-07	0.33(8.5)	1.38(35)	0.63(16)	1
3/8	KRP-11	0.45(11.5)	1.69(43)	0.79(20)	2
1/2	KRP-13	0.59(15)	1.81(46)	0.87(22)	4

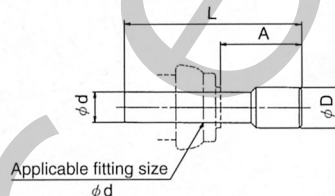

KRP Metric

Applicable fitting size ød	Part No.	øD	L	A	Weight (g)
6	KRP-06	8	35	16	1
8	KRP-08	10	39	18,5	1.7
10	KRP-10	12	43	20	3.4
12	KRP-12	14	46	22	4.7

Spatter Cover: KR Inch (TIRS Tubing)



Applicable Fitting O.D.	Model	
1/4"	KR-07C	Consult factory for information
3/8"	KR-11C	
1/2"	KR-13C	

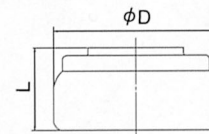

KR Metric (TRS Tubing)

Applicable fitting size	Part No.	øD	L	Weight (g)
6	KR-06C	15.5	9	0.9
8	KR-08C	17	9	1.0
10	KR-10C	20.8	10.5	1.5
12	KR-12C	22.8	10.5	1.6

Spatter Cover: KR Metric (TRB Tubing)



Applicable Fitting O.D.	Model	ØD	L1	L2
6	KR-06C1	18	13.7	12.8
8	KR-08C1	20	15.7	15
10	KR-10C1	22	17.2	18
12	KR-12C1	22	17.2	20

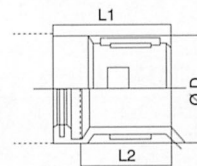

Straight union: KRH Metric



Applicable tube O.D.(mm)	Part No.	øD	L	M	Effective orifice(mm ²)	Weight (g)
6	KRH06-00	16.8	38.5	19	5.7	6.6
8	KRH08-00	19.2	42.5	20.5	18.0	8.8
10	KRH10-00	23.3	46.5	23	29.5	13.6
12	KRH12-00	25.7	48.5	24	46.1	17

Note: Fitting (spatter) cover ordered separately.

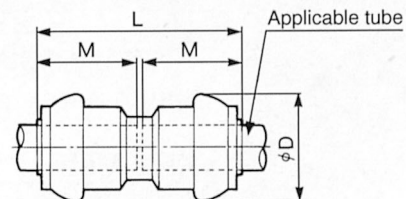

Flame Resistant One-touch Fittings

Series KR

45° male elbow: KRK Metric



Applicable tube OD (mm)	Thread R(PT)	Part No.	H (Hex.)	øD1	øD2	L1	L2	A*	M	Effective orifice (mm ²)	Weight (g)
6	1/8	KRK06-01S	10	16.8	10	20	20.5	34.5	19	3.9	12.8
	1/4	KRK06-02S	14				24.5	36.5			20.8
	3/8	KRK06-03S	17				26.5	38			33.8
8	1/8	KRK08-01S	12	19.2	12	22.5	22	38.5	20.5	19.7	13.9
	1/4	KRK08-02S	14				26	40.5			21.9
	3/8	KRK08-03S	17				28	41			35.9
10	1/8	KRK10-01S	17	23.3	17	24	24	44	23	23.2	26.3
	1/4	KRK10-02S					27	45			27.3
	3/8	KRK10-03S	26			29	46.5	37.3			
	1/2	KRK10-04S				33	49	64.3			
12	1/4	KRK12-02S	17	25.7	17	27	27.5	47	24	35.1	29.5
	3/8	KRK12-03S					29.5	48.5			39.5
	1/2	KRK12-04S					33.5	51			66.5

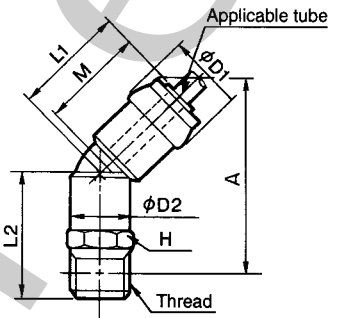

* Reference dimensions after R(PT) thread installation.
 Note: Fitting (spatter) cover ordered separately.

Extended male elbow: KRW Metric



Applicable tube OD (mm)	Thread R(PT)	Part No.	H (Hex.)	øD1	øD2	L1	L2	A*	M	Effective orifice (mm ²)	Weight (g)
6	1/8	KRW06-01S	10	16.8	10	22	40	44.5	19	5.0	26.8
	1/4	KRW06-02S	14				46	48.5			41.8
	3/8	KRW06-03S	17				48	50			67.8
8	1/8	KRW08-01S	12	19.2	12	25	43.5	49	20.5	14.2	30.9
	1/4	KRW08-02S	14				49.5	53			47.9
	3/8	KRW08-03S	17				51.5	52.5			74.9
10	1/4	KRW10-02S	17	23.3	17	28.5	56.5	61.9	23	23.8	67.3
	3/8	KRW10-03S					58.5	63.4			77.3
	1/2	KRW10-04S	22			65	68.4	146.3			
12	1/4	KRW12-02S	17	25.7	17	30.5	57.5	64.4	24	37.7	69.5
	3/8	KRW12-03S					59.5	65.9			79.5
	1/2	KRW12-04S					22	66			70.9

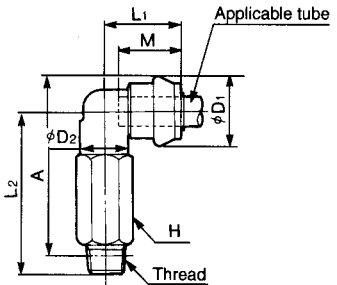

* Reference dimensions after R(PT) thread installation.
 Note: Fitting (spatter) cover ordered separately.

Series KRM

Flame Resistant One-touch Fittings Manifold

Compact piping possible.
Manifold piping possible.
Many varieties (8 types) available.
One-touch mounting.

Type

Model	Porting		Number of Port A	Port A size	Port B size
	Port A	Port B			
KRM11	One-touch fitting	One-touch fitting	6, 10	ø6 tube ø8 tube	ø10 tube ø12 tube
KRM12	One-touch fitting	Rc(PT) female thread	6, 10	ø6 tube ø8 tube	Rc(PT) 1/4 Rc(PT) 3/8

Applicable Tube

Tube material	FR soft nylon
Tube O.D.	ø6, ø8, ø10, ø12

Specifications

Model	KRM11	KRM12
Operating fluid	Air, Water <small>Note1)</small>	
Max. operating pressure	145psi {1.0MPa}	
Proof pressure	435psi {3.0Mpa}	
Ambient and fluid temperature	32 to 140°F {0 to 60°C}, Water: 40 to 105°F {5 to 40°C}	
Thread	—	JIS B0203 (Taper pipe thread)
Accessories	Nil	Hexagon socket head blanking plug with sealant: 1pc.

Note1) Applicable for general industry water. Consult SMC if using for other kind of fluid.
Surge pressure must be under the max. operating pressure.

Principal Element Material

Body	Flame resistance PBT (UL standard V-0)
Stud	— C3604BD
Chuck	Stainless steel (SUS304)
Guide	C3604BD
Collet	Polycetal (POM)
Packing	NBR
Release button	Flame resistance PBT (UL standard V-0)
Cover	Flame resistance CR (UL standard V-0)

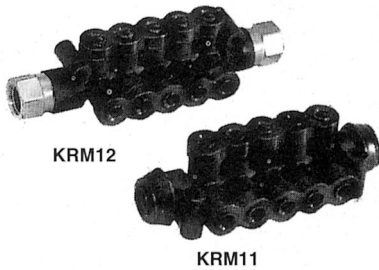

Construction

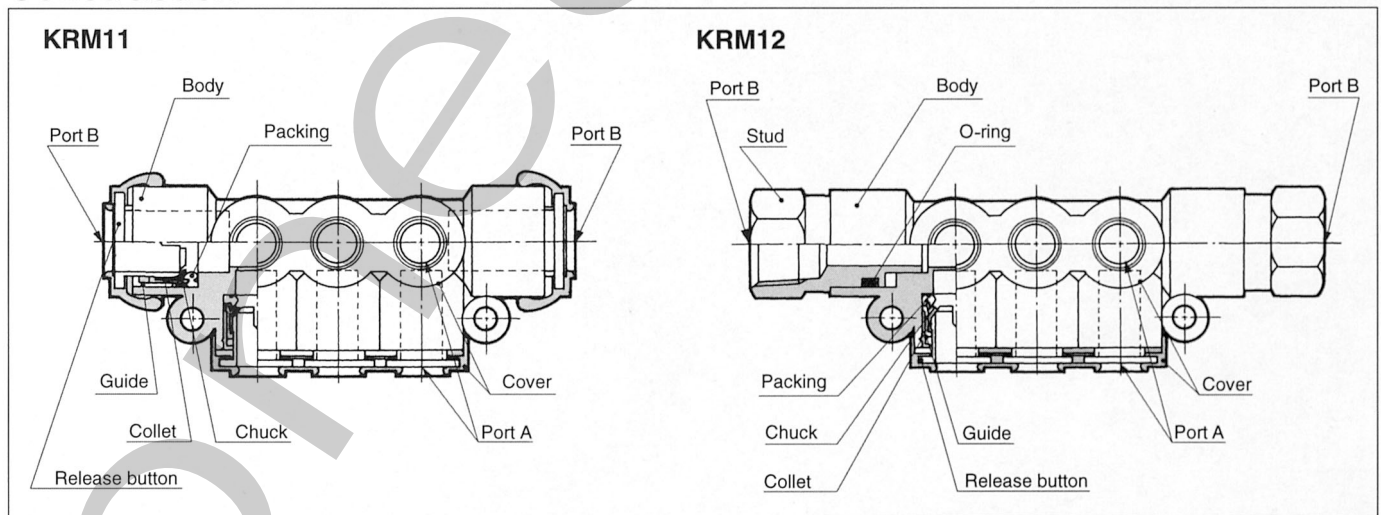

Flame Resistant One-touch Fittings Manifold

Dimensions

KRM11

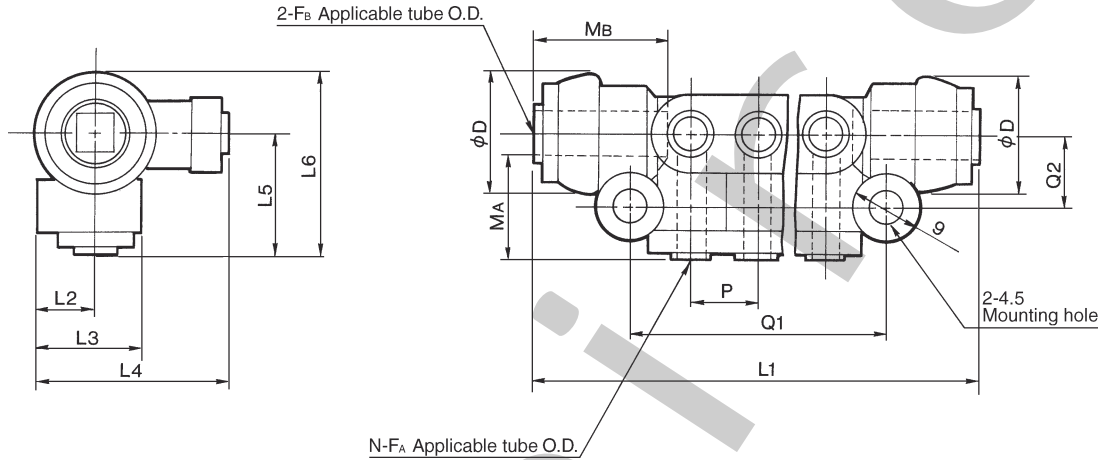

Applicable tube O.D. (mm)		Part No.	N	L1	L2	L3	L4	L5	L6	øD	P	Q1	Q2	MA	MB	Port B min. port size	Weight (g)
FA	FB																
6	10	KRM11-06-10-6	6	80	10	19.5	33.5	23.5	33	23.3	13	47	13.5	19	22	8.5	40
		KRM11-06-10-10	10	106								73					
8	12	KRM11-08-12-6	6	89	11.5	22.5	37.5	26	36.5	25.7	15.5	55	14.7	20.5	24	10	53
		KRM11-08-12-10	10	120								86					

KRM12

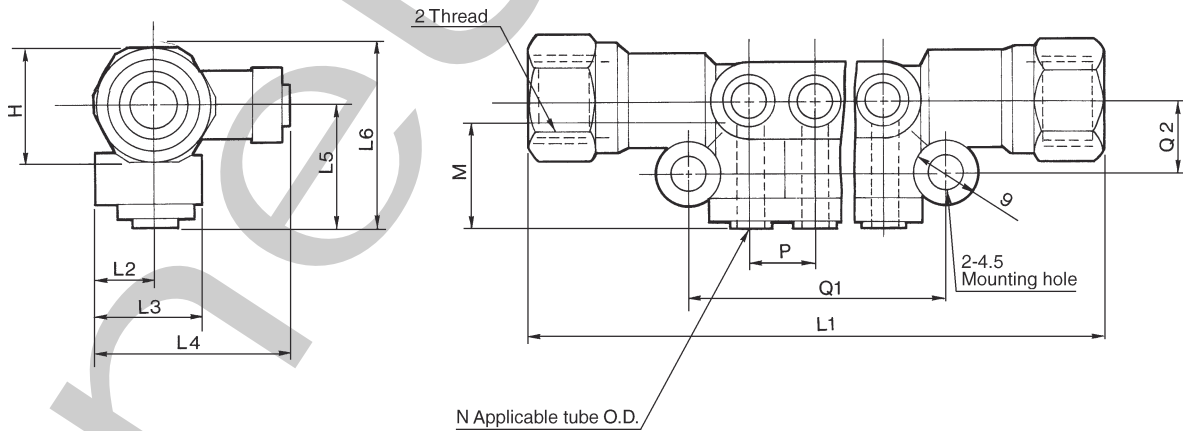

Applicable tube O.D.(mm)	Thread Rc(PT)	Part No.	N	H (Hex.)	L1	L2	L3	L4	L5	L6	P	Q1	Q2	M	Port B min. port size	Weight (g)
6	1/4															
		KRM12-06-02-10	10		125							73				
8	3/8	KRM12-08-03-6	6	19	108	11.5	22.5	37.5	26	36.5	15.5	55	14.7	20.5	10	106
		KRM12-08-03-10	10		139							86				